

# cloud softlight large mobile (110 - 120V) · installation guide

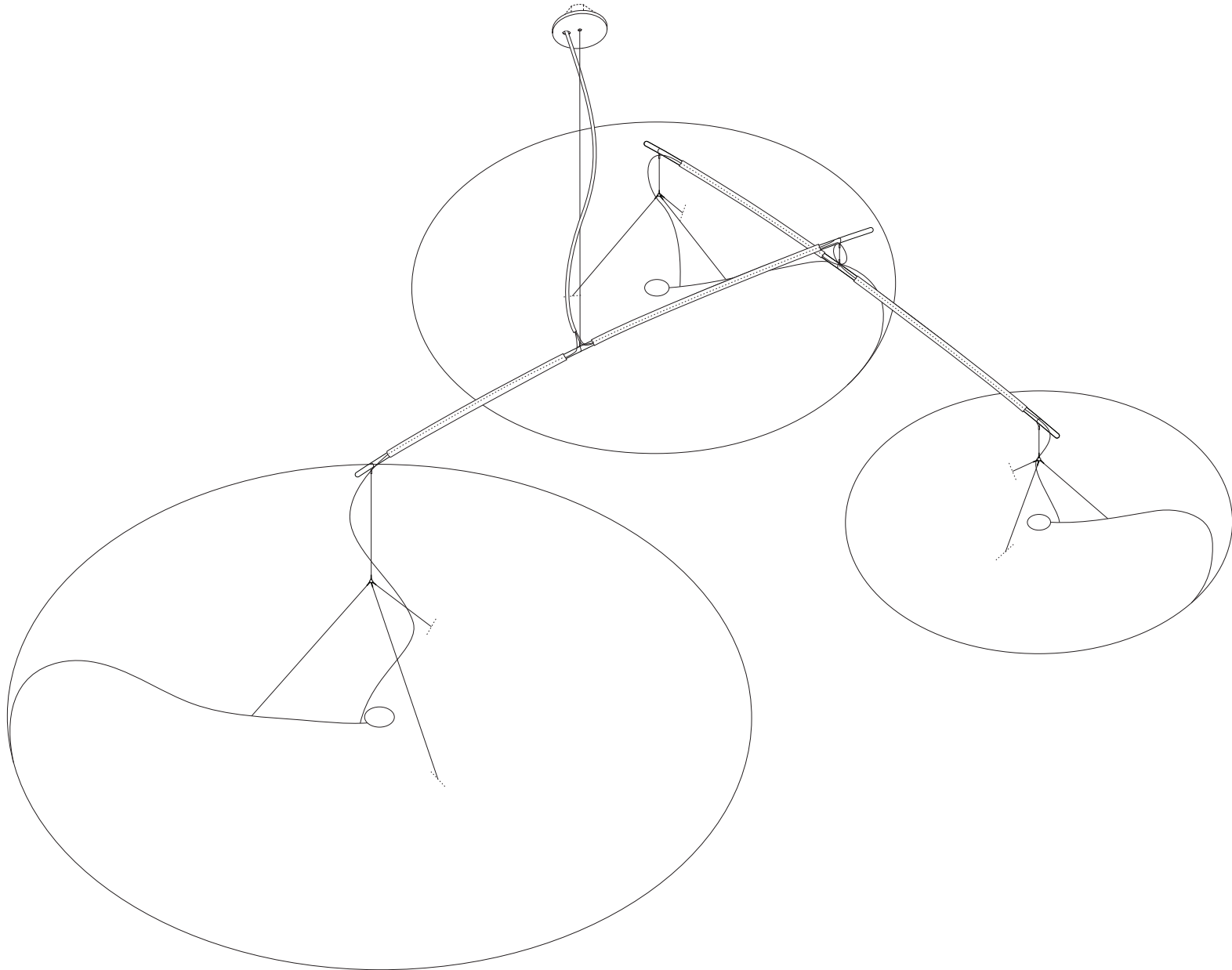

# moloo

# large cloud mobile anatomy

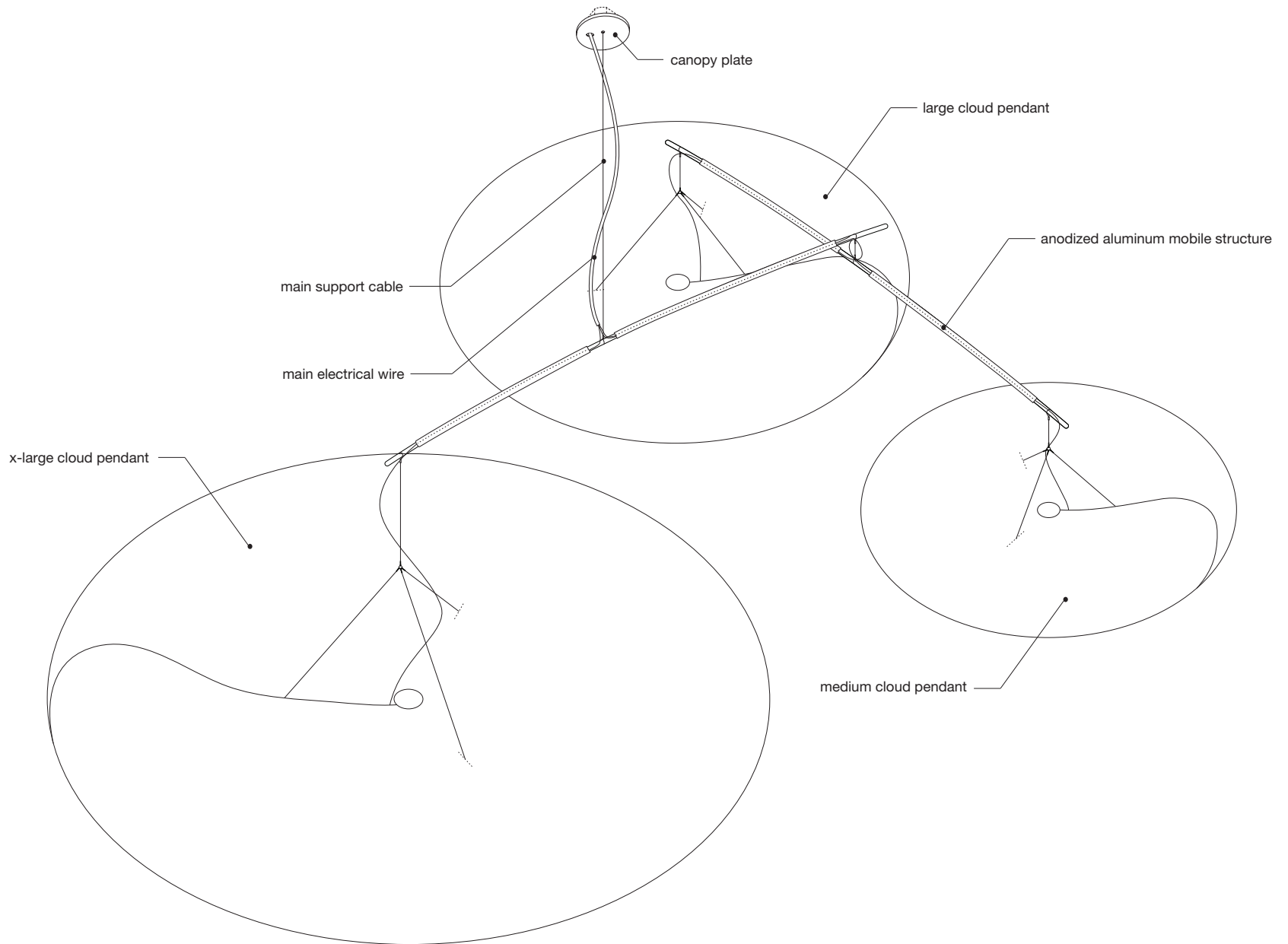

# large cloud mobile parts

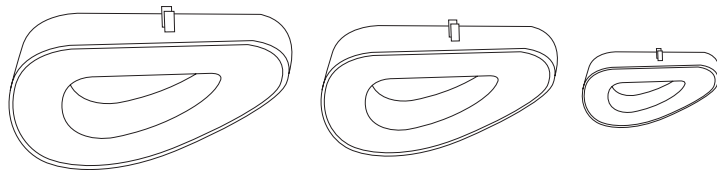
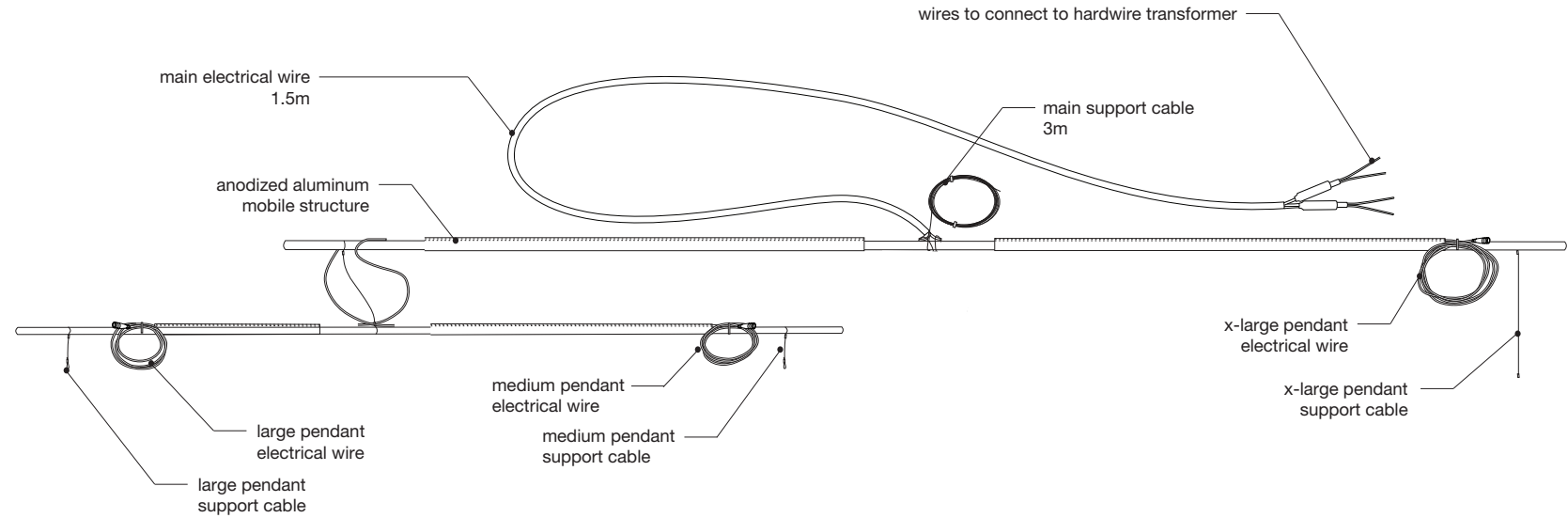

cloud shade  
md, lg, x-lg  
(compressed for shipping)



x2 CL3 wire



bracket bar with  
cable gripper and  
magnets

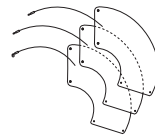
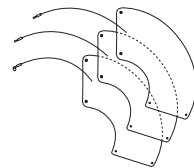
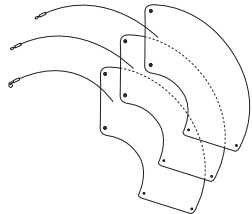

shade armature  
md, lg, x-lg  
(with chicago bolts)



x14 marrettes



x5 clamps

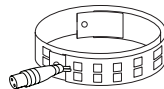
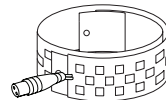
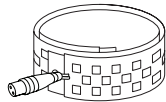

LED ribbon  
md, lg, x-lg  
(warm white or  
daylight white)



nylon zap strap



alternate "ring type"  
cable gripper (flexible  
option of hanging  
cloud pendants from  
ceiling hooks)

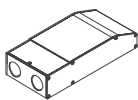
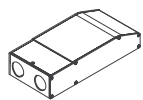

x2 dimmable  
hardwire LED driver



125mm (5")  
canopy plate



split ring pliers

# anatomy of cloud pendant within mobile

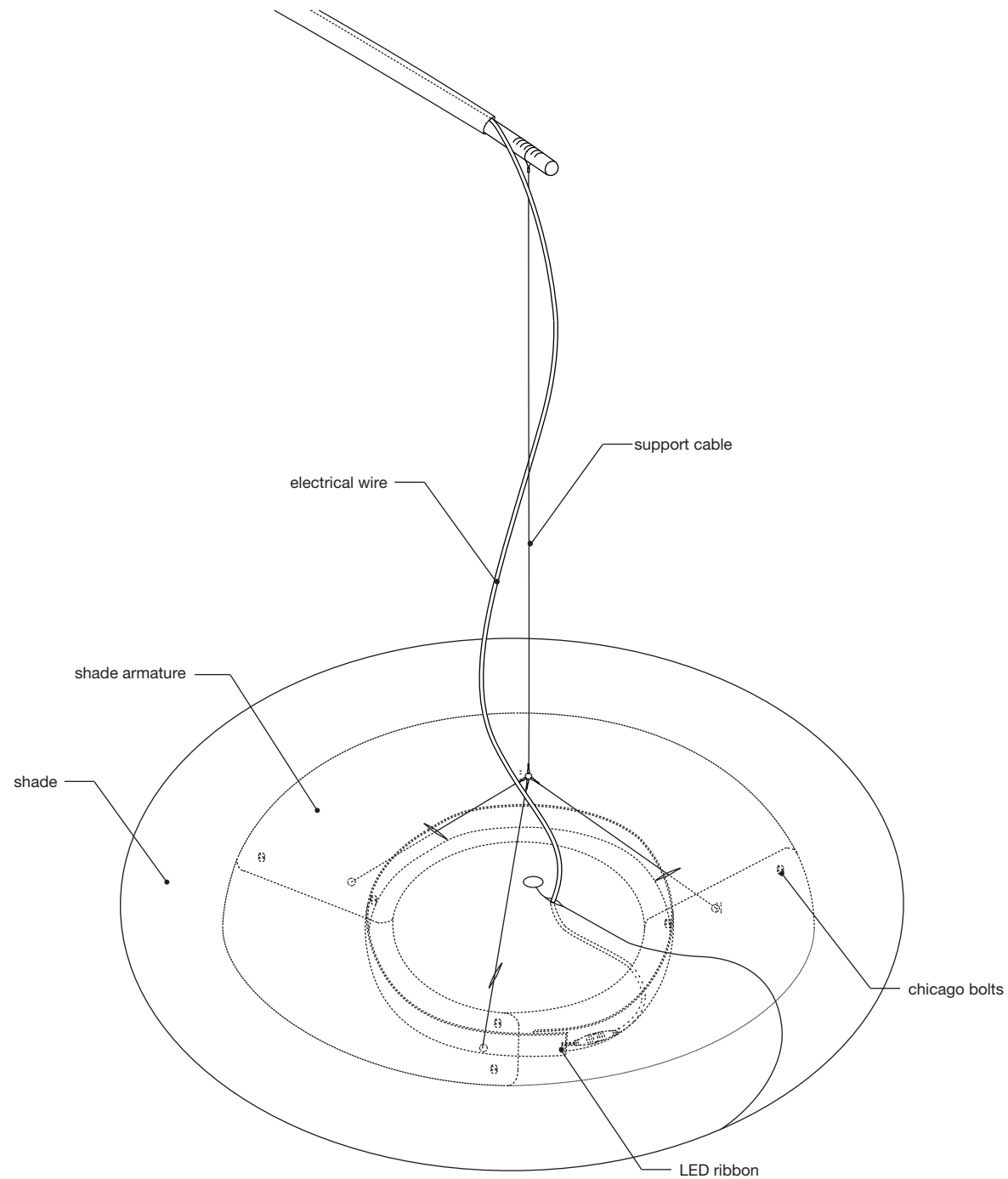

# cloud pendant assembly

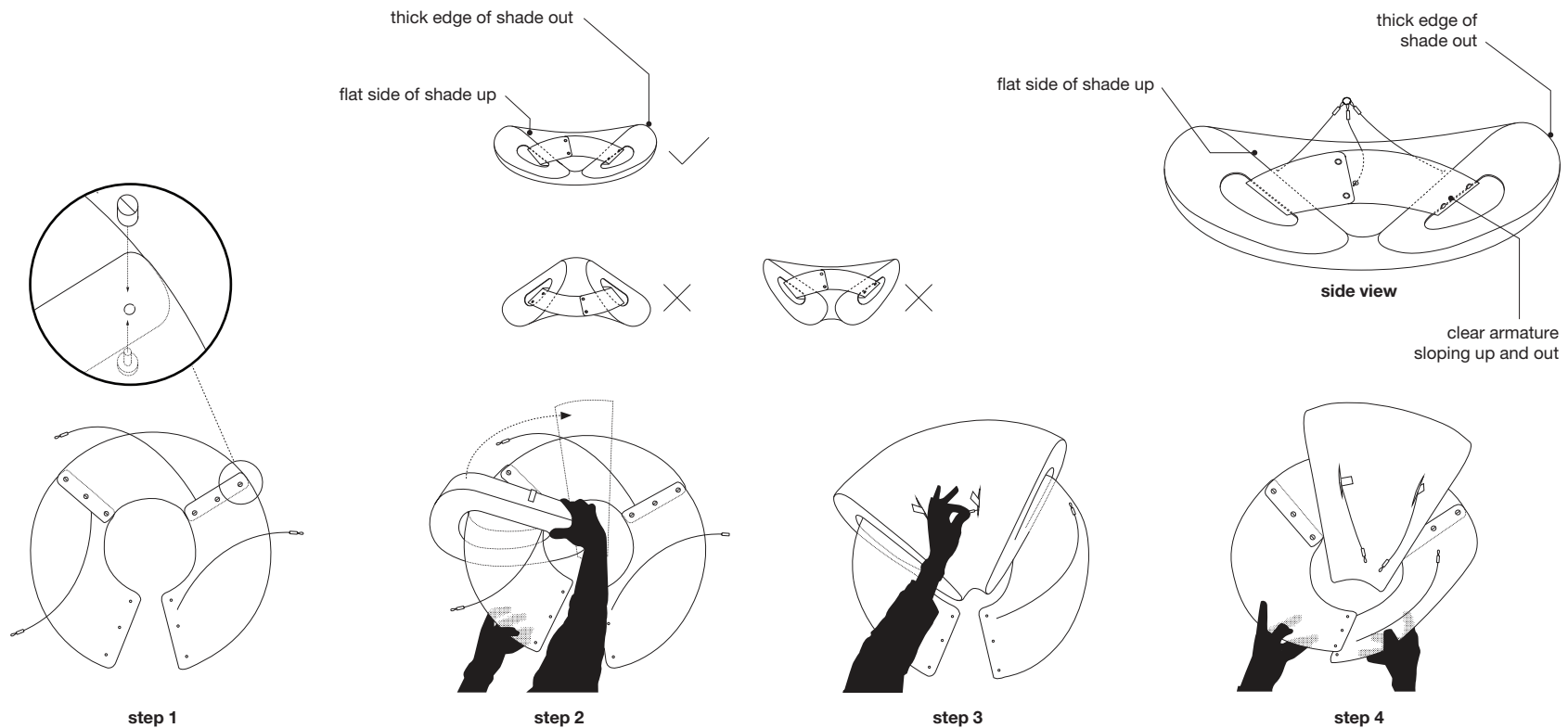

**step 1:** To assemble the cloud armature, peel off protective paper and lay all three clear plastic pieces on a flat surface. Check that the crimped loop-end of each steel support cable is on the top side. Hand-turn the chicago bolts to unscrew, and then line up holes of armature as shown above. Ensure that the side with attached support cable is underneath the piece to be connected. Screw pieces together to create a "C" shaped collar. Do not close the collar.

**step 2:** Feed armature through shade cavity. Flat side of shade should face up with thick edge of shade at outer perimeter.

**IMPORTANT:** If this step is not done correctly you will end up with a "droopy" looking cloud. Be sure the clear plastic armature forms a truncated cone shape with the larger diameter facing up and the center of the cone pointing down as shown in the drawing above on right side of page. Also note the orientation of cloud shade shape shown above, with flat side on top and smaller pointed end toward the center.

**step 3:** Feed two support cables through the larger cells of the shade. The larger cells are marked with coloured tags.

**step 4:** Line up the holes of the last set of connection points in plastic armature. Start with the holes closest to the center, screw together. By lifting the outside perimeter of armature you will create a truncated cone that slopes down to the center. Screw in the last chicago bolts.

# cloud pendant assembly

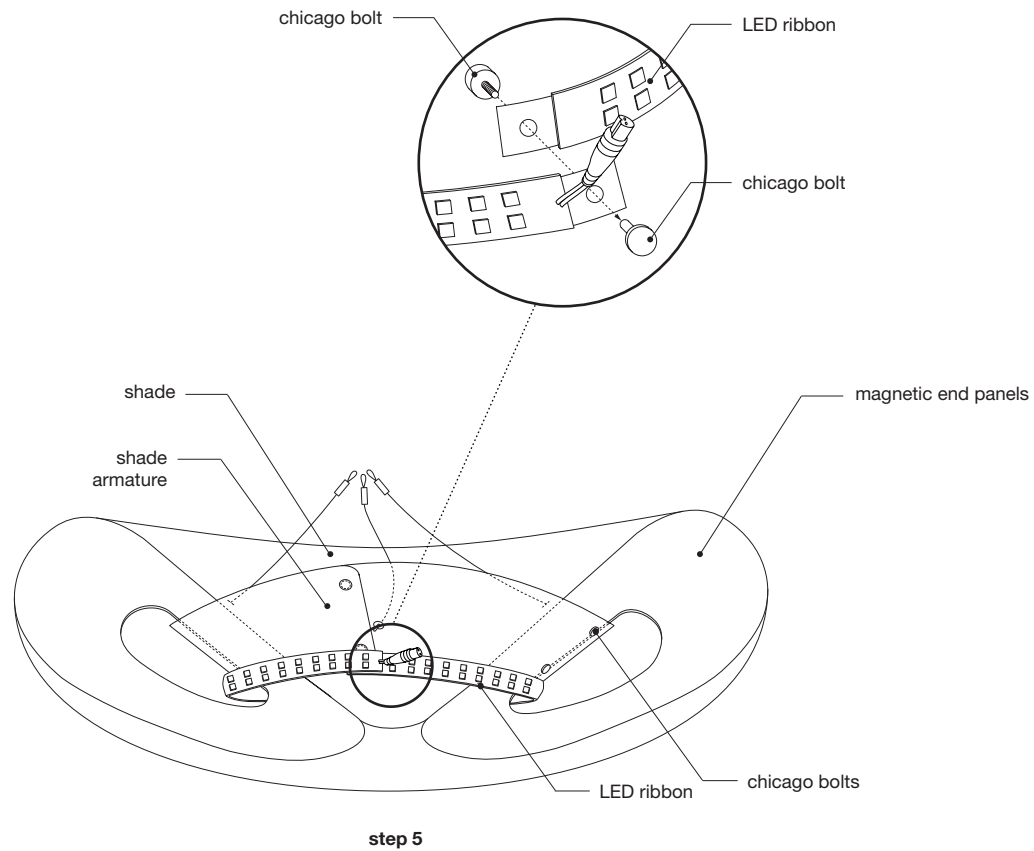

**step 5:** Feed LED ribbon through textile shade cavity, making sure LED is under clear plastic armature. Connect the ends of the LED strip together to form a ring, ensuring the LED chips face outwards, then fasten with aluminum chicago bolt provided.

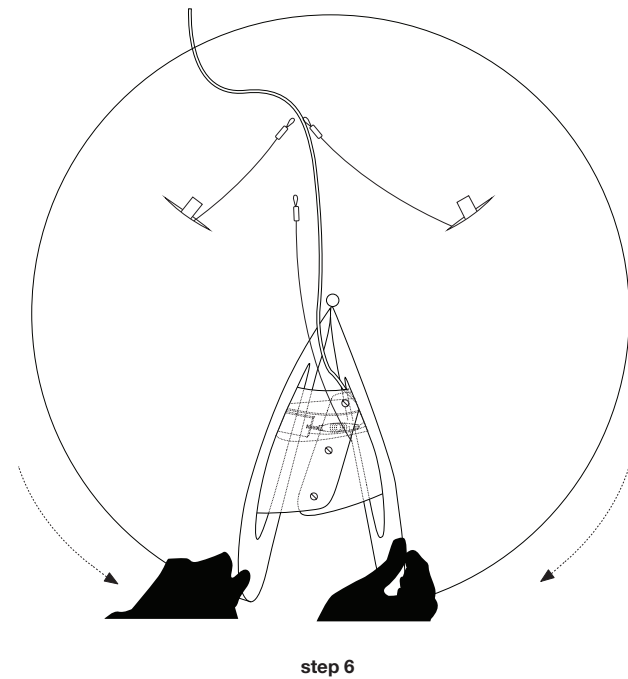

**step 6:** Envelop the armature by holding inside the shade cavity and pulling the magnetic end panels around to connect to each other. The magnets hold the end panels together. The third steel support cable and electrical wire sandwich between the two magnetic end panels.

# large cloud mobile assembly

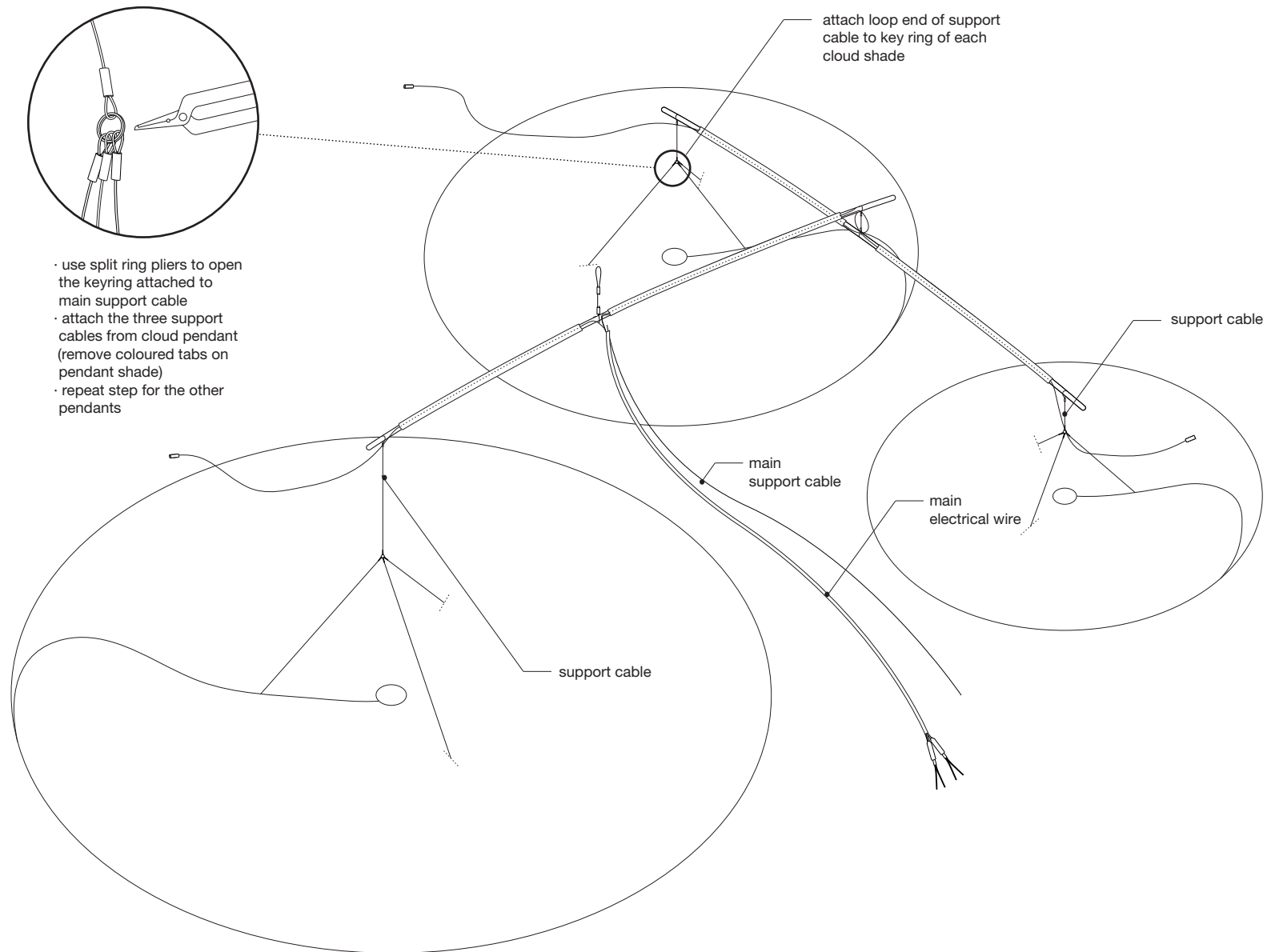

# large cloud mobile assembly

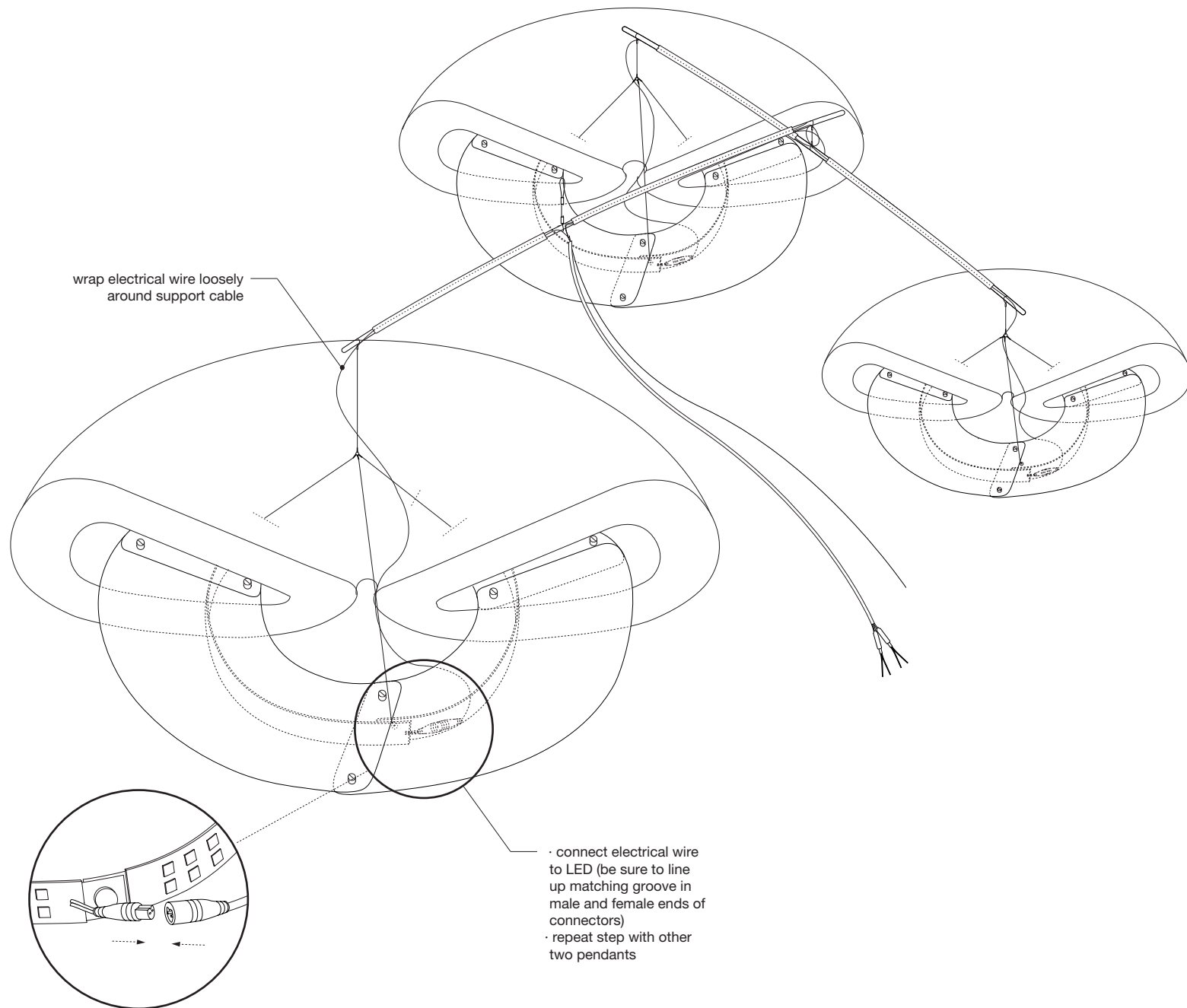

# large cloud mobile installation

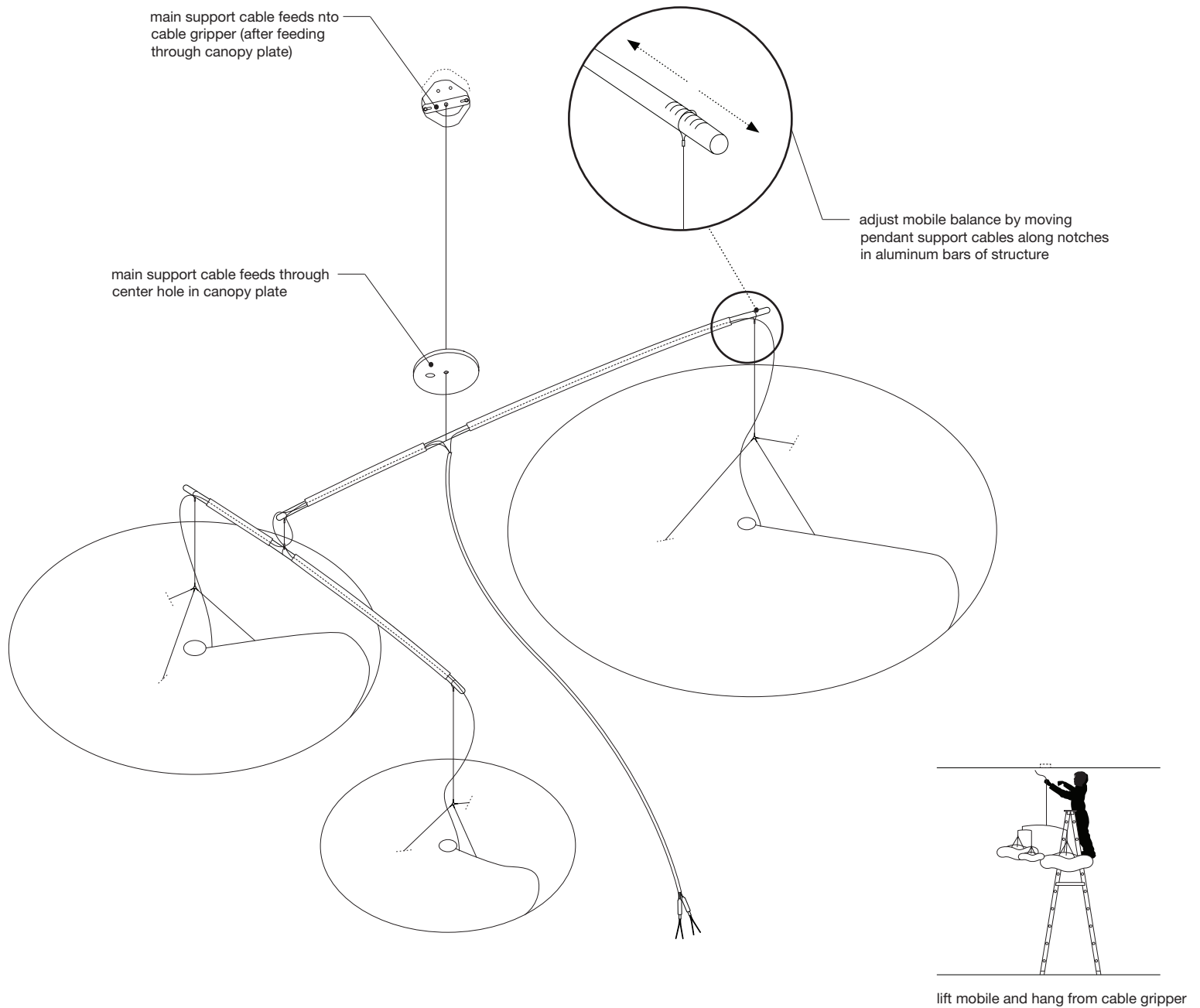

# large cloud mobile installation

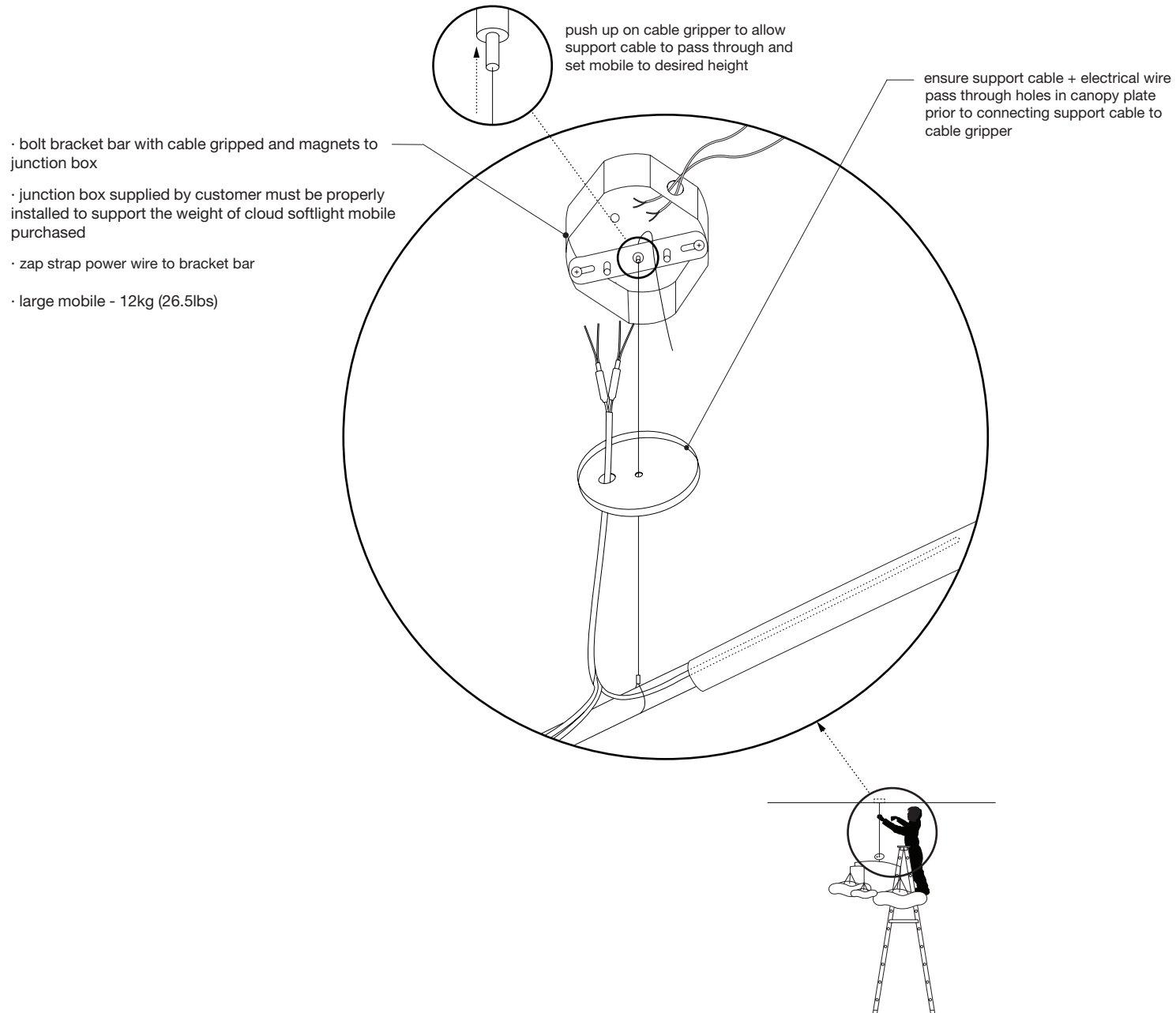

# large cloud mobile installation

