

cloud softlight small mobile (110 - 120V) · installation guide

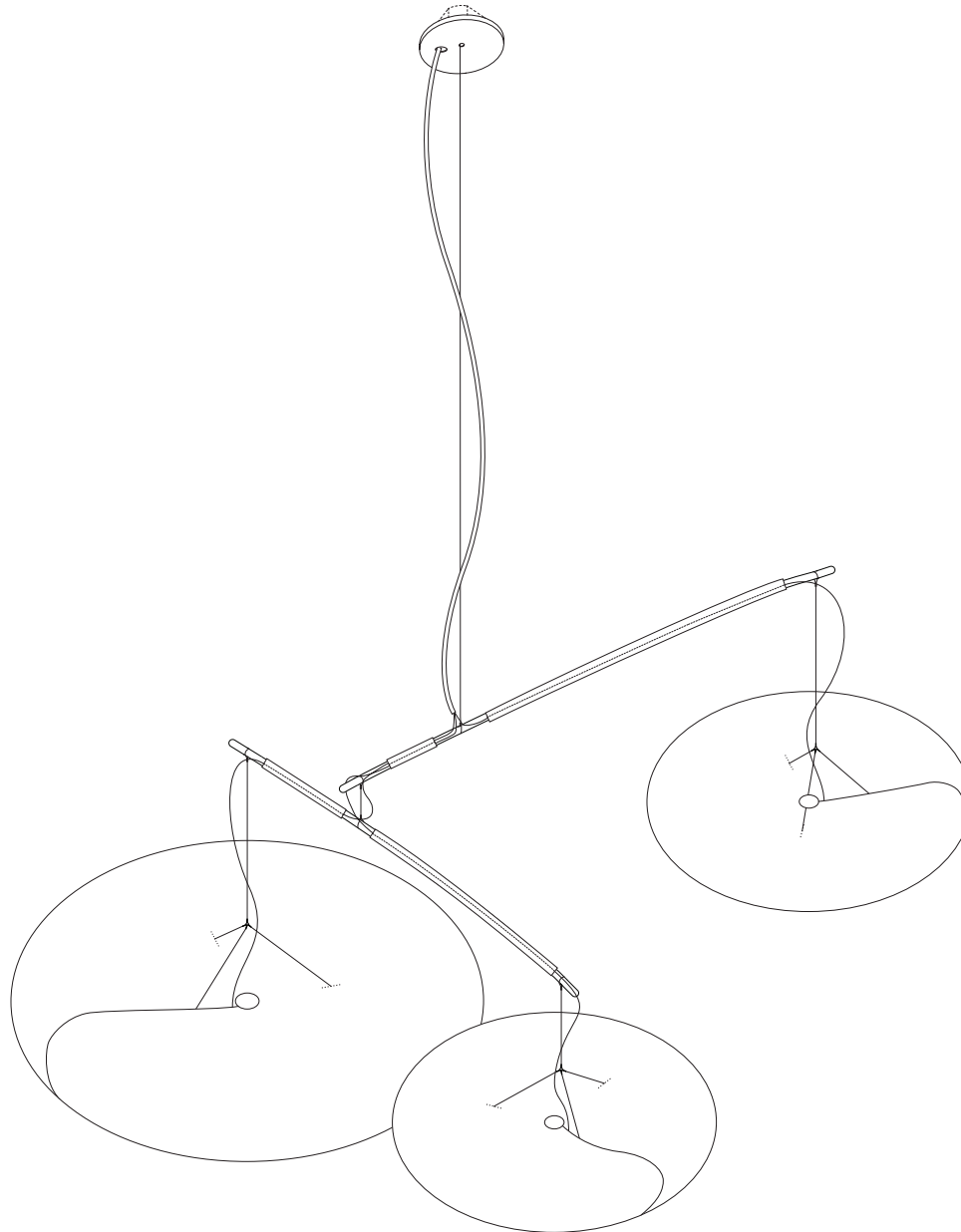

moloo

small cloud mobile anatomy

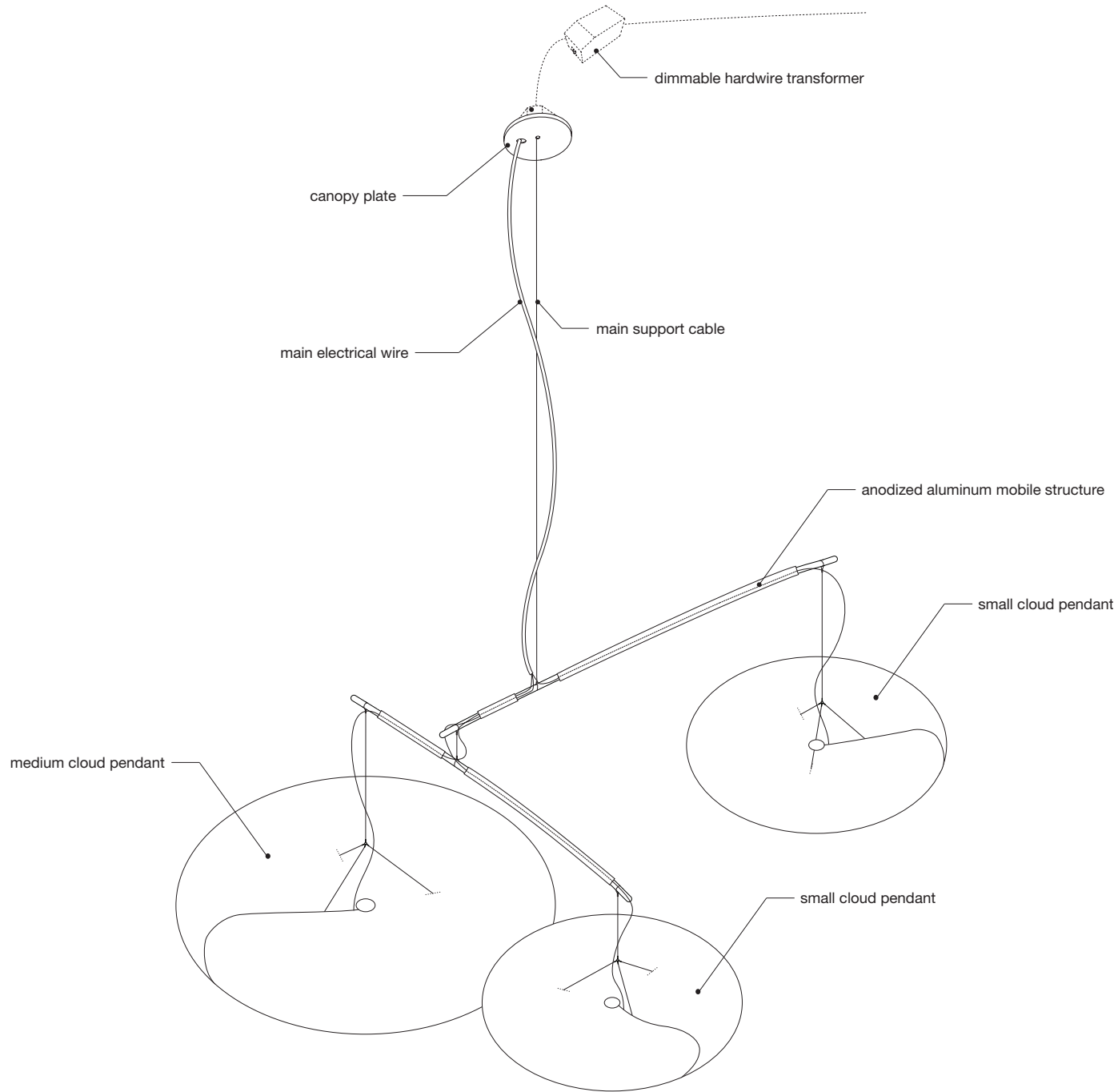

small cloud mobile parts

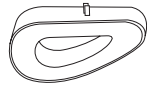
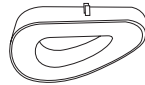
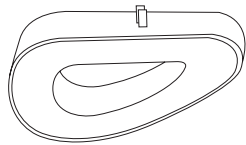
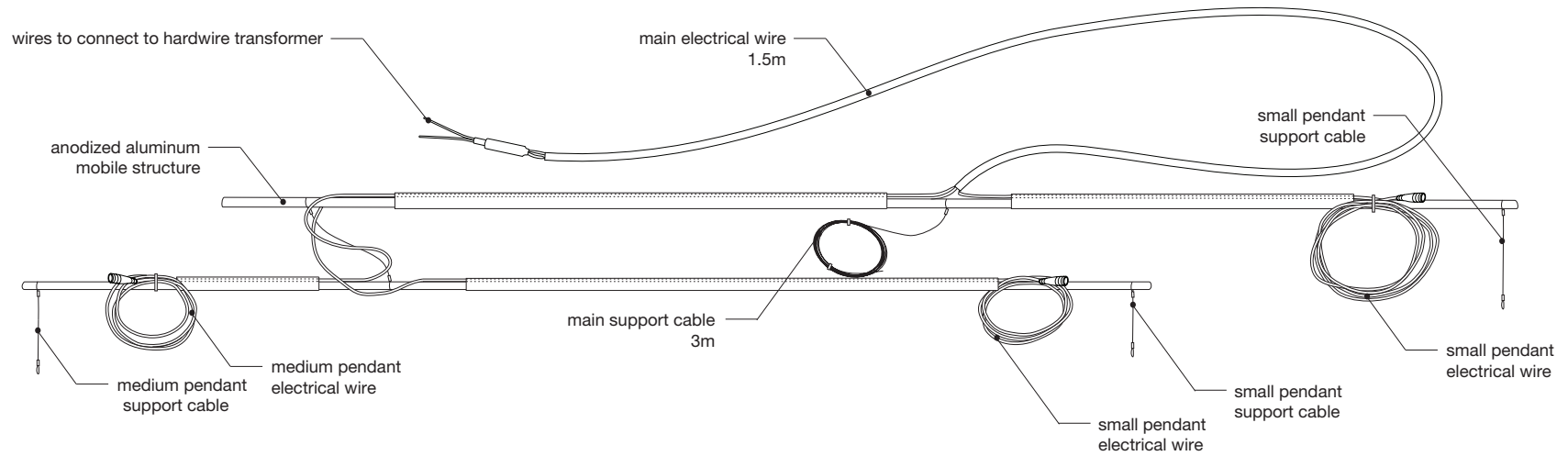

cloud shade
2x sm, md
(compressed for shipping)



CL3 wire



bracket bar with
cable gripper and
magnets

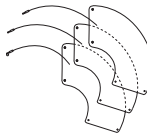
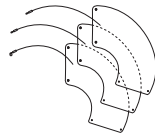
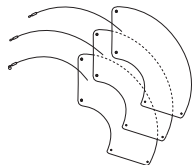

shade armature
2x sm, md
(with chicago bolts)



x7 marrettes



x3 clamps

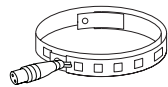
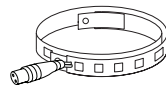
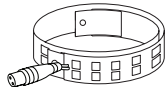

LED ribbon
2x sm, md (warm white
or daylight white)



nylon zap strap



alternate "ring type"
cable gripper (flexible
option of hanging
cloud pendants from
wall hooks)

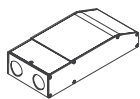

dimmable
hardwire LED driver

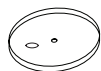

125mm (5")
canopy plate



split ring pliers

anatomy of cloud pendant within mobile

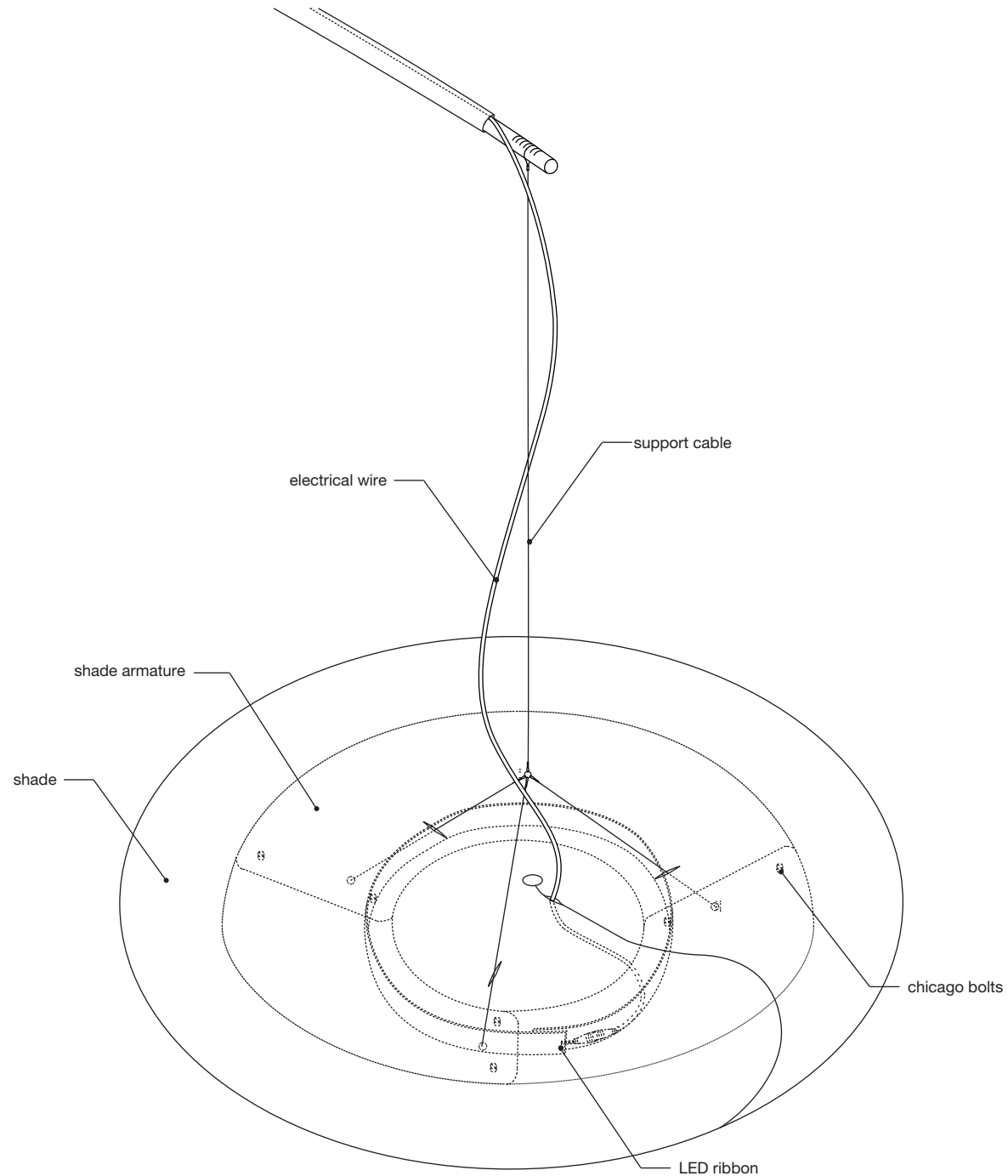

cloud pendant assembly

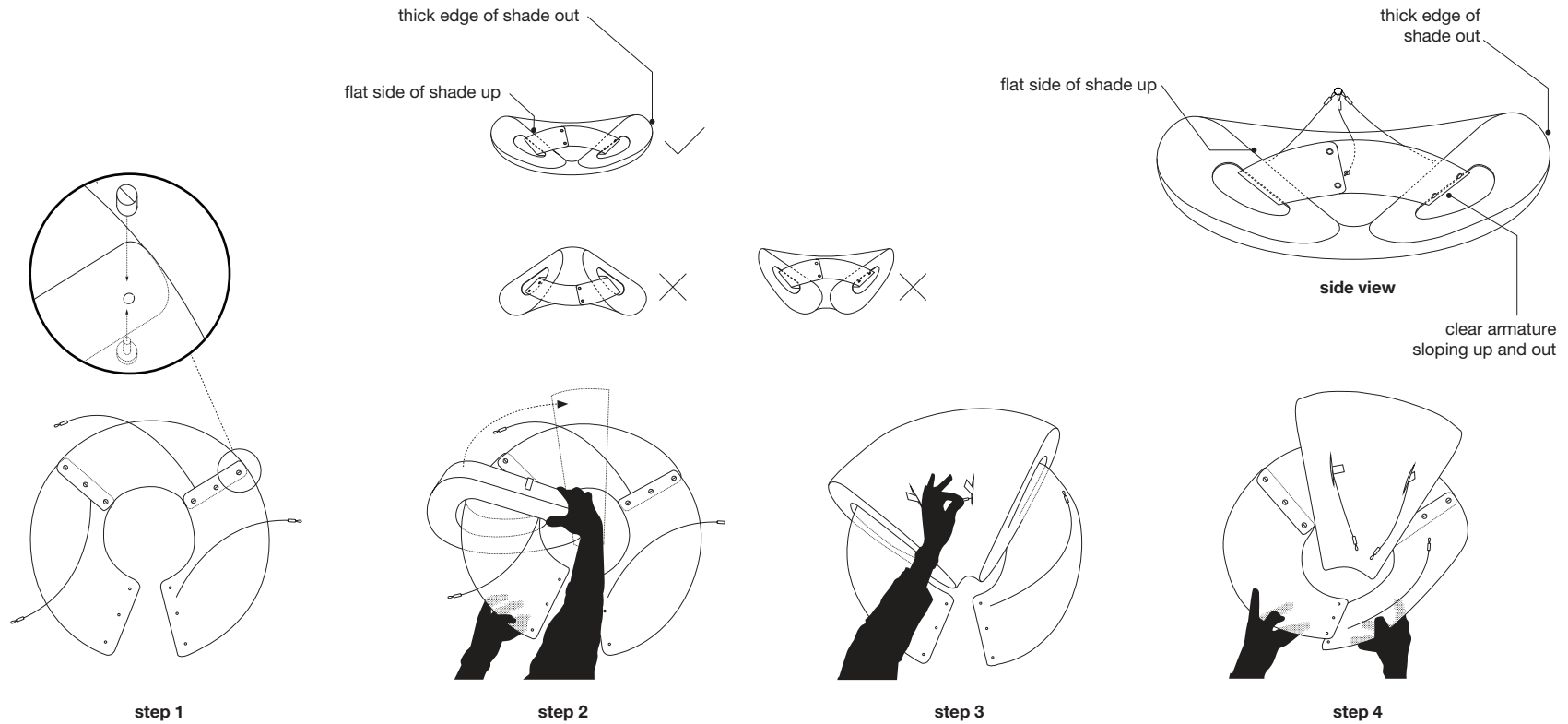

step 1: To assemble the cloud armature, peel off protective paper and lay all three clear plastic pieces on a flat surface. Check that the crimped loop-end of each steel support cable is on the top side. Hand-turn the chicago bolts to unscrew, and then line up holes of armature as shown above. Ensure that the side with attached support cable is underneath the piece to be connected. Screw pieces together to create a “C” shaped collar. Do not close the collar.

step 2: Feed armature through shade cavity. Flat side of shade should face up with thick edge of shade at outer perimeter.

IMPORTANT: If this step is not done correctly you will end up with a “droopy” looking cloud. Be sure the clear plastic armature forms a truncated cone shape with the larger diameter facing up and the center of the cone pointing down as shown in the drawing above on right side of page. Also note the orientation of cloud shade shape shown above, with flat side on top and smaller pointed end toward the center.

step 3: Feed two support cables through the larger cells of the shade. The larger cells are marked with coloured tags.

step 4: Line up the holes of the last set of connection points in plastic armature. Start with the holes closest to the center, screw together. By lifting the outside perimeter of armature you will create a truncated cone that slopes down to the center. Screw in the last chicago bolts.

cloud pendant assembly

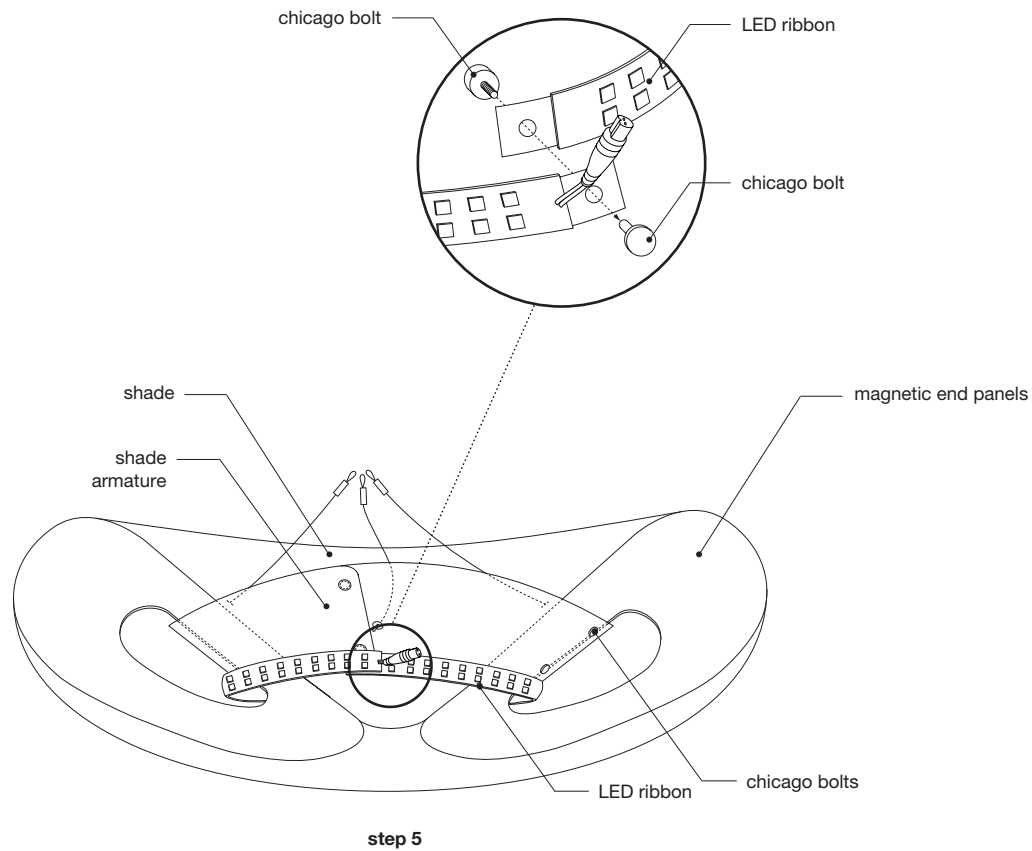

step 5: Feed LED ribbon through textile shade cavity, making sure LED is under clear plastic armature. Connect the ends of the LED strip together to form a ring, ensuring the LED chips face outwards, then fasten with aluminum chicago bolt provided.

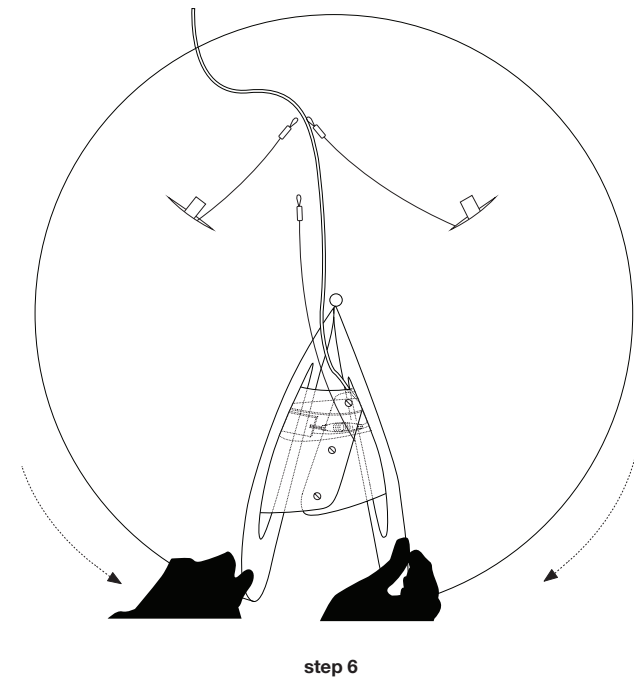

step 6: Close the shade around the armature by holding inside the shade cavity and pulling the magnetic end panels around to connect one another. The magnets hold the end panels together. The third steel support cable and electrical wire are sandwiched between the two magnetic end panels.

small cloud mobile assembly

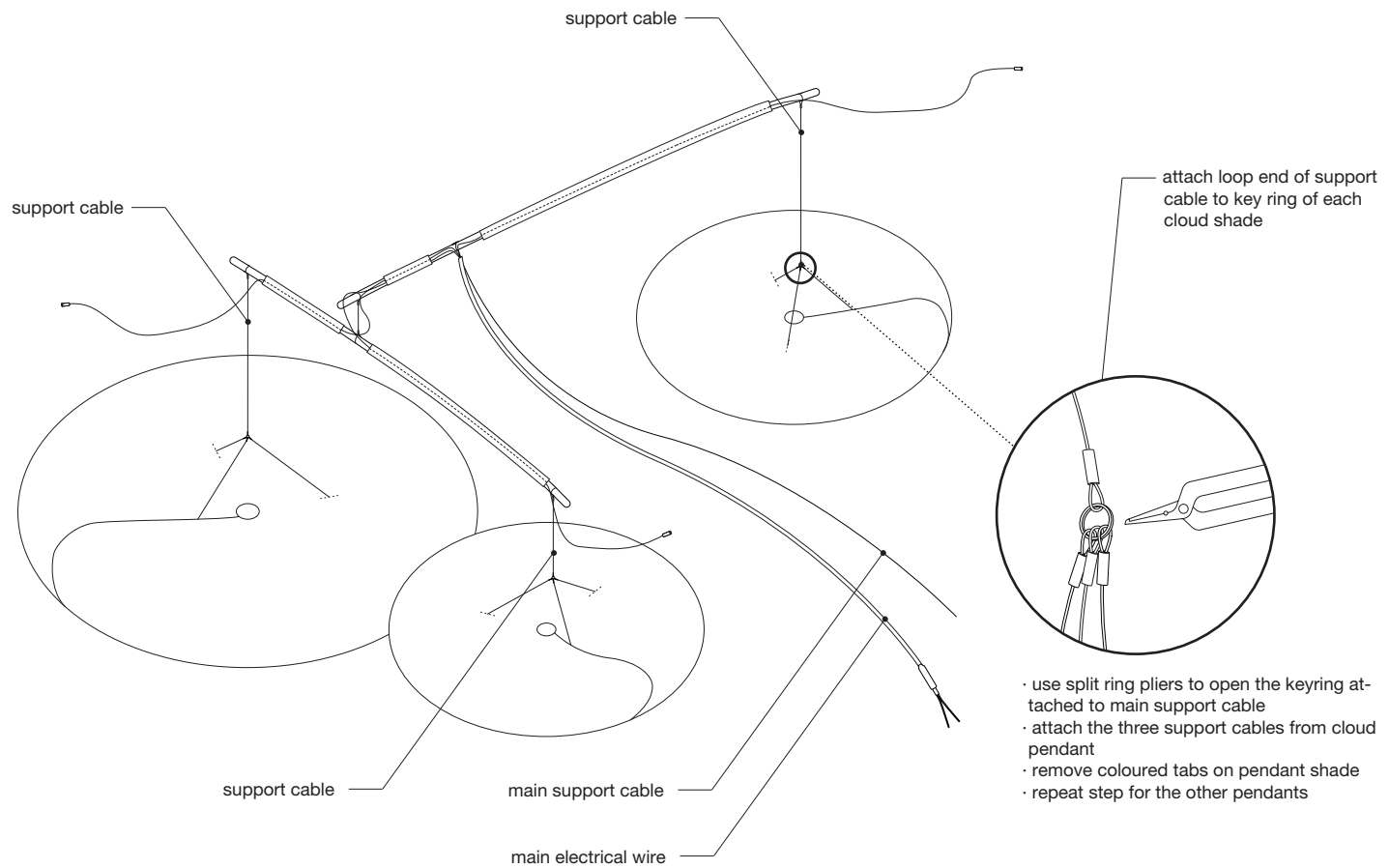

small cloud mobile assembly

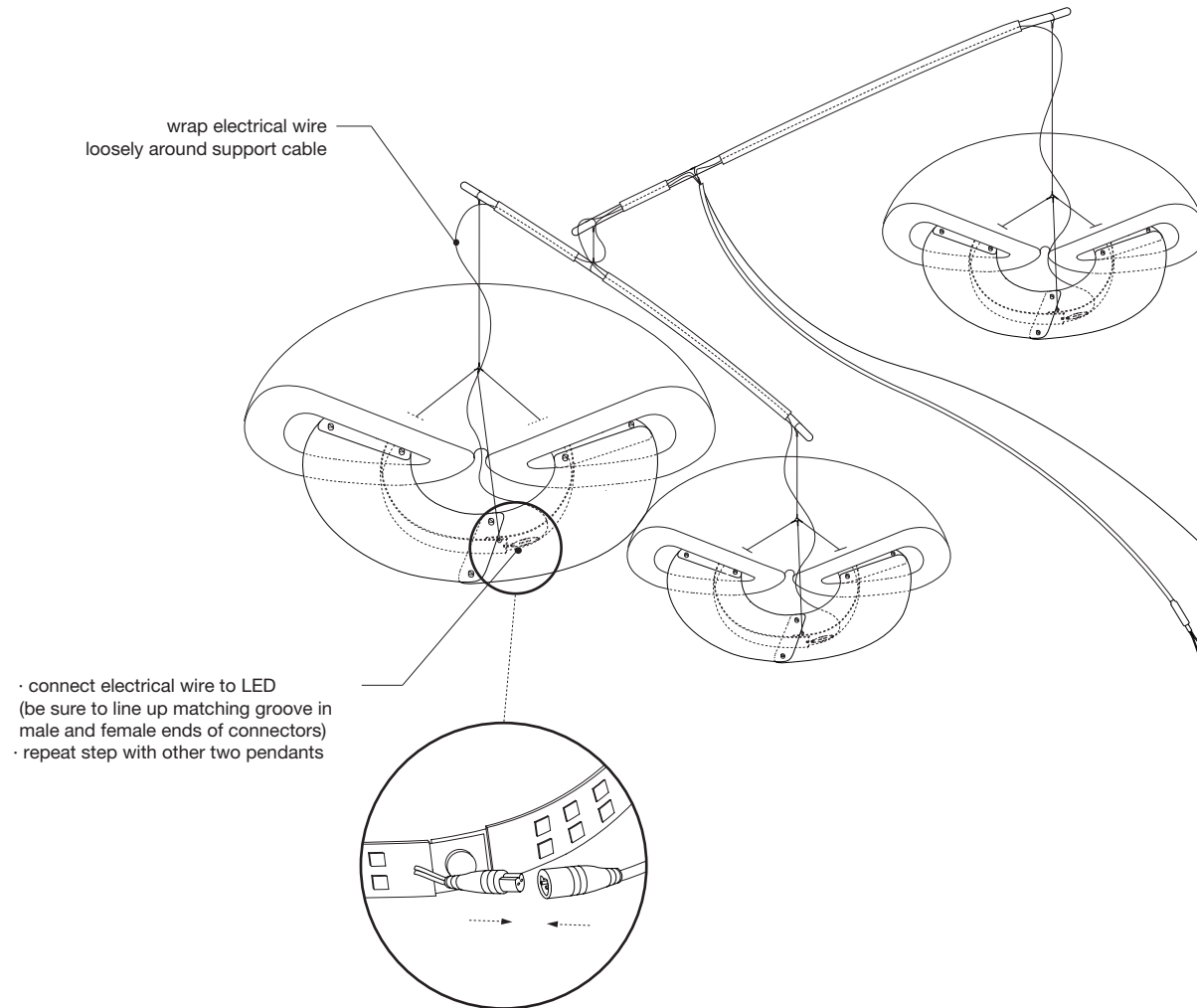

small cloud mobile installation

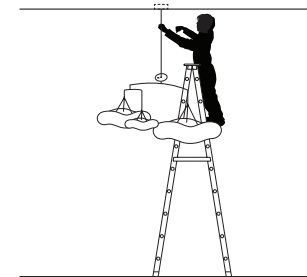
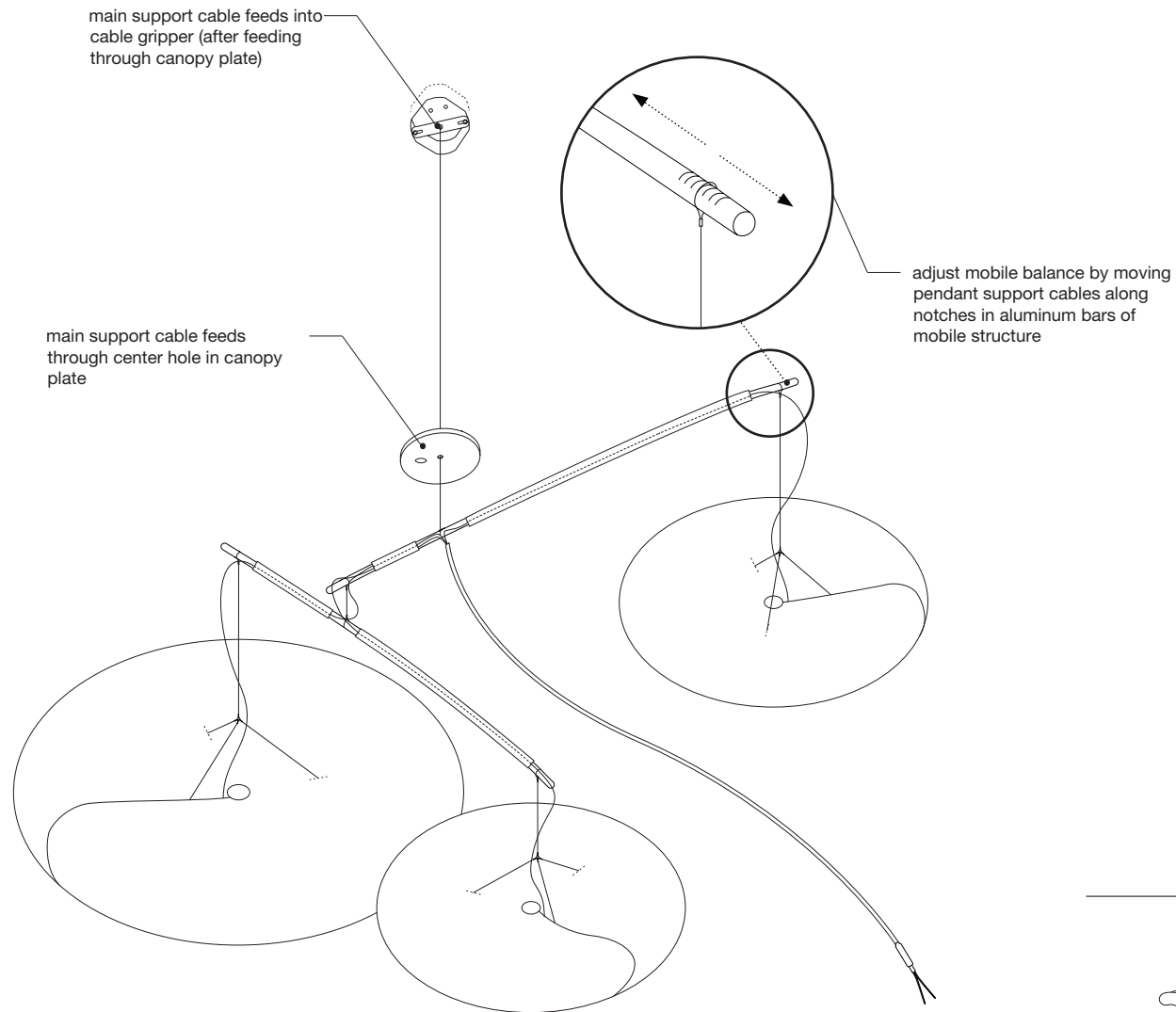

lift mobile and hang from cable gripper

small cloud mobile installation

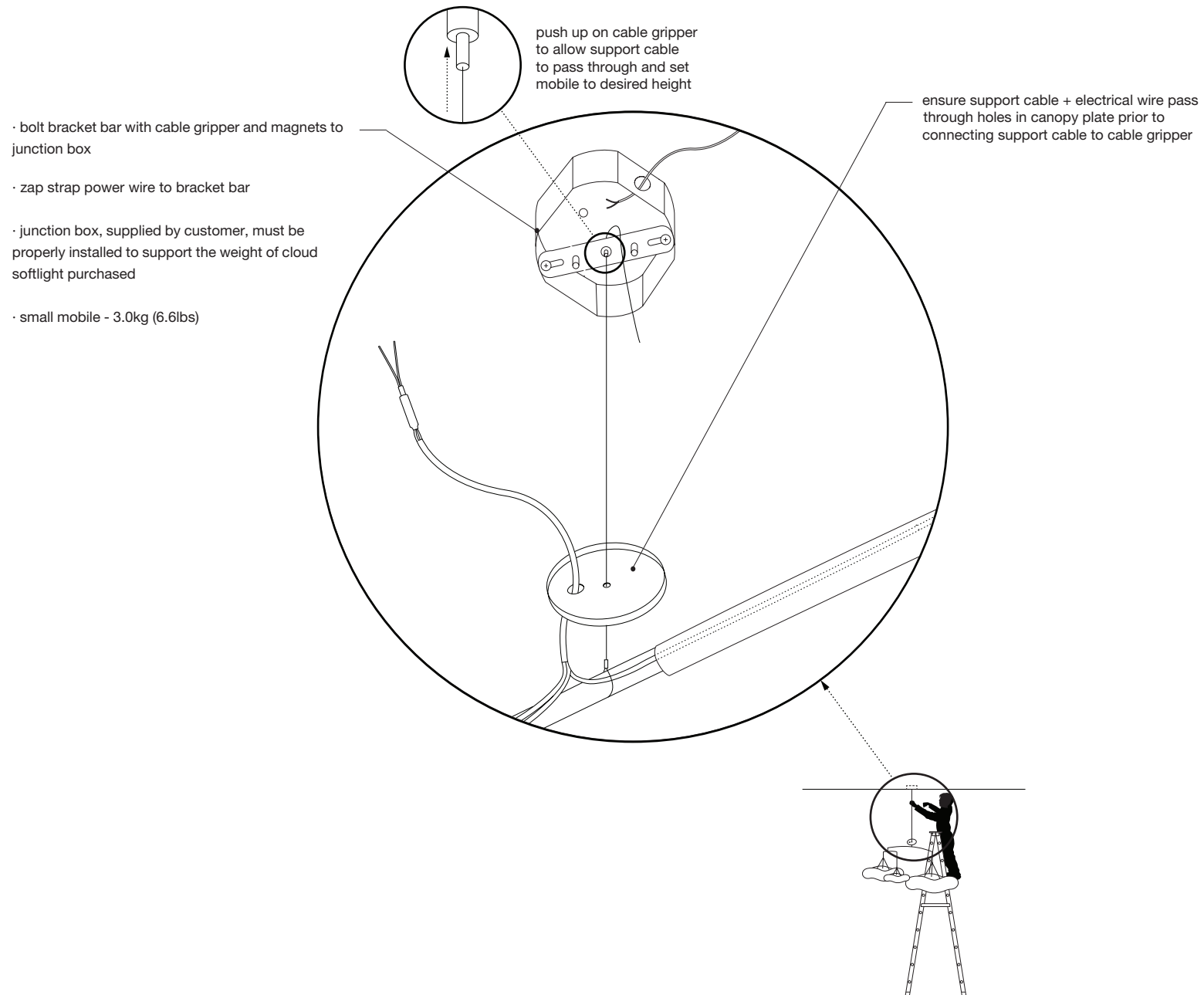

small cloud mobile installation

