

This drawing and the content represented is the exclusive property of molo design ltd. and cannot be used without their prior written consent. For site installations verify all dimensions and notify molo of any on-site discrepancies prior to construction. Drawing scale may be affected by printing, scanning, or copying. Do not scale drawings

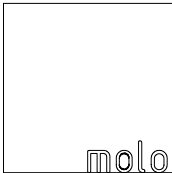

1470 Venables Street
Vancouver, BC
Canada V5L 2G7

+ 1 604 696 2501
www.molodesign.com

Designed by Stephanie Forsythe and Todd MacAllen, manufactured by molo and protected by one or more patents and/or design registrations held by molo, viewable at molodesign.com/ip

benchwall

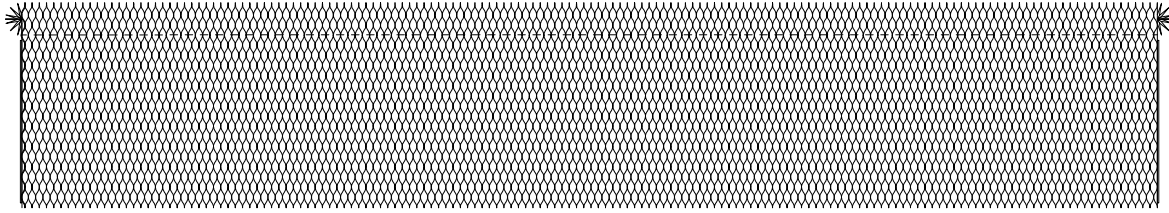

top view · expanded form

benchwall elements are flexible in length opening to maximum of 3.5 meters (11.5') long for paper materials

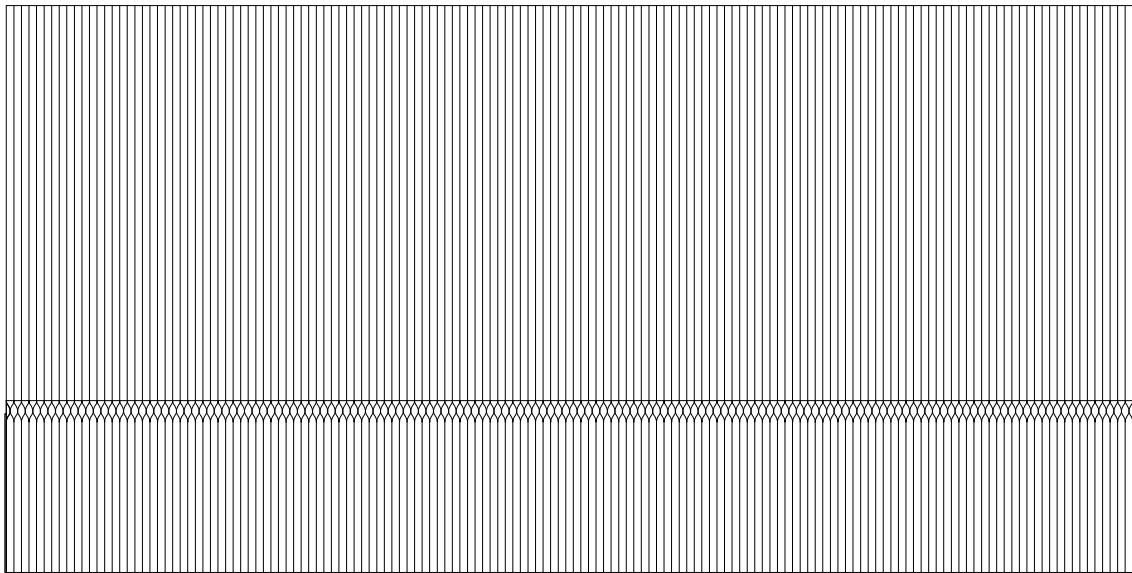

front view · expanded form

colour + material	weight	product code
natural brown · paper	28.30kg	BW-P-BR-06-11
black · paper	30.90kg	BW-P-BK-06-11
indigo blue · paper	30.90kg	BW-P-BU-06-11
white · textile · 2.5m long	23.50kg	BW-T-WH-06-08
white · textile · 5.0m long	46.90kg	BW-T-WH-06-16

optional accessories

· 380mm Ø (15") natural grey felted wool pad

fire rating certificates available

- M1 · France (paper)
- B1 · Germany (paper)
- NFPA 701 · United States (paper)
- ASTM 84-E · Class A · United States (textile)

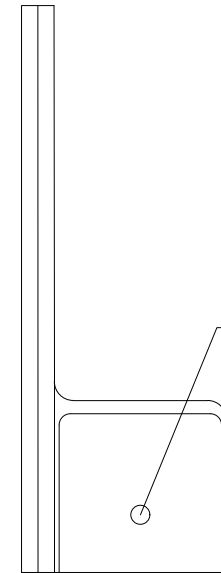

side view

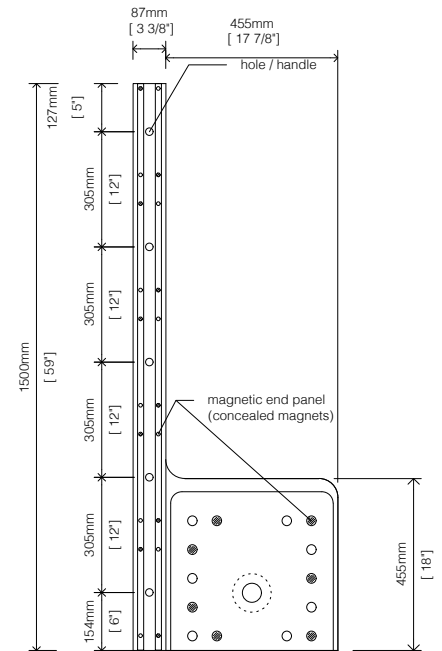

This drawing and the content represented is the exclusive property of molo design ltd. and cannot be used without their prior written consent. For site installations verify all dimensions and notify molo of any on-site discrepancies prior to construction. Drawing scale may be affected by printing, scanning, or copying. Do not scale drawings

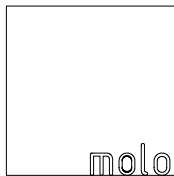

1470 Venables Street
Vancouver, BC
Canada V5L 2G7
+ 1 604 696 2501
www.molodesign.com

Designed by Stephanie Forsythe and Todd MacAllen, manufactured by molo and protected by one or more patents and/or design registrations held by molo, viewable at molodesign.com/ip

benchwall specifications

1:20
180514

benchwall · custom heights

· 12 - 14 week lead time and additional pricing may apply

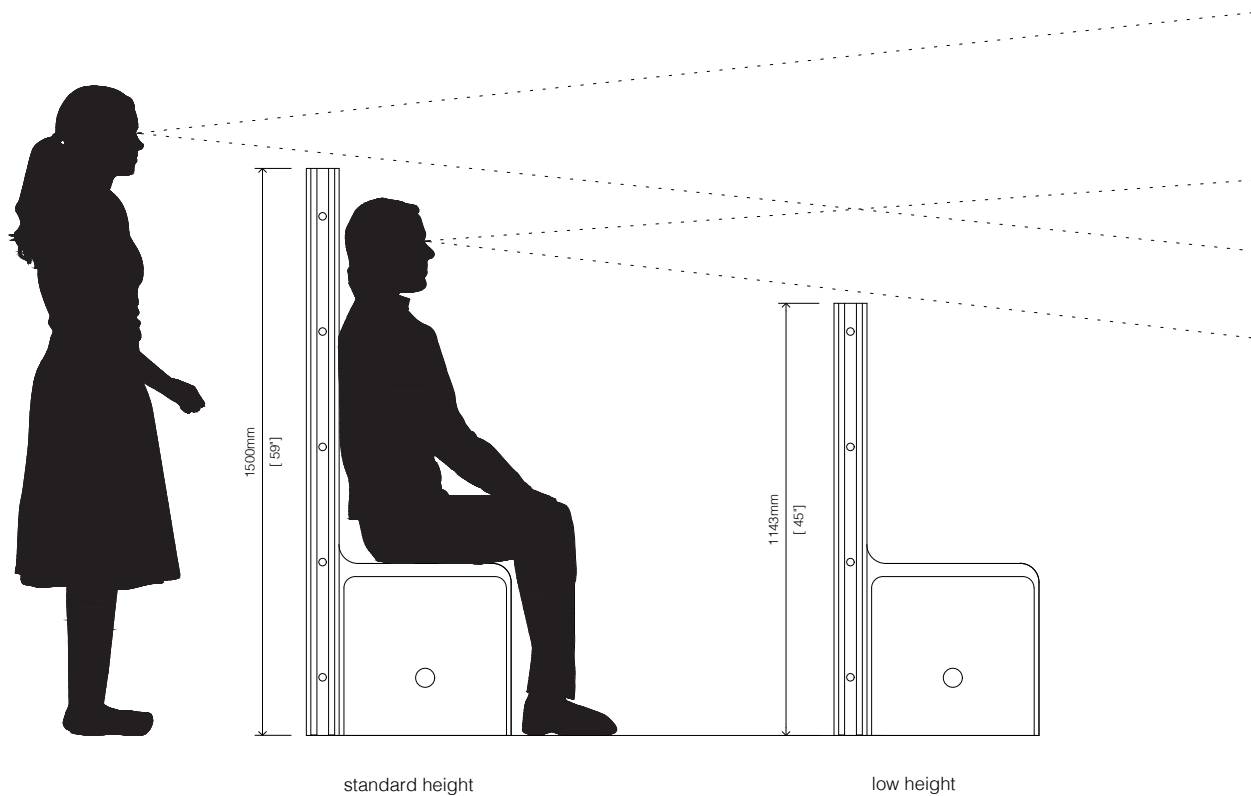

This drawing and the content represented is the exclusive property of molo design ltd. and cannot be used without their prior written consent. For site installations verify all dimensions and notify molo of any on-site discrepancies prior to construction. Drawing scale may be affected by printing, scanning, or copying. Do not scale drawings

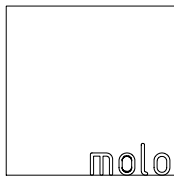

1470 Venables Street
Vancouver, BC
Canada V5L 2G7
+ 1 604 696 2501
www.molodesign.com

Designed by Stephanie Forsythe and Todd MacAllen, manufactured by molo and protected by one or more patents and/or design registrations held by molo, viewable at molodesign.com/ip

benchwall specifications

1:20
180514

02

benchwall · straight expanded form

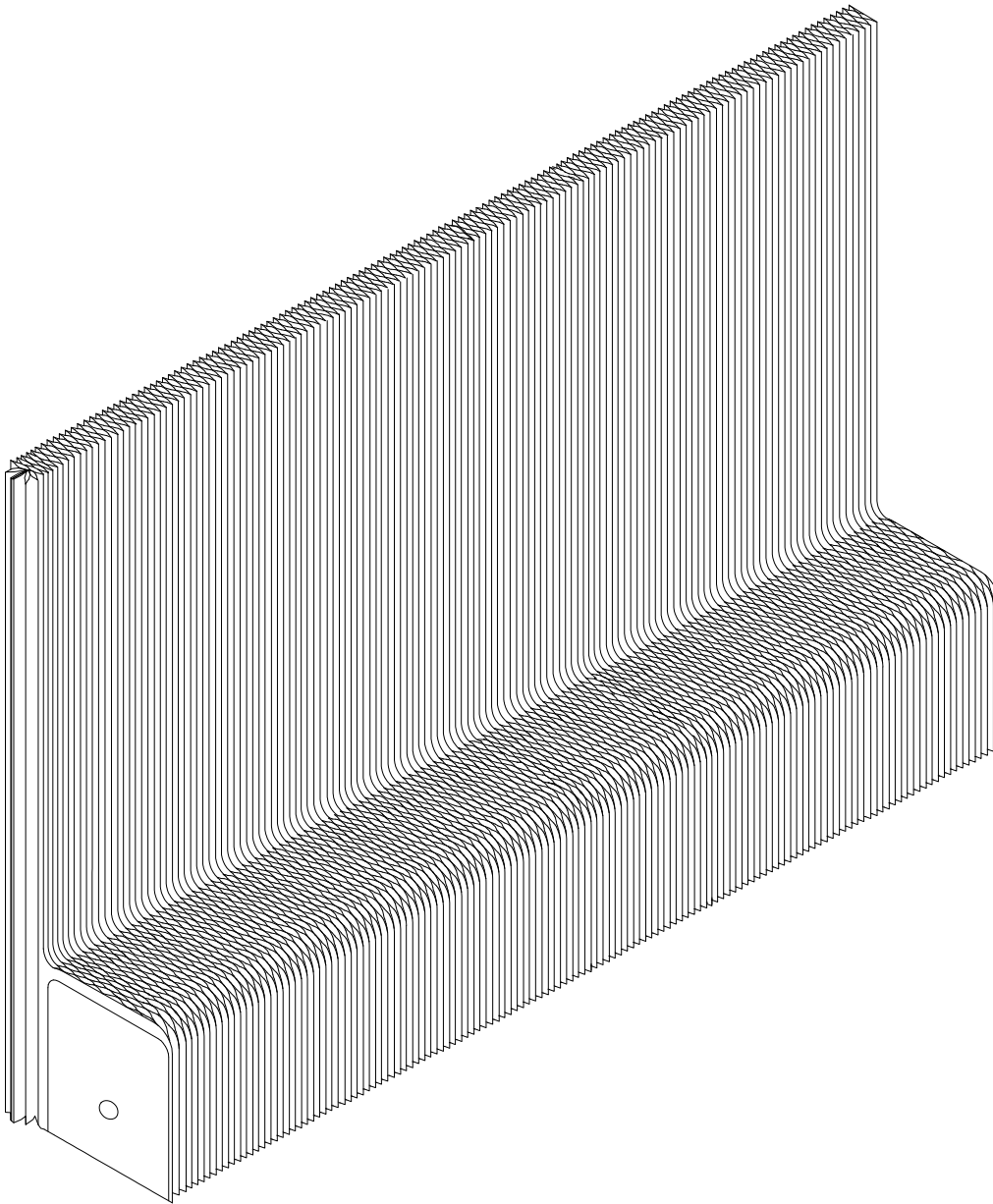

perspective view · expanded form (straight)

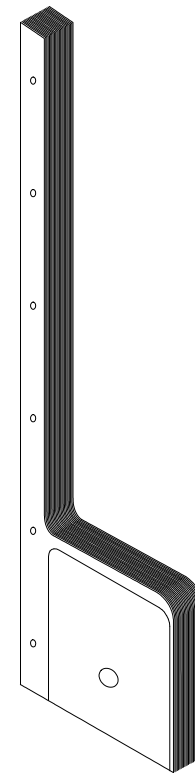

perspective view · compressed form

This drawing and the content represented is the exclusive property of molo design ltd. and cannot be used without their prior written consent. For site installations verify all dimensions and notify molo of any on-site discrepancies prior to construction. Drawing scale may be affected by printing, scanning, or copying. Do not scale drawings

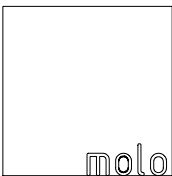

1470 Venables Street
Vancouver, BC
Canada V5L 2G7
+ 1 604 696 2501
www.molodesign.com

Designed by Stephanie Forsythe and Todd MacAllen, manufactured by molo and protected by one or more patents and/or design registrations held by molo, viewable at molodesign.com/ip

benchwall specifications

1:20
180514

03

benchwall · circular expanded form

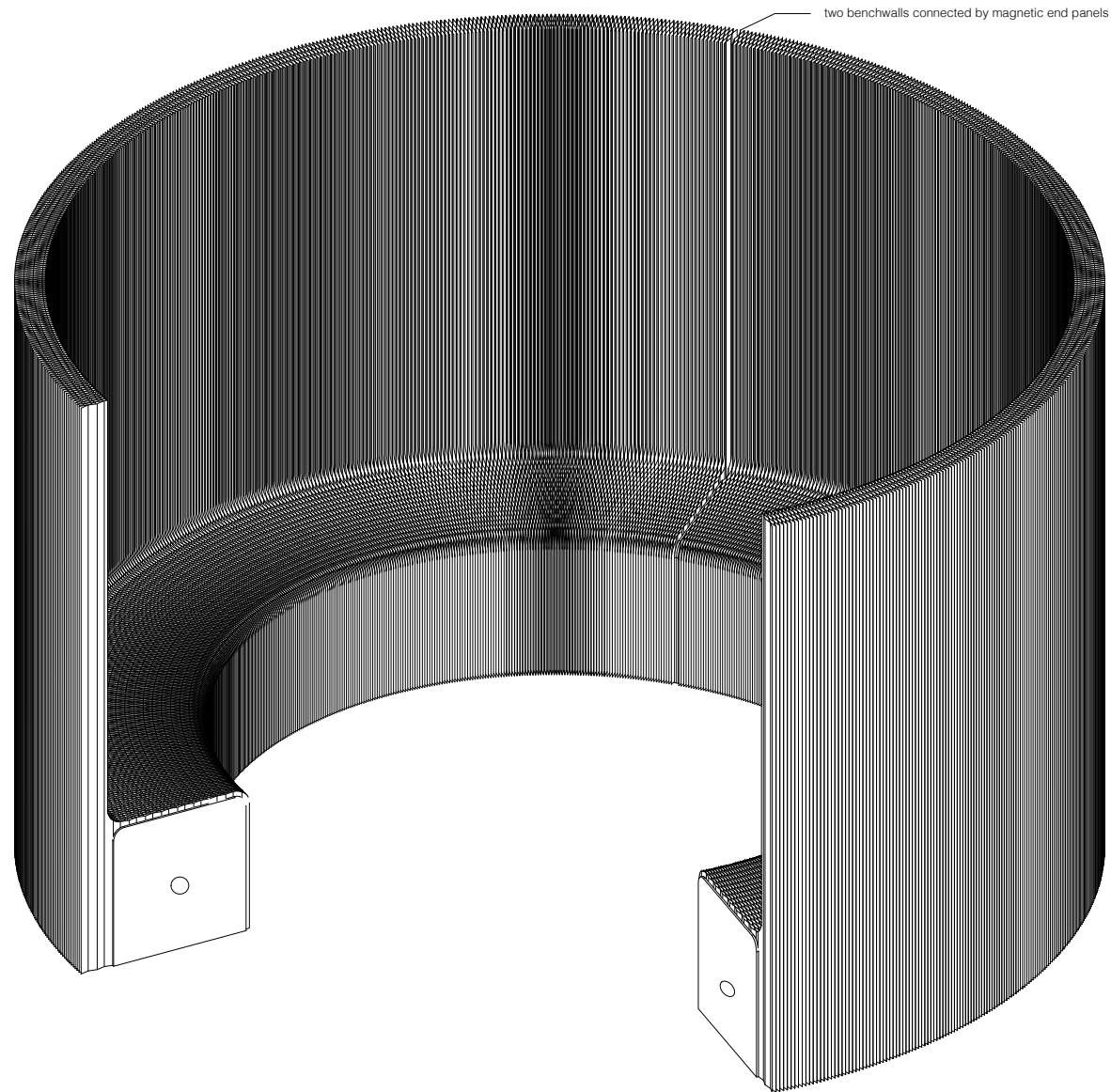

This drawing and the content represented is the exclusive property of molo design ltd. and cannot be used without their prior written consent. For site installations verify all dimensions and notify molo of any on-site discrepancies prior to construction. Drawing scale may be affected by printing, scanning, or copying. Do not scale drawings



1470 Venables Street
Vancouver, BC
Canada V5L 2G7

+ 1 604 696 2501
www.molodesign.com

Designed by Stephanie Forsythe and Todd MacAllen, manufactured by molo and protected by one or more patents and/or design registrations held by molo, viewable at molodesign.com/ip

benchwall specifications

180514

04