

large cloud mast · installation guide

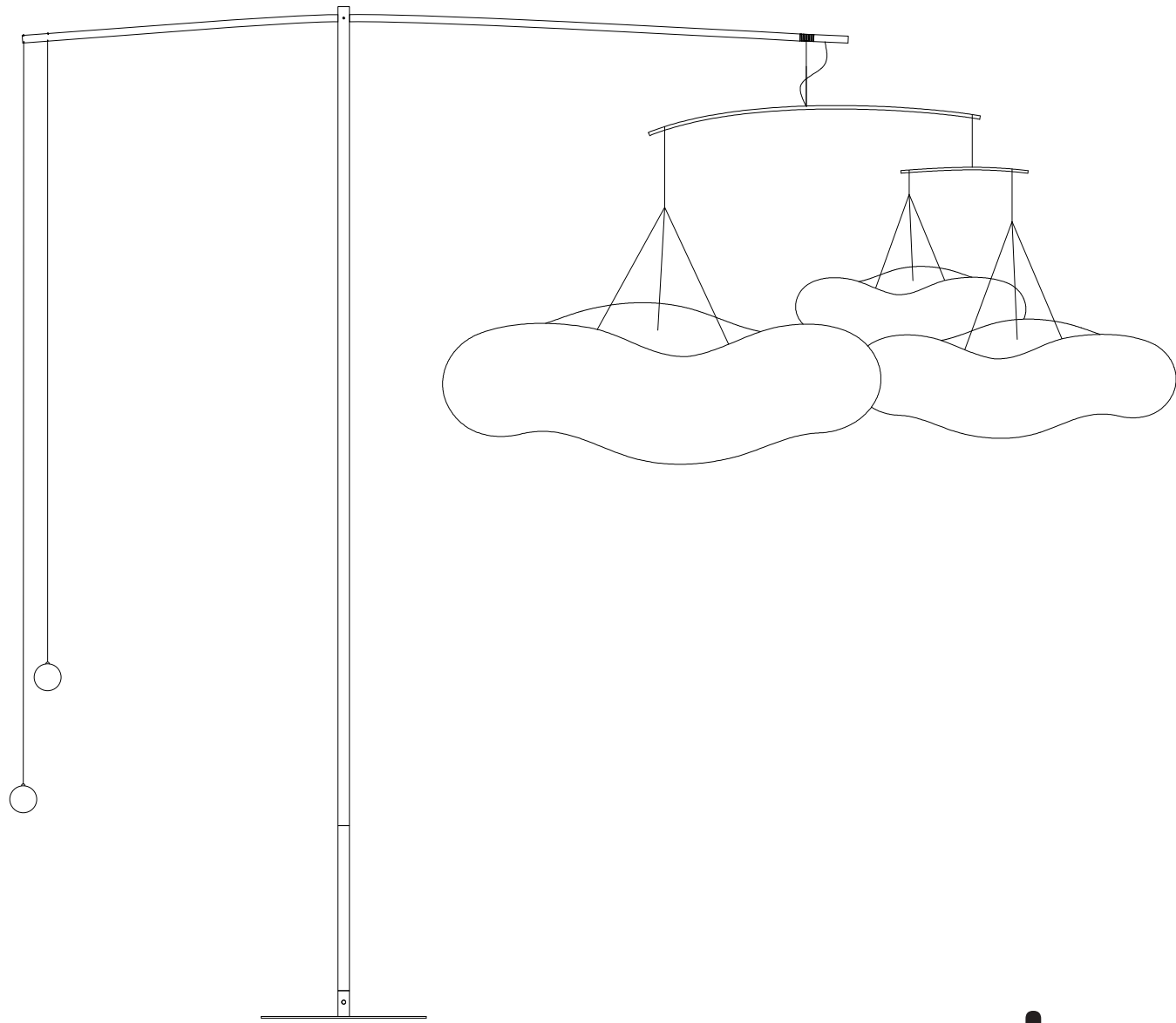

molo

large cloud mast anatomy

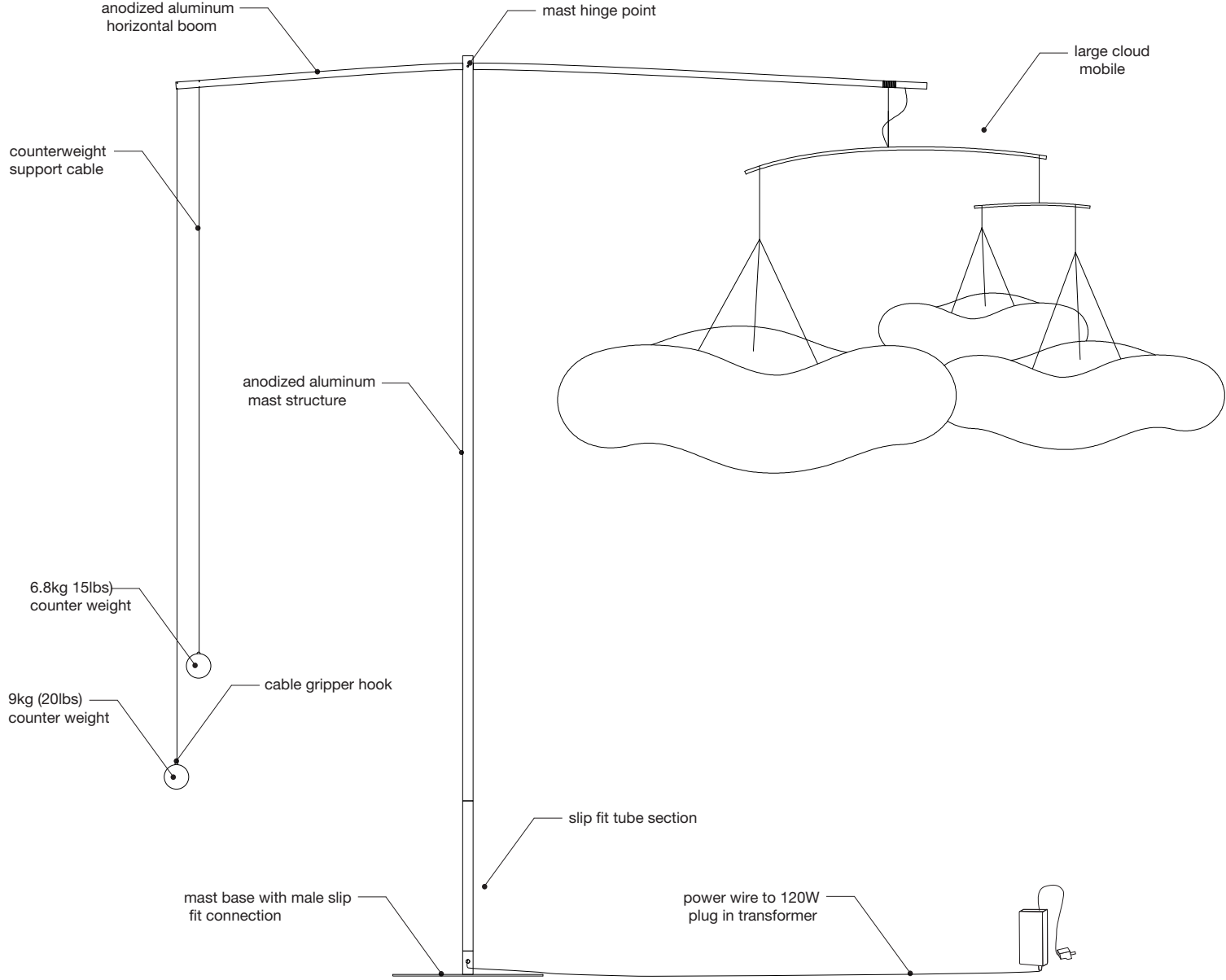

large cloud mast parts

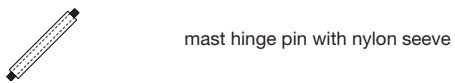
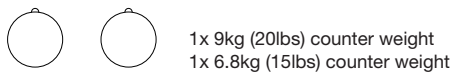
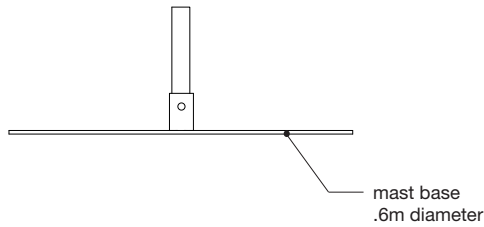
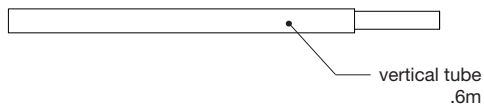
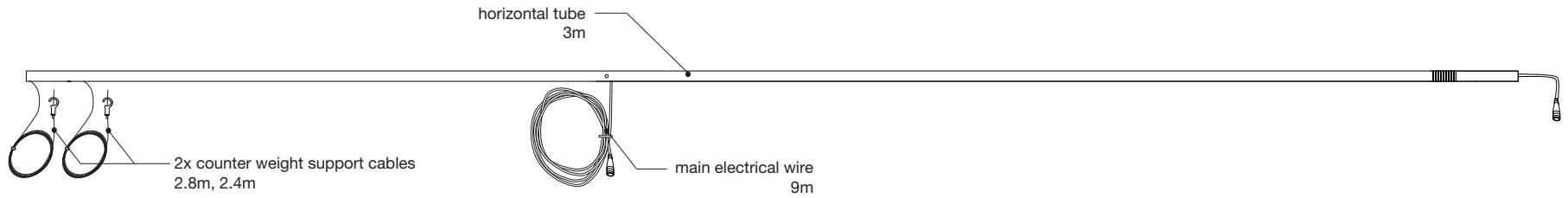

large cloud mobile anatomy

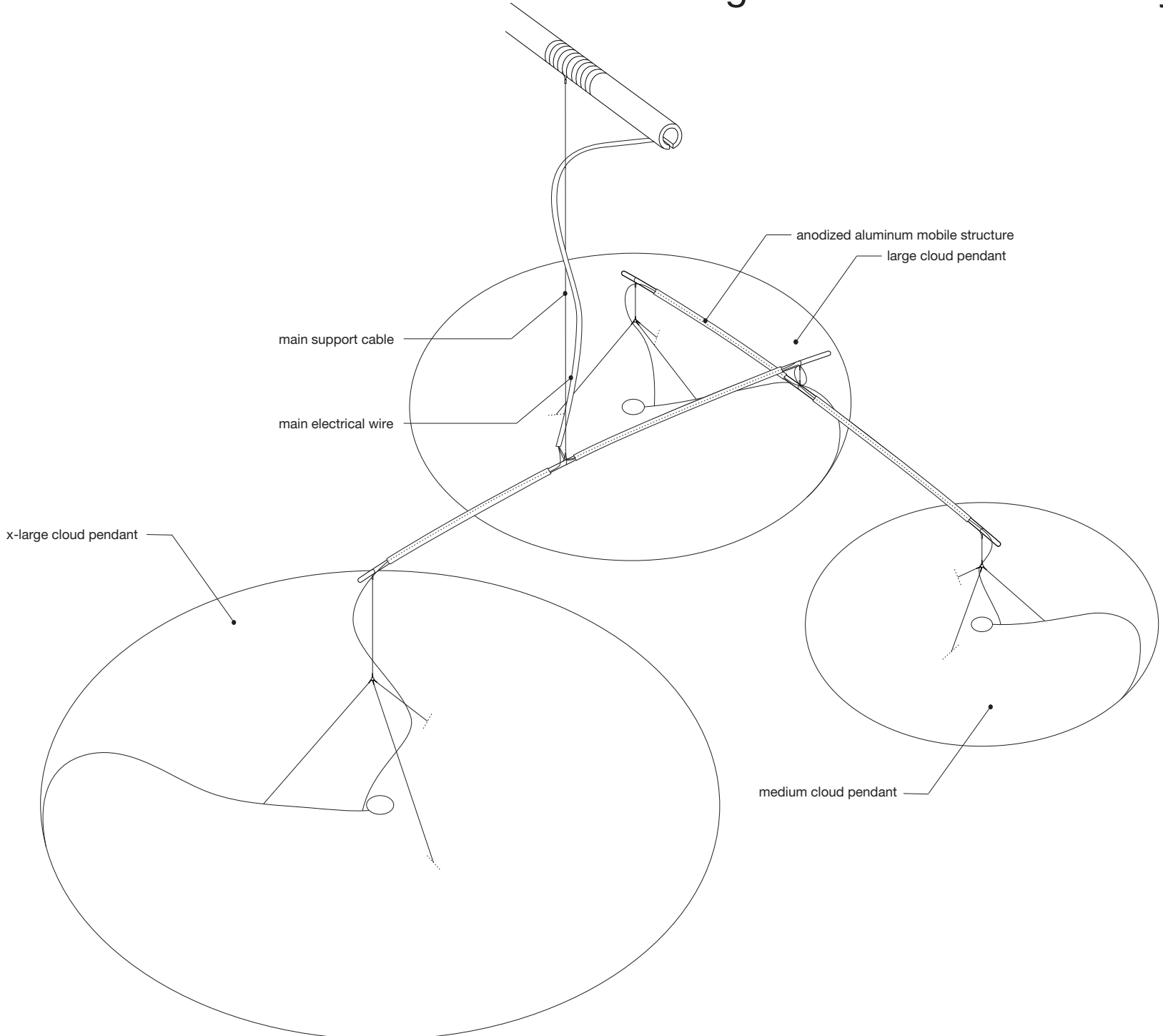

large cloud mobile parts

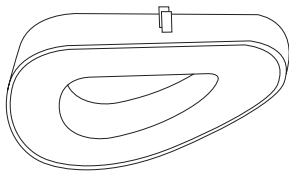
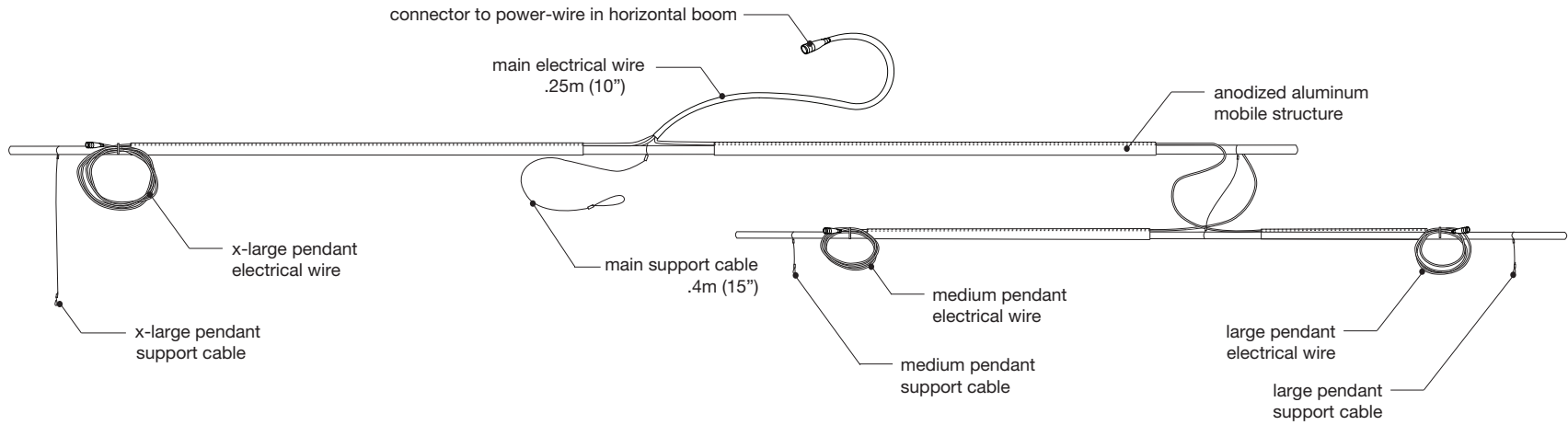

x-large shade (compressed for shipping)

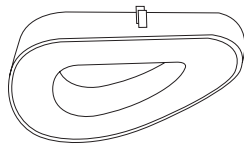

large shade (compressed for shipping)

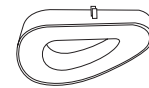

medium shade (compressed for shipping)

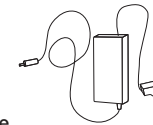

plug-in transformer

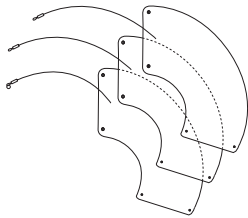

x-large shade armature (with chicago bolts)

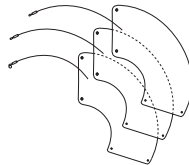

large shade armature (with chicago bolts)

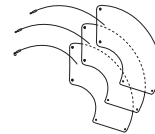

medium shade armature (with chicago bolts)



split ring pliers

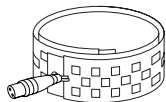

x-large LED ribbon (warm white or daylight white)

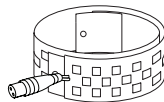

large LED ribbon (warm white or daylight white)

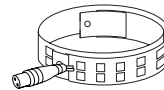

medium LED ribbon (warm white or daylight white)

anatomy of cloud pendant within mobile

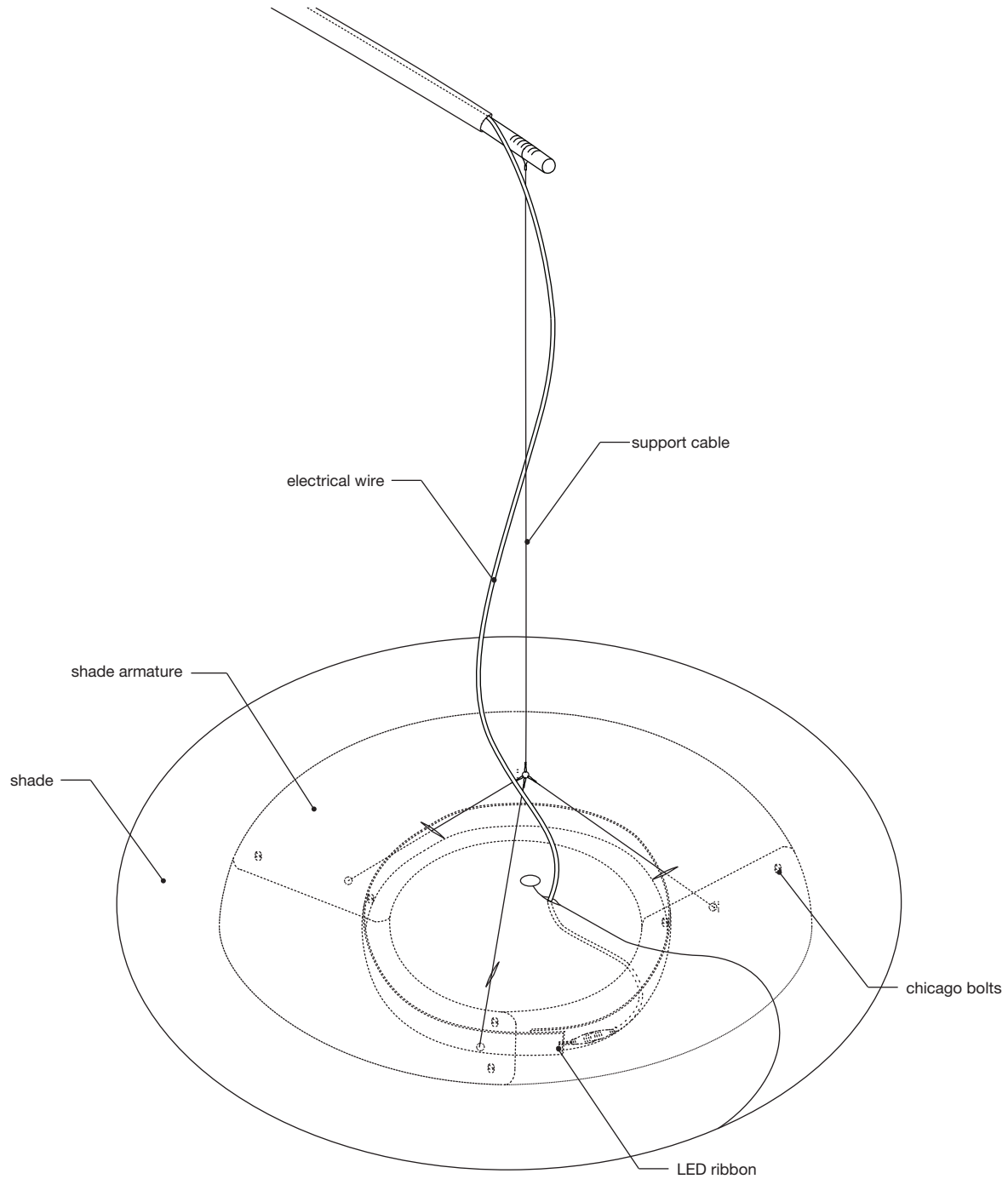

cloud pendant assembly

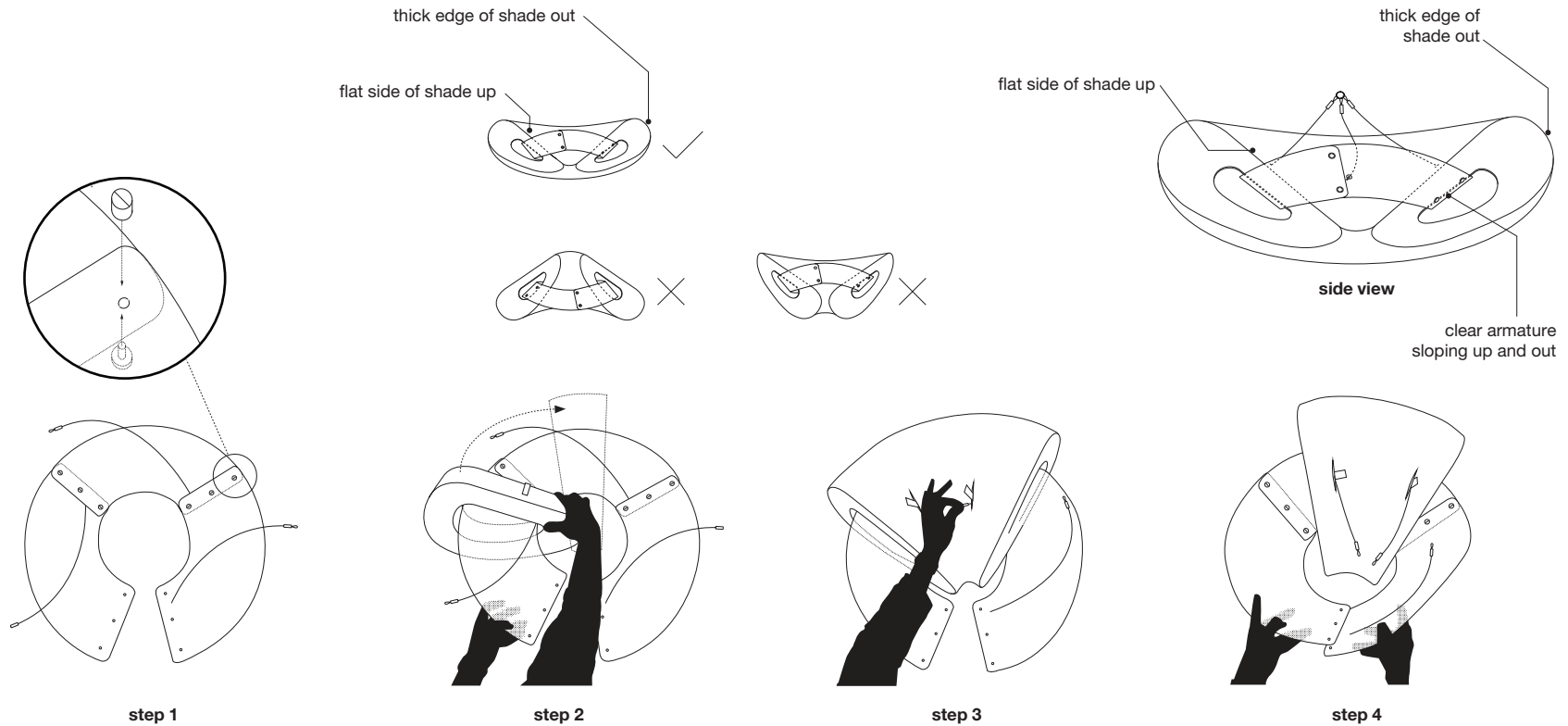

step 1: To assemble the cloud armature, peel off protective paper and lay all three clear plastic pieces on a flat surface. Check that the crimped loop-end of each steel support cable is on the top side. Hand-turn the chicago bolts to unscrew, and then line up holes of armature as shown above. Ensure that the side with attached support cable is underneath the piece to be connected. Screw pieces together to create a “C” shaped collar. Do not close the collar.

step 2: Feed armature through shade cavity. Flat side of shade should face up with thick edge of shade at outer perimeter.

IMPORTANT: If this step is not done correctly you will end up with a “droopy” looking cloud. Be sure the clear plastic armature forms a truncated cone shape with the larger diameter facing up and the centre of the cone pointing down as shown in the drawing above on right side of page. Also note the orientation of cloud shade shape shown above, with flat side on top and smaller pointed end toward the centre.

step 3: Feed two support cables through the larger cells of the shade. The larger cells are marked with coloured tags.

step 4: Line up the holes of the last set of connection points in plastic armature. Start with the holes closest to the centre, screw together. By lifting the outside perimeter of armature you will create a truncated cone that slopes down to the centre. Screw in the last chicago bolts.

cloud pendant assembly

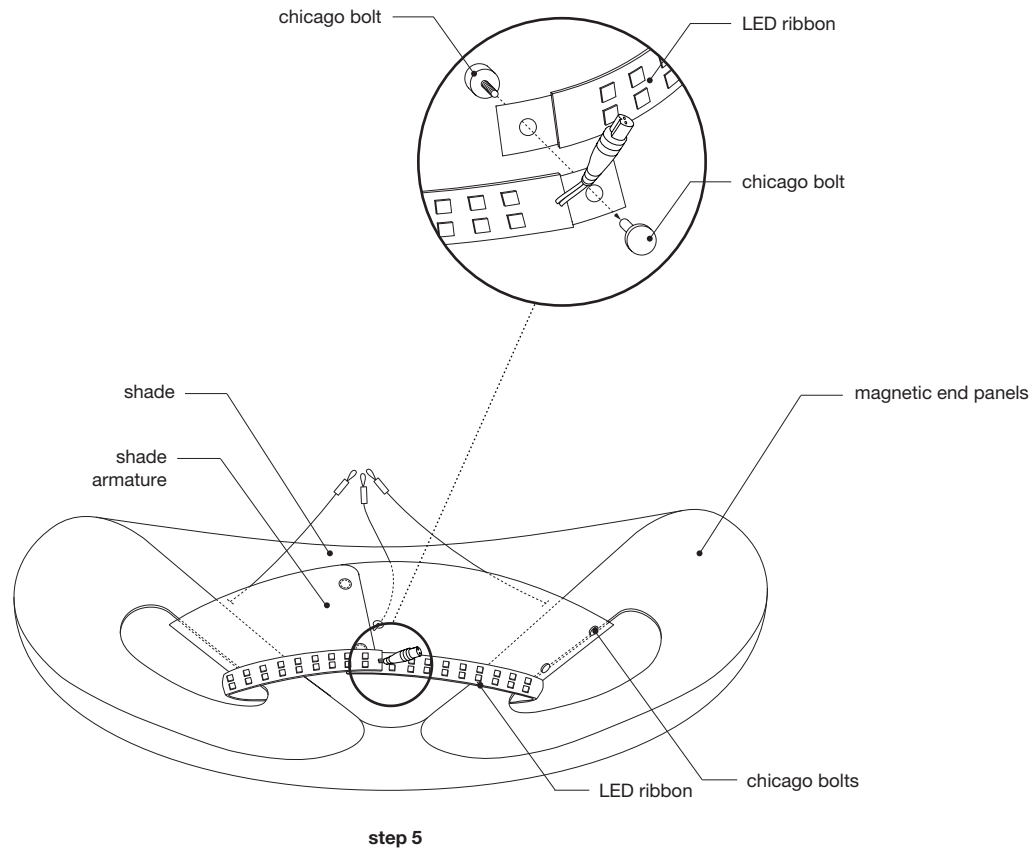

step 5: Feed LED ribbon through textile shade cavity, making sure LED is under clear plastic armature. Connect the ends of the LED strip together to form a ring, ensuring the LED chips face outwards then fasten with aluminum chicago bolt provided.

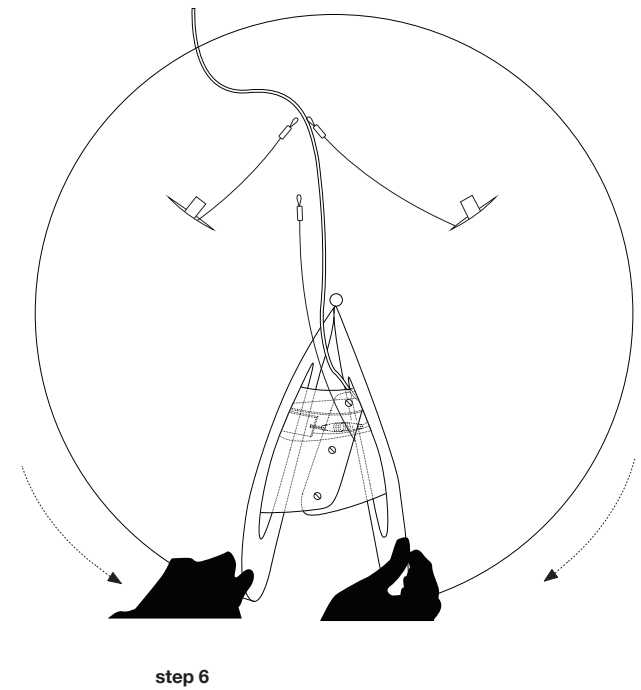

step 6: Close the shade around the armature by holding inside the shade cavity and pulling the magnetic end panels around to connect to each other. The third steel support cable and electrical wire sandwich between the two magnetic end panels.

large cloud mobile assembly

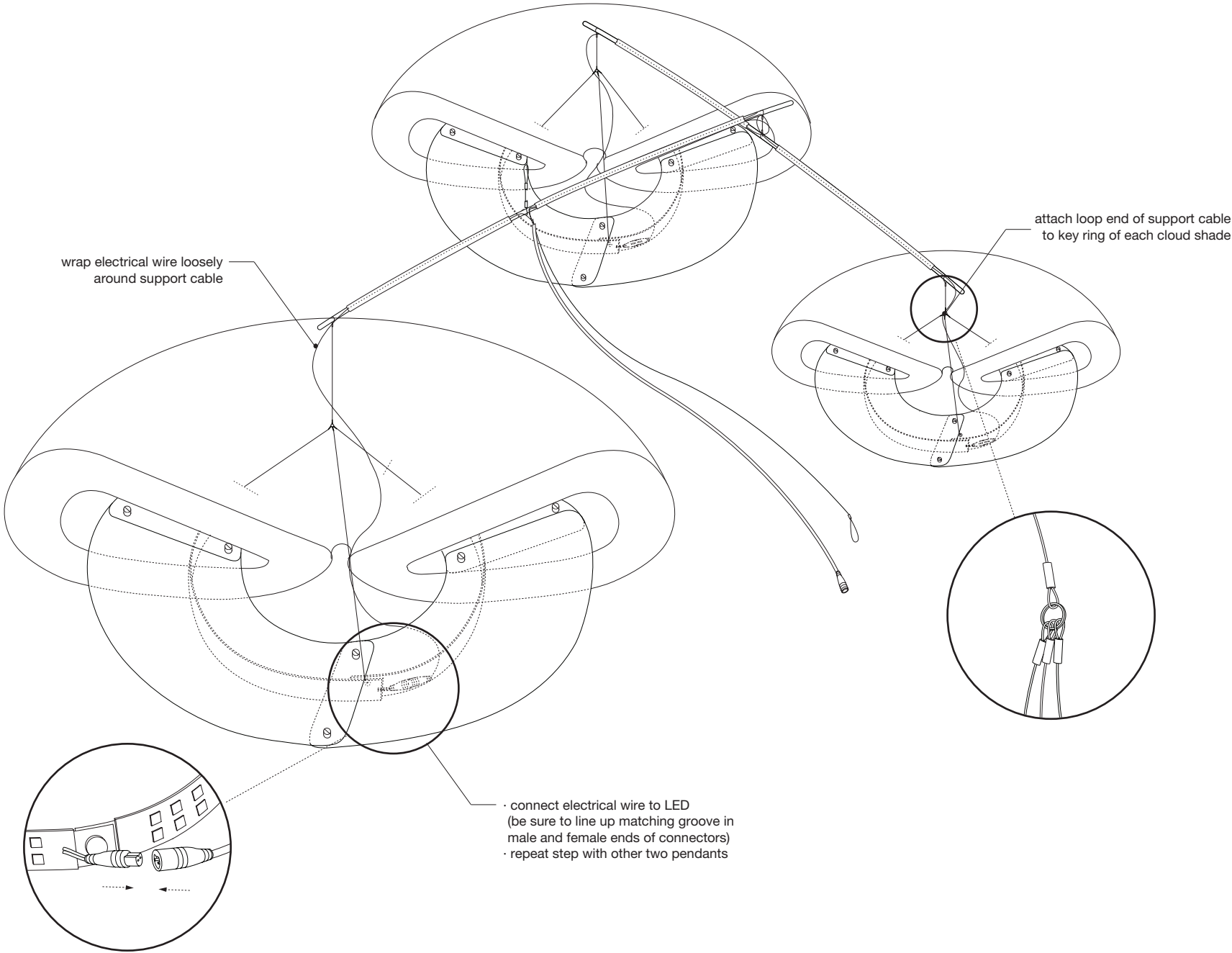

large cloud mast assembly

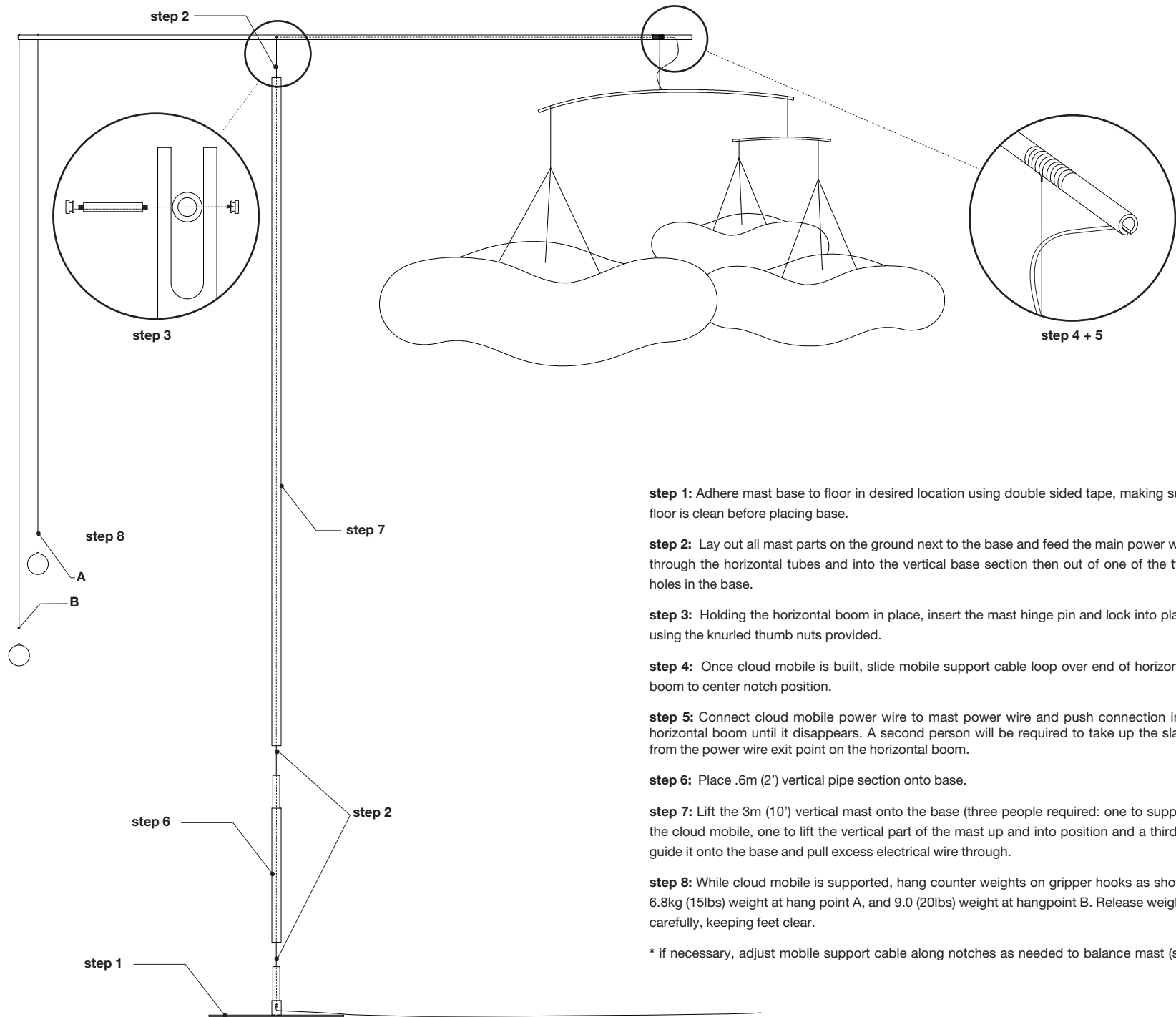

step 1: Adhere mast base to floor in desired location using double sided tape, making sure floor is clean before placing base.

step 2: Lay out all mast parts on the ground next to the base and feed the main power wire through the horizontal tubes and into the vertical base section then out of one of the two holes in the base.

step 3: Holding the horizontal boom in place, insert the mast hinge pin and lock into place using the knurled thumb nuts provided.

step 4: Once cloud mobile is built, slide mobile support cable loop over end of horizontal boom to center notch position.

step 5: Connect cloud mobile power wire to mast power wire and push connection into horizontal boom until it disappears. A second person will be required to take up the slack from the power wire exit point on the horizontal boom.

step 6: Place .6m (2') vertical pipe section onto base.

step 7: Lift the 3m (10') vertical mast onto the base (three people required: one to support the cloud mobile, one to lift the vertical part of the mast up and into position and a third to guide it onto the base and pull excess electrical wire through).

step 8: While cloud mobile is supported, hang counter weights on gripper hooks as shown 6.8kg (15lbs) weight at hang point A, and 9.0 (20lbs) weight at hangpoint B. Release weights carefully, keeping feet clear.

* if necessary, adjust mobile support cable along notches as needed to balance mast (see

