

attaching double steel anchor strip to wall · use guide

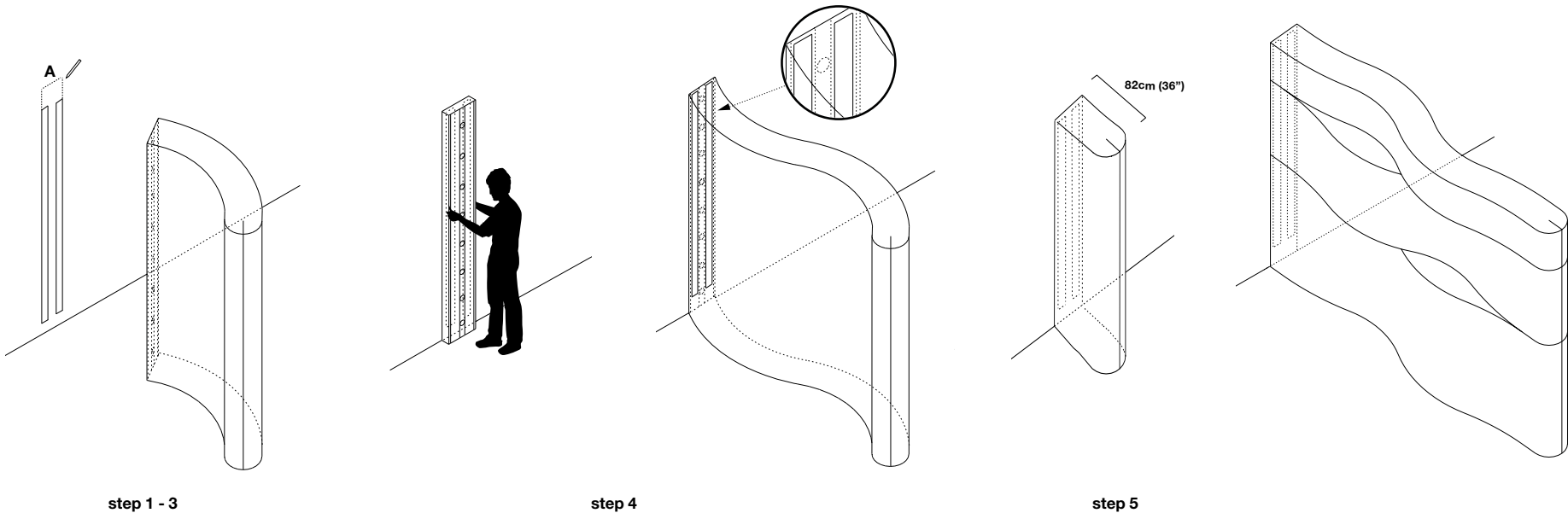

set up

step 1: Ensure the wall is even, clean and dry before starting. Set up softwall in upright position to use as a guide for placement, noting that the anchor strip has been made shorter than softwall to accommodate a low profile baseboard of up to 6" (15cm). Lightly mark with pencil the location of outside raised edge of the magnetic end panel on one side of the softwall (this will be the placement of your first anchor strip). Dimension "A" shown above is the dimension from the outer side of one steel strip to the outer side of the other strip.

Measure the appropriate distance for the second strip by referring to the 'dimensions for anchor strip placement'.

step 2: Remove red backing from adhesive on back of steel anchor strip and press firmly into position on wall, following your marks. Running your hands up and down the metal, make sure it is firmly pressed on along the full length.

*NOTE if space is cold you should warm the surface of the wall and steel anchor strip with a heat gun or hair dryer for the adhesive to make a good bond. Take care not to cause damage by overheating.

step 3: Allow adhesive to cure for 24 hours before installing softwall.

step 4: Attach softwall + softblock by connecting the magnetic end panels directly to the set steel strip. When pulling softwall open, lift leading edge of softwall 3cm (1") off floor.

step 5: When compressing softwall with anchor strip, fully compress softwall then expand layers near the exposed end of the softwall to at least 82cm (36") for stability.

use + care

- To remove strip, first heat with a hair dryer or other warming device. Tape will soften for easier removal. Some paint may be removed with adhesive.
- Baby wipes work well for cleaning the powder coated steel strip (or any nonabrasive cloth + water).

dimensions for anchor strip placement

Follow dimensions below for optimal placement of anchor strips. Measurement is taken from the outer edge of each strip.

width of softwall	outer width of softwall strips
9.25" (235mm)	7 3/4" (195mm)
11.5" (290mm)	10" (255mm)
13.3" (340mm)	11 3/4" (300mm)
17.75" (450mm)	16 1/2" (420mm)

Designed by Stephanie Forsythe and Todd MacAllen, manufactured by molo and protected by one or more patents and/or design registrations held by molo, viewable at molodesign.com/ip