

attaching single steel anchor strip to wall · use guide

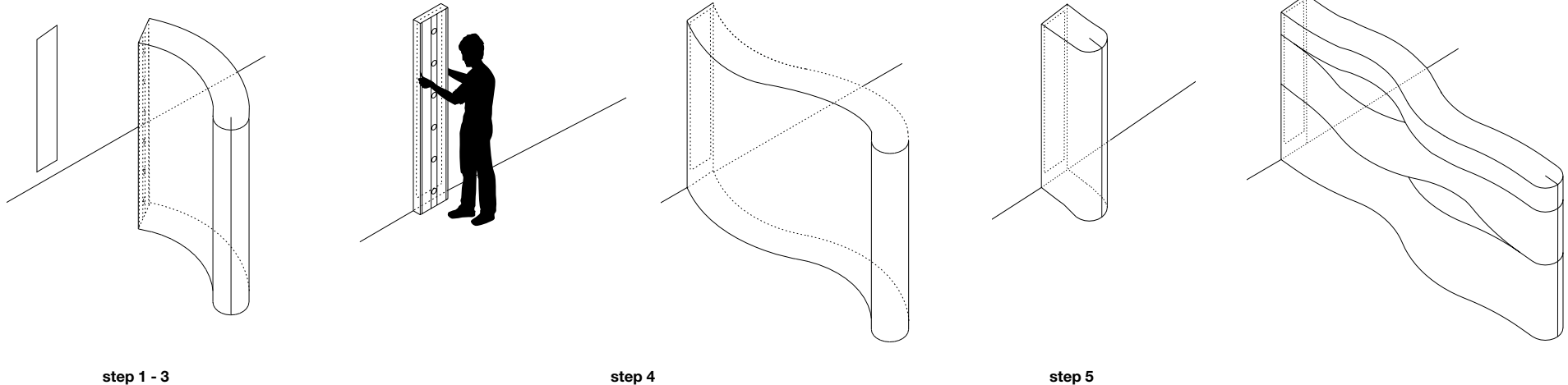

set up

step 1: Ensure the wall is even, clean and dry before starting. Set up softwall in upright position to use as a guide for placement, noting that the anchor strip has been made shorter than softwall to accommodate a low profile baseboard of up to 6" (15cm). Lightly mark the location with pencil.

step 2: Remove red backing from adhesive on back of steel anchor strip and press firmly into position on wall, following your marks. Running your hands up and down the metal, make sure it is firmly pressed on along the full length.

*NOTE if space is cold you should warm the surface of the wall and steel anchor strip with a heat gun or hair dryer for the adhesive to make a good bond. Take care not to cause damage by overheating.

step 3: Allow adhesive to cure for 24 hours before installing softwall.

step 4: Attach softwall + softblock by connecting the magnetic end panels directly to the set steel strip. When pulling softwall open, lift leading edge of softwall 3cm (1") off floor.

step 5: When compressing softwall with anchor strip, keep softwall extended at least 61cm (2') for stability.

use + care

- To remove strip, first heat with a hair dryer or other warming device. Tape will soften for easier removal. Some paint may be removed with adhesive.
- Baby wipes work well for cleaning the powder coated steel strip (or any nonabrasive cloth + water).

use with

- 5 foot tall (152.5 centimeters) softwall
- 6 foot tall (183 centimeters) softwall
- 6 foot tall (183 centimeters) thinwall

Designed by Stephanie Forsythe and Todd MacAllen, manufactured by molo and protected by one or more patents and/or design registrations held by molo, viewable at molodesign.com/ip