

extension for softwall + softblock · use guide

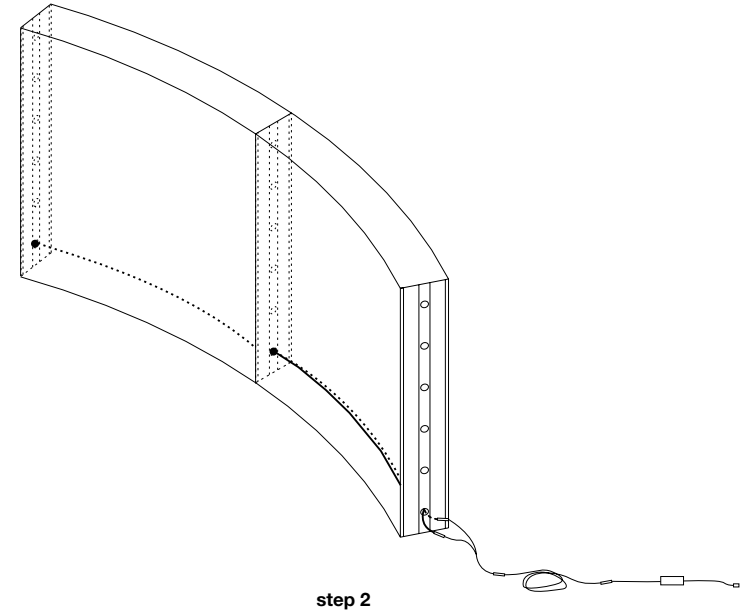
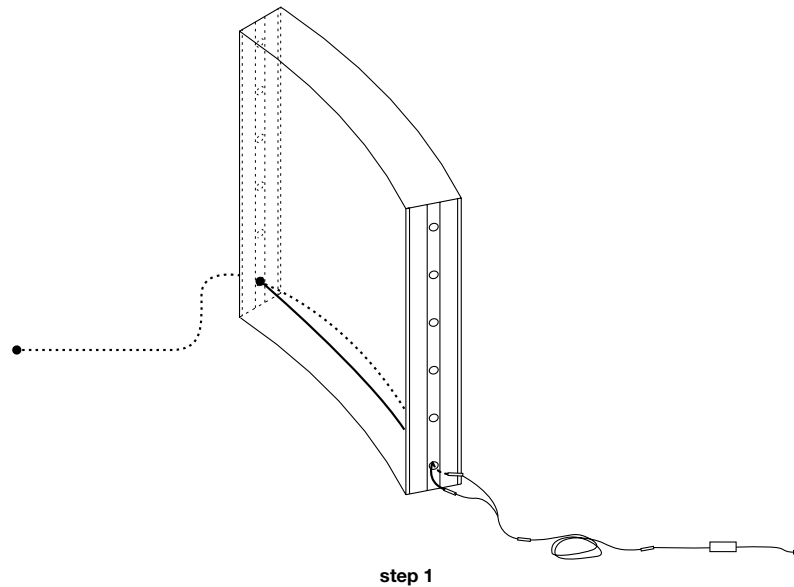

set up – two softwalls or softblocks with LEDs to one electrical outlet

step 1: Feed the LED and the LED with extension through the first softwall so that the connectors all emerge from the hole nearest to the electrical outlet that they are to be connected to. There should now be one LED with an extension long enough to be fed into the second softwall.

step 2: Thread the remaining LED with extension through the second softwall, friction fitting the foam ball in the hole.

step 3: Close the end panels.

Designed by Stephanie Forsythe and Todd MacAllen, manufactured by molo and protected by one or more patents and/or design registrations held by molo, viewable at molodesign.com/ip