

lounger · use guide

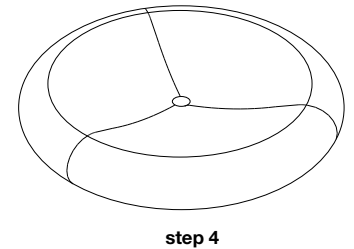
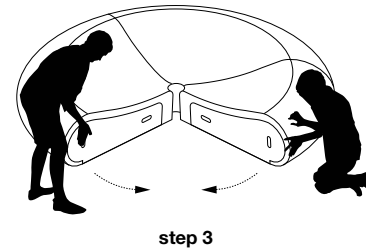
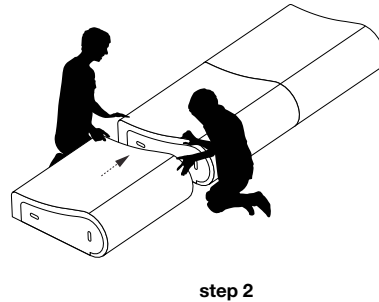
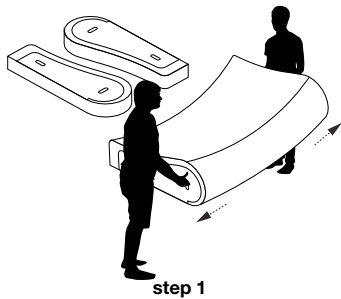

set up

step 1: Each part of softseating 3-part fanning lounger must be individually stretched before the parts are attached. Place pieces flat side down. With two people, each holding end panel handles, walk backwards, giving the honeycomb structure a good stretch.

step 2: As each part is stretched, join together by connecting magnetic end panels with long flat edge down.

step 3: Once all 3 parts are joined, fan into a circular configuration with the small flat edge on the inside of the circle and the large curved edge on the outer circumference.

step 4: Complete the lounger by joining the last two magnetic end panels together.

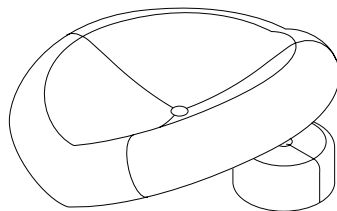
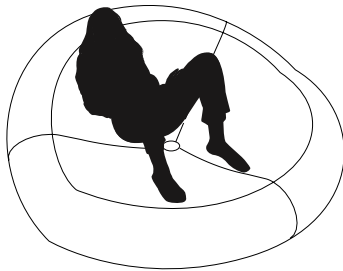

use + care

- With use, the surface texture of softseating will slightly crush forming a natural patina. This is more pronounced in the paper version than in the textile version. In either case, it is the material's natural response to use and structural integrity is maintained.
- paper softseating cannot get wet. textile softseating, being made of a polyethylene material, can be wiped down but should not be left immersed in water.
- Either version of softseating can be used in an outdoor environment that is dry and clean. textile softseating can further be used in a semi-wet environment.
- When handling softseating, grip a few fins rather than handling a single fin.
- When separating the magnetic end panels, pry fingers between the connected panels to release the magnets rather than pulling on the fins.
- Ensure softseating is correctly opened before use, with honeycomb cells vertically aligned and open at the top of the seat. Do not sit on a seat with the cells horizontally aligned.
- paper softseating is treated with a fire retardant and will not hold a flame. Contact molo for specific fire rating information.
- softseating is intended to have a long, useful life. Nevertheless, they are made with material that is 100% recyclable (just remove magnetic end panels). The paper used for brown and blue softseating is made from wood harvested from FSC® Certified (FSC® C158591) responsible sources. textile softseating is 100% polyethylene and is ♻ in the recycling stream.

Designed by Stephanie Forsythe and Todd MacAllen, manufactured by molo and protected by one or more patents and/or design registrations held by molo, viewable at molodesign.com/ip