

cloud softlight · 12V luminaires

cloud softlight creates a canopy of gentle, luminous forms. Available as individual pendants or suspended mobiles, cloud provides diffused light and a sense of intimate enclosure. Grouping pendants and mobiles together creates vast, sculptural skylscapes.

The airy, honeycomb shades are lit from within by energy-efficient 90+ CRI LEDs. When dimmed, they conjure a stormy atmosphere, bringing a unique feeling to an installation or space. At full brightness, the luminaires provide gentle light that is perfect to work, read, eat and live by. The honeycomb structure of cloud softlight also absorbs sound, subduing reflected noise within a space.

Design by Stephanie Forsythe + Todd MacAllen



This drawing and the content represented is the exclusive property of molo design ltd. and cannot be used without their prior written consent. For site installations verify all dimensions and notify molo of any on-site discrepancies prior to construction. Drawing scale may be affected by printing, scanning, or copying. Do not scale drawings.



molo design, ltd.
1470 Venables Street
Vancouver, BC
Canada V5L 2G7

+ 1 604 685 0340
molodesign.com

Designed by Stephanie Forsythe and Todd MacAllen,
manufactured by molo and protected by one or more patents and/or design registrations held by molo, viewable at molodesign.com/ip

IMPERIAL DRAWING SET

COLOUR TEMPERATURE

Colour temperature is a scale that measures how 'warm' (yellow) or 'cool' (blue) the light from a particular source is. Measured in degrees Kelvin (K) on a scale from 1,000 to 10,000, the higher the number, the 'cooler' the light. The lower the 'K' number, the 'warmer' the light.

cloud softlight collection colour temperatures:
4000K · neutral white
3000K · warm white - please inquire
2700K · warmer white

90+ CRI

Colour Rendering Index (CRI) measures the ability of a human-made light source to reproduce the colours of the object it illuminates accurately. With a maximum score of 100, CRI values that are 90 and above are considered excellent, while scores below 80 are generally considered poor. CRI is measured in relation to the colour temperature of the light source and its equivalent daylight spectrum. All molo lighting, including the cloud softlight collection, is made with 90+ CRI LEDs.

ACOUSTICS

The textile honeycomb structure of the shades absorbs sound and reduces the reflected noise in a room. cloud luminaires are an elegant way to float acoustic panels overhead, helping to improve the clarity of speech and provide an acoustically calm room.

Noise Reduction Coefficient (NRC) is a single number rating, ranging from 0 to 1, representing the average sound Absorption Coefficients of a product at specific mid-range frequencies (tested at 250, 500, 1,000, and 2,000 Hz octaves). cloud softlight has an NRC of 0.45, meaning that it absorbs 45% of the sound that comes in contact with it.

MATERIAL

The translucent white shades of cloud softlight have a visually delicate appearance reminiscent of Japanese washi paper, and the pattern of its fine translucent fibres comes to life when illuminated. The shades are made from recyclable, non-woven polyethylene (HDPE). This non-woven textile is anti-static (repels dust), tear-resistant and water-resistant. Made to order for molo, our textile is a bright white that has an impressive colour consistency over time. It is easy to maintain, can be dusted and vacuumed, and, if necessary, can be wiped clean with a soft cloth, water and liquid dish soap.

Our white textile is a bright white. Below is a list of close colour matches for our white textile material. Please note that the translucency of the textile, variation in fibre density across the surface and pleated structure of the design cause variation in appearance with light and shadow.

RAL Classic 9016
Pantone 663 C
NCS S 0300-N
Corian Glacier White

FIRE RATING

The non-woven textile used for cloud softlight shades has a Class A fire rating (tested according to ASTM E84-89a). This is a US rating that measures how well a particular item performs in the event of smoke or fire. A Class A fire rating represents the highest classification in this test and indicates materials do not catch fire easily and are very unlikely to contribute fuel to a fire. The nonwoven textile shrinks/melts away from flames and gives off negligible smoke if consumed by a fire. The melting point is 135°C, and the ignition point is approximately 400°C. This material is suitable for most applications.

CLOUD SHADE POROSITY

By virtue of their honeycomb structure, molo cloud softlight fixtures do not form a solid surface. While the diameter of the x-large shade is 63 3/4 inches (161.9 centimetres), the percentage of openness of its area is 93%, allowing air, water and dust to pass unobstructed through the vertically oriented cells.

x-large cloud pendant: 93% open
large cloud pendant: 90% open
medium cloud pendant: 89% open
small cloud pendant: 89% open

IES FILES

An IES file is a text file that describes the intensity of a light source at points on a spherical grid. It provides more photorealistic lighting effects in rendered images than other types of light distribution. Download IES files for cloud softlight at <https://molodesign.com/documentation/product-drawings/>

2D + 3D DRAWING FILES

AutoCAD, Sketchup, Revit, 3DS and Rhino drawing files for the entire cloud softlight collection are available for download at <https://molodesign.com/documentation/product-drawings/>

DRIVER CERTIFICATIONS

UL · North America	The UL-listed seal means that the product has been tested by UL to nationally recognized safety and sustainability standards. Additionally, it has been found to be free from a reasonably foreseeable risk of fire and electric shock in a Division 2 environment.
EMC Verification of Conformity · International	Electromagnetic compatibility (EMC) testing measures an electrical product's ability to function satisfactorily in its intended electromagnetic environment without generating intolerable electromagnetic disturbances to anything in that environment.
CB Test · International	CB Certification refers to the CB scheme. The CB scheme is the world's first international system for the mutual acceptance of product safety test reports and certificates for electrical and electronic equipment, devices, and components.
CE Declaration of Conformity · Europe	The CE marking is a regulatory standard that verifies certain products are safe for sale and use in the European Economic Area (EEA).
LVD · Europe	The acronym "LVD" refers to the Low Voltage Directive, initially adopted in 1973 and subsequently amended to set stringent rules for the quality testing of electronic tools. The primary objective of CE LVD Certification is to ensure the safety of electrical equipment sold within the EU.
ENEC · Europe	The ENEC (European Norms Electrical Certification) is a European Mark for electrical products that demonstrates compliance with European safety standards. This mark demonstrates third-party certification and includes production control, ensuring the quality of the products is maintained.
TÜV · Germany	TÜV is short for Technischer Überwachungsverein in German, which means Technical Inspection Association. These associations are independent companies that test, inspect, and certify technologies, products, and systems to ensure potential hazards and prevent damages.
GS · Germany	The GS or Geprüfte Sicherheit (tested safety) mark is a voluntary certification mark applied to finished products that signifies their compliance with all the statutory requirements of the German Product Safety Act.
UK Declaration of Conformity · United Kingdom	The UK Declaration of Conformity is a document which must be drawn up for most products lawfully bearing a UKCA marking before they are placed on the market.
EAC · Russia	Energy Attribute Certificate (EAC) are instruments used to track renewable energy consumption. Each EAC represents proof that 1 MWh of renewable energy has been produced and added to the grid.
PSE JET · Japan	The PSE Mark is a mandatory safety and EMC (Electro Magnetic Compatibility) approval for electrical products sold on the Japanese market. The applicable law is the DENAN Act (Electrical Appliance and Material Safety Act) of Japan.
CCC · China	The CCC mark is required for both Chinese-manufactured and foreign-imported products; the certification process involves the Guobiao standards.
KC · South Korea	The KC (Korea Certification) mark signifies compliance with Korea's product safety requirements for electrical and electronic equipment and is issued by Korea-based certification bodies that have been approved by the Korea Standards Association.
BIS · India	BIS Certification India or BIS Registration issued by the Bureau of Indian Standards (BIS) ensure the quality, safety and reliability of products in accordance with Indian Standards (IS).
C-Tick · Australia	C-Tick is an identification trademark registered to the ACMA, which signifies compliance with applicable EMC standard and also provides a traceable link between the equipment and the supplier.
SAA · Australia + New Zealand	Approval is accredited by the Joint Accreditation Service of Australia and New Zealand (JAS-ANZ) as a third-party certification body to issue certificates for electrical equipment that has proven to comply with the safety requirements of the applicable Australian Standard.
RCM · Australia + New Zealand	The RCM is a symbol that represents compliance with two independent schemes: EESS; and ACMA's labelling requirements. RCM certification ensures that electrical products comply with the regulatory requirements of the Australian Communications and Media Authority (ACMA).

LIGHTFASTNESS · OVERVIEW

Lightfastness is a property of a colourant such as dye or pigment that describes its resistance to fading when exposed to light.		
LIGHTFASTNESS LEVEL (BLUE WOOL SCALE)	DIRECT EXPOSURE SUMMER / WINTER	NORMAL CONDITIONS OF DISPLAY *
1	-	less than 2 years
2	-	2 - 15 years
3	4 - 8 days / 2 - 4 weeks	2 - 15 years
4	2 - 3 weeks / 2 - 3 months	15 - 50 years
5	3 - 5 weeks / 4 - 5 months	15 - 50 years
6	6 - 8 weeks / 5 - 6 months	50 - 100 years
7	3 - 4 months / 7 - 9 months	over 100 years
8	over 1.5 years	over 100 years
8+	exceeds performance of blue wool scale number 8	

molo MATERIAL LIGHTFASTNESS

COLOUR · MATERIAL	LIGHTFASTNESS LEVEL (BLUE WOOL SCALE)
1025D white textile	7

FULL FIXTURE CERTIFICATIONS

	ETL / UL / CSA · North America: All three Listed Marks—UL, CSA, and ETL—are Nationally Recognized Testing Laboratories (NRTLs) approved to perform safety testing and issue certification marks by the U.S. federal agency Occupational Safety and Health Administration (OSHA).
	CE · Europe: The CE marking is a regulatory standard that verifies certain products are safe for sale and use in the European Economic Area (EEA).
	RoHS · Europe: RoHS is an abbreviation for “Restriction of (the use of certain) Hazardous Substances”. In accordance with the European Union's RoHS directive, the restriction relates to the use of such substances in electrical and electronic equipment. Its objective is to protect human health and the environment.
	Stiftung Ear · Germany: The Electrical Act applicable in Germany provides for all manufacturers of electrical and electronic equipment who intend to distribute their products on the German market to be registered with Stiftung Elektro-Altgeräte Register (Stiftung EAR). This is designed to ensure that all distributors of electrical equipment meet their product responsibility and accept the return of the waste electrical equipment that they placed on the market

COMPATIBLE DIMMERS

All standard hardwire drivers for cloud softlight are compatible with 0 - 10V dimming systems. Below are just a few options for compatible dimmers.

North American Installations 110 - 240V and 277V input:
Wall switch option 1 · Lutron Diva Dimmer Switch for 0 - 10V LED, model DVSTV
Wall switch option 2 · Eaton Controls model DF10P-C1
Wireless dimming option 1 · Bluetooth Mesh, Sunricher model SR-BL2421-SVV

International Installations 220 - 240V input:
Wall switch · Inventronics (Osram Europe/Asia) DIM MCU G2
Wireless dimming option 1 · Bluetooth Mesh, Sunricher model SR-BL2421-SVV

CERTIFICATES

Download all certificates at <https://molodesign.com/documentation/certifications/>

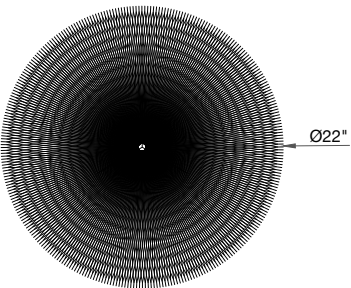

PLAN

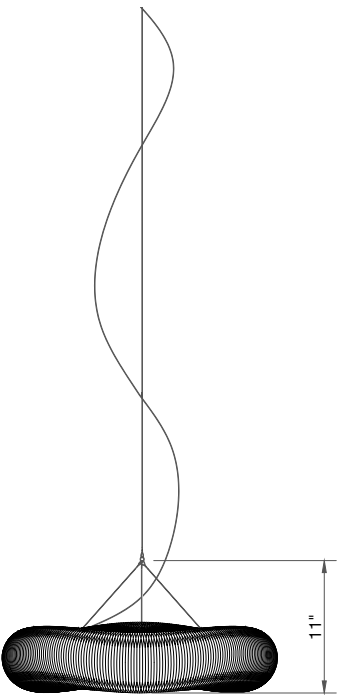

ELEVATIONS *

* once installed, the shade drapes in a manner that lends a voluminous, organic shape which appears different from each angle you observe it

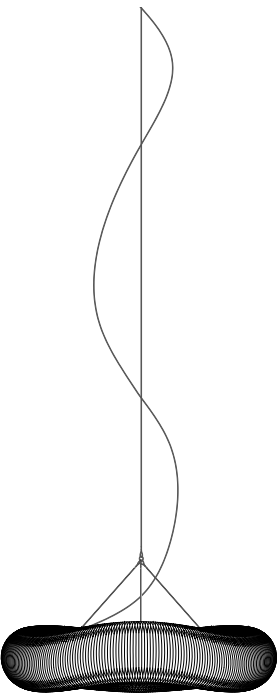
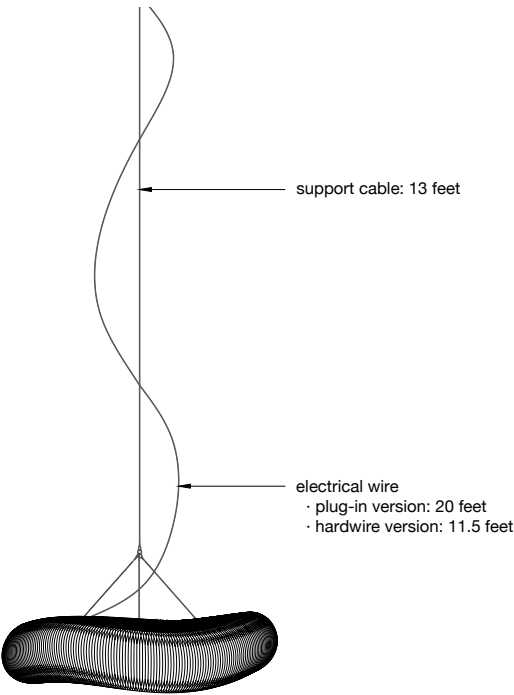

cloud softlight · small pendant		
cloud softlight shades are made from a nonwoven polyethylene textile that possesses the delicate look of Japanese washi and transmits light as a gentle glow. The material is tear- and water-resistant, UV-stable and anti-static to repel dust. The honeycomb structure of the textile shade muffles reflected sounds to improve acoustics and enhance clarity of speech.		
· 90+ CRI LED · 1.6-pound hanging weight · 10-watt power draw · plug-in: 20-foot standard length electrical wire · hardwire: 11.5-foot standard length electrical wire · custom length electrical wire and support cable available upon request		
PRODUCT	COLOUR TEMPERATURE	BRIGHTNESS
small cloud pendant · neutral white	4000K	635 lumens (average)
small cloud pendant · warm white	2700K	600 lumens (average)
INSTALLATION TYPE	ELECTRICAL SPECIFICATIONS	DRIVER + TRANSFORMER CERTIFICATIONS
PLUG-IN TRANSFORMER	· 60W 12V transformer (4 x 1 ⁷ / ₈ x 1 ¹ / ₂ ") · 110 - 240V input · type A, C, G and I AC plugs available · in-line dimmer	CCC, CE Declaration of Conformity, C-Tick, FCC, GS, PSE JET, RoHS, SAA, TÜV, UL
HARDWIRE DRIVER · ETL + INT	· 60W dimmable LED driver (7 ⁵ / ₈ x 2 ³ / ₈ x 1 ⁵ / ₈ ") · 110 - 240V + 277V input · compatible with 0 - 10V dimming system	CB Test, CCC, CE Declaration of Conformity, EMC Verification of Conformity, GlobalMark, KC, PSE JET, TÜV, UK Declaration of Conformity, UL
FULL FIXTURE CERTIFICATIONS		
CEULRoHS		

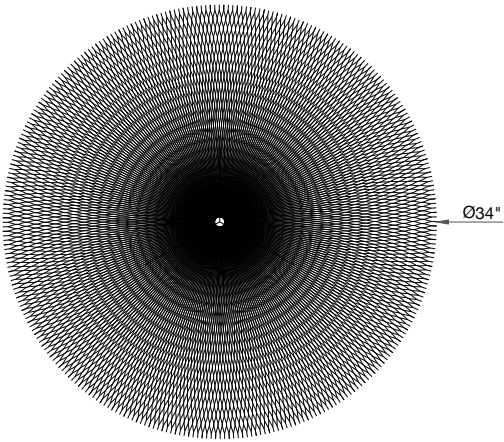

PLAN

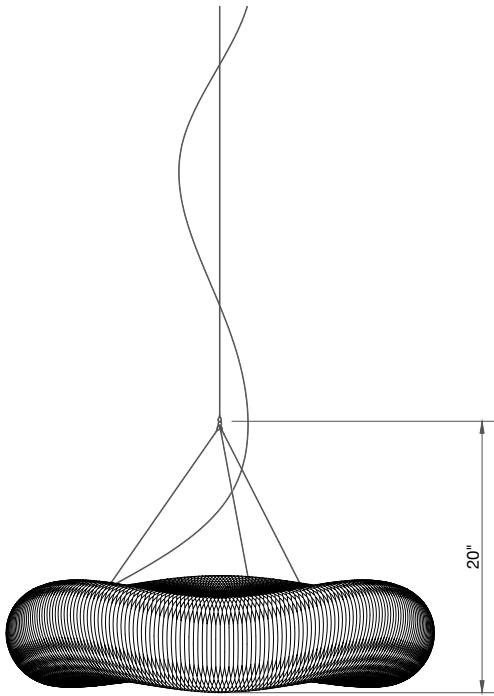

ELEVATIONS *

* once installed, the shade drapes in a manner that lends a voluminous, organic shape which appears different from each angle you observe it

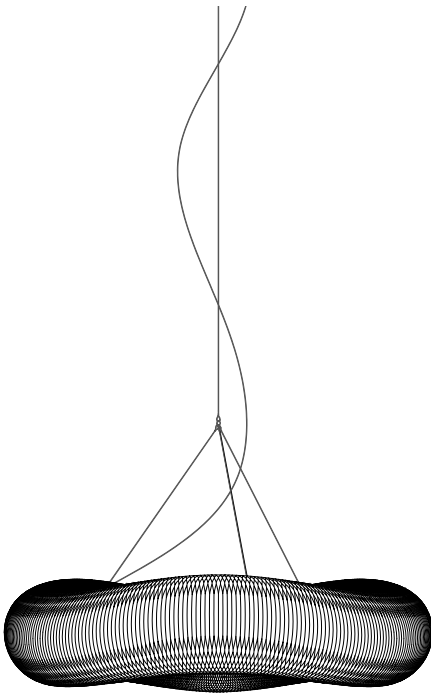
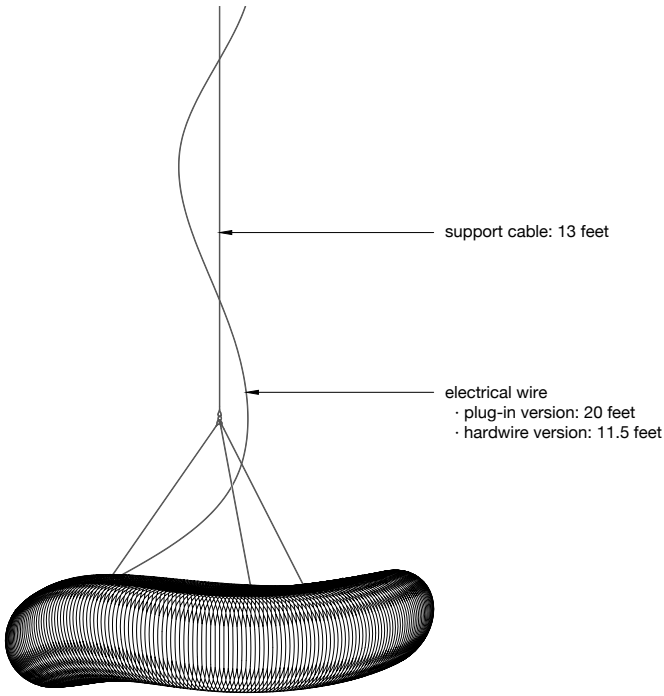

cloud softlight · medium pendant		
cloud softlight shades are made from a nonwoven polyethylene textile that possesses the delicate look of Japanese washi and transmits light as a gentle glow. The material is tear- and water-resistant, UV-stable and anti-static to repel dust. The honeycomb structure of the textile shade muffles reflected sounds to improve acoustics and enhance clarity of speech.		
· 90+ CRI LED · 3.1-pound hanging weight · 30-watt power draw · plug-in: 20-foot standard length electrical wire · hardwire: 11.5-foot standard length electrical wire · custom length electrical wire and support cable available upon request		
PRODUCT	COLOUR TEMPERATURE	BRIGHTNESS
medum cloud pendant · neutral white	4000K	1801 lumens (average)
medium cloud pendant · warm white	2700K	1808 lumens (average)
INSTALLATION TYPE	ELECTRICAL SPECIFICATIONS	DRIVER + TRANSFORMER CERTIFICATIONS
PLUG-IN TRANSFORMER	· 60W 12V transformer (4 x 1 ⁷ / ₈ x 1 ¹ / ₂ ") · 110 - 240V input · type A, C, G and I AC plugs available · in-line dimmer	CCC, CE Declaration of Conformity, C-Tick, FCC, GS, PSE JET, RoHS, SAA, TÜV, UL
HARDWIRE DRIVER · ETL + INT	· 60W dimmable LED driver (7 ⁵ / ₈ x 2 ³ / ₈ x 1 ⁵ / ₈ ") · 110 - 240V + 277V input · compatible with 0 - 10V dimming system	CB Test, CCC, CE Declaration of Conformity, EMC Verification of Conformity, GlobalMark, KC, PSE JET, TÜV, UK Declaration of Conformity, UL
FULL FIXTURE CERTIFICATIONS		
CEULRoHS		

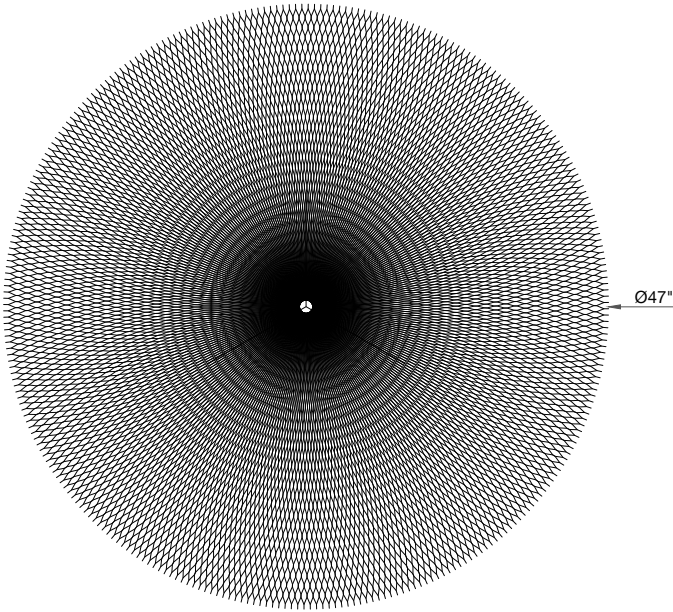

PLAN

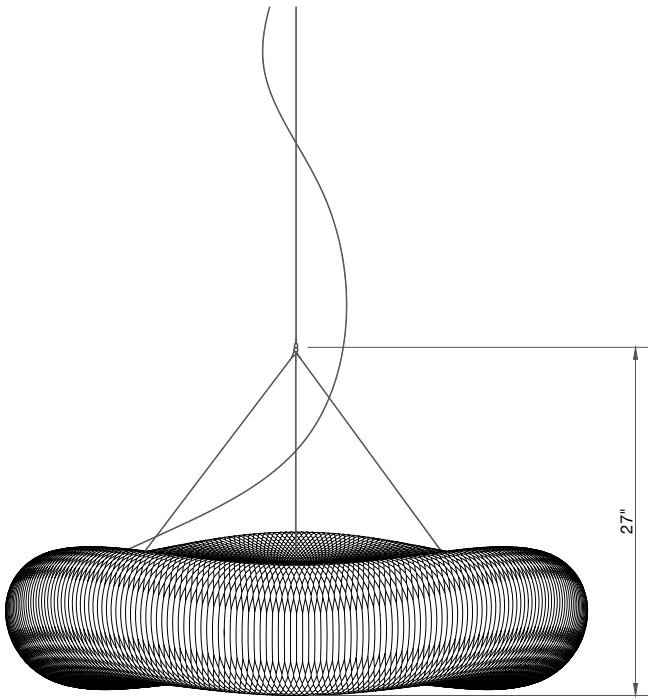

ELEVATIONS *

* once installed, the shade drapes in a manner that lends a voluminous, organic shape which appears different from each angle you observe it

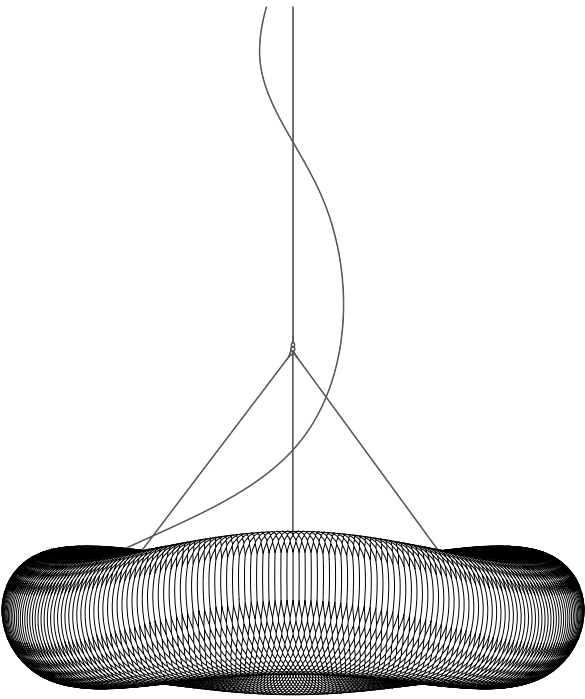
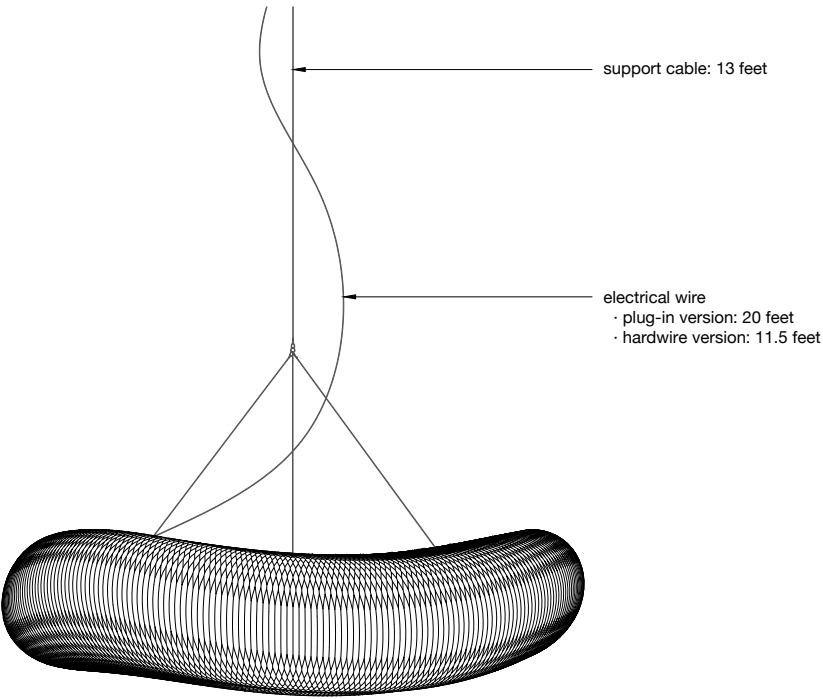

cloud softlight · large pendant		
cloud softlight shades are made from a nonwoven polyethylene textile that possesses the delicate look of Japanese washi and transmits light as a gentle glow. The material is tear- and water-resistant, UV-stable and anti-static to repel dust. The honeycomb structure of the textile shade muffles reflected sounds to improve acoustics and enhance clarity of speech.		
· 90+ CRI LED · 5.0-pound hanging weight · 44-watt power draw · plug-in: 20-foot standard length electrical wire · hardwire: 11.5-foot standard length electrical wire · custom length electrical wire and support cable available upon request		
PRODUCT	COLOUR TEMPERATURE	BRIGHTNESS
large cloud pendant · neutral white	4000K	2629 lumens (average)
large cloud pendant · warm white	2700K	2338 lumens (average)
INSTALLATION TYPE	ELECTRICAL SPECIFICATIONS	DRIVER + TRANSFORMER CERTIFICATIONS
PLUG-IN TRANSFORMER	· 60W 12V transformer (4 x 1 ⁷ / ₈ x 1 ¹ / ₂ ") · 110 - 240V input · type A, C, G and I AC plugs available · in-line dimmer	CCC, CE Declaration of Conformity, C-Tick, FCC, GS, PSE JET, RoHS, SAA, TÜV, UL
HARDWIRE DRIVER · ETL + INT	· 60W dimmable LED driver (7 ⁵ / ₈ x 2 ³ / ₈ x 1 ⁵ / ₈ ") · 110 - 240V + 277V input · compatible with 0 - 10V dimming system	CB Test, CCC, CE Declaration of Conformity, EMC Verification of Conformity, GlobalMark, KC, PSE JET, TÜV, UK Declaration of Conformity, UL
FULL FIXTURE CERTIFICATIONS		
CEULRoHS		

This drawing and the content represented is the exclusive property of molo design ltd. and cannot be used without their prior written consent. For site installations verify all dimensions and notify molo of any on-site discrepancies prior to construction. Drawing scale may be affected by printing, scanning, or copy-ing. Do not scale drawings.



molo design, ltd.
1470 Venables Street
Vancouver, BC
Canada V5L 2G7

+ 1 604 685 0340
molodesign.com

Designed by Stephanie Forsythe and Todd MacAllen,
manufactured by molo and protected by one or more patents and/or design registrations held by molo, viewable at molodesign.com/ip

cloud softlight · large pendant · 12V SPECIFICATIONS
SCALE · 1:15

DATE: 260114

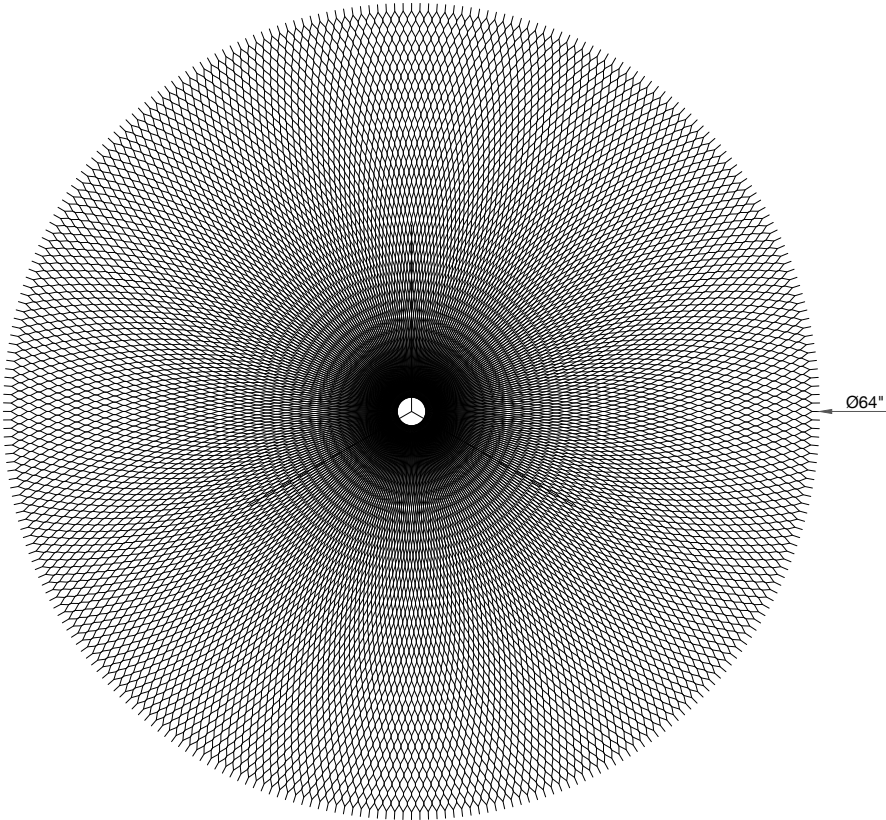

PLAN

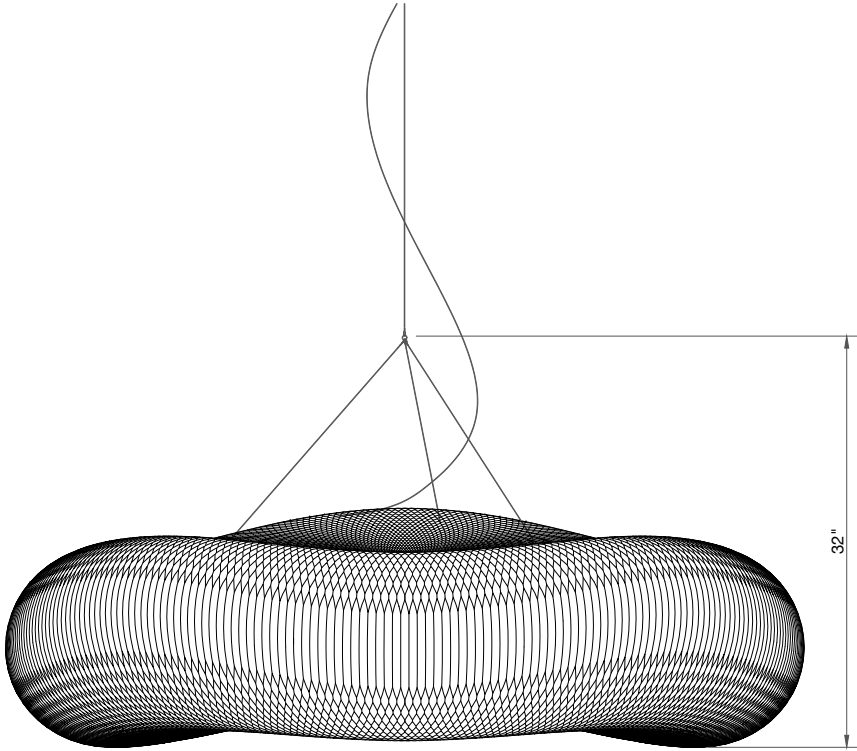

ELEVATIONS *

* once installed, the shade drapes in a manner that lends a voluminous, organic shape which appears different from each angle you observe it

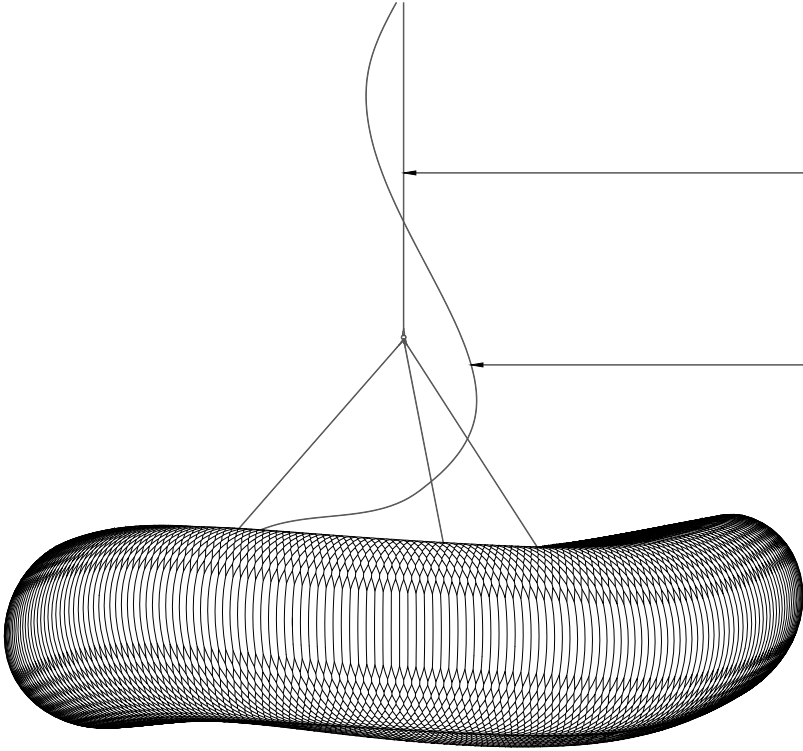

support cable: 13 feet

electrical wire
· plug-in version: 20 feet
· hardwire version: 11.5 feet

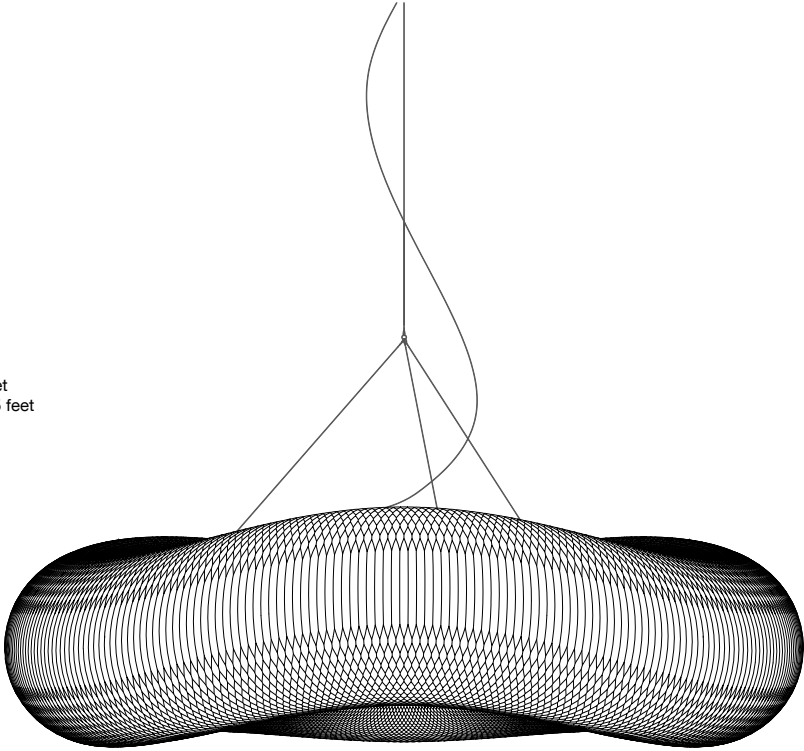

cloud softlight · x-large pendant		
cloud softlight shades are made from a nonwoven polyethylene textile that possesses the delicate look of Japanese washi and transmits light as a gentle glow. The material is tear- and water-resistant, UV-stable and anti-static to repel dust. The honeycomb structure of the textile shade muffles reflected sounds to improve acoustics and enhance clarity of speech.		
· 90+ CRI LED · 10.1-pound hanging weight · 54-watt power draw · plug-in: 20-foot standard length electrical wire · hardwire: 11.5-foot standard length electrical wire · custom length electrical wire and support cable available upon request		
PRODUCT	COLOUR TEMPERATURE	BRIGHTNESS
x-large cloud pendant · neutral white	4000K	3042 lumens (average)
x-large cloud pendant · warm white	2700K	2861 lumens (average)
INSTALLATION TYPE	ELECTRICAL SPECIFICATIONS	DRIVER + TRANSFORMER CERTIFICATIONS
PLUG-IN TRANSFORMER	· 60W 12V transformer (4 x 1 ⁵ / ₈ x 1 ¹ / ₂ ") · 110 - 240V input · type A, C, G and I AC plugs available · in-line dimmer	CCC, CE Declaration of Conformity, C-Tick, FCC, GS, PSE JET, RoHS, SAA, TÜV, UL
HARDWIRE DRIVER · ETL + INT	· 60W dimmable LED driver (7 ⁵ / ₈ x 2 ³ / ₈ x 1 ⁵ / ₈ ") · 110 - 240V + 277V input · compatible with 0 - 10V dimming system	CB Test, CCC, CE Declaration of Conformity, EMC Verification of Conformity, GlobalMark, KC, PSE JET, TÜV, UK Declaration of Conformity, UL
FULL FIXTURE CERTIFICATIONS		
CEULRoHS		

This drawing and the content represented is the exclusive property of molo design ltd. and cannot be used without their prior written consent. For site installations verify all dimensions and notify molo of any on-site discrepancies prior to construction. Drawing scale may be affected by printing, scanning, or copying. Do not scale drawings.



molo design, ltd.
1470 Venables Street
Vancouver, BC
Canada V5L 2G7

+ 1 604 685 0340
molodesign.com

Designed by Stephanie Forsythe and Todd MacAllen,
manufactured by molo and protected by one or more patents and/or design registrations held by molo, viewable at molodesign.com/ip

cloud softlight · x-large pendant · 12V SPECIFICATIONS
SCALE · 1:15

DATE: 260114

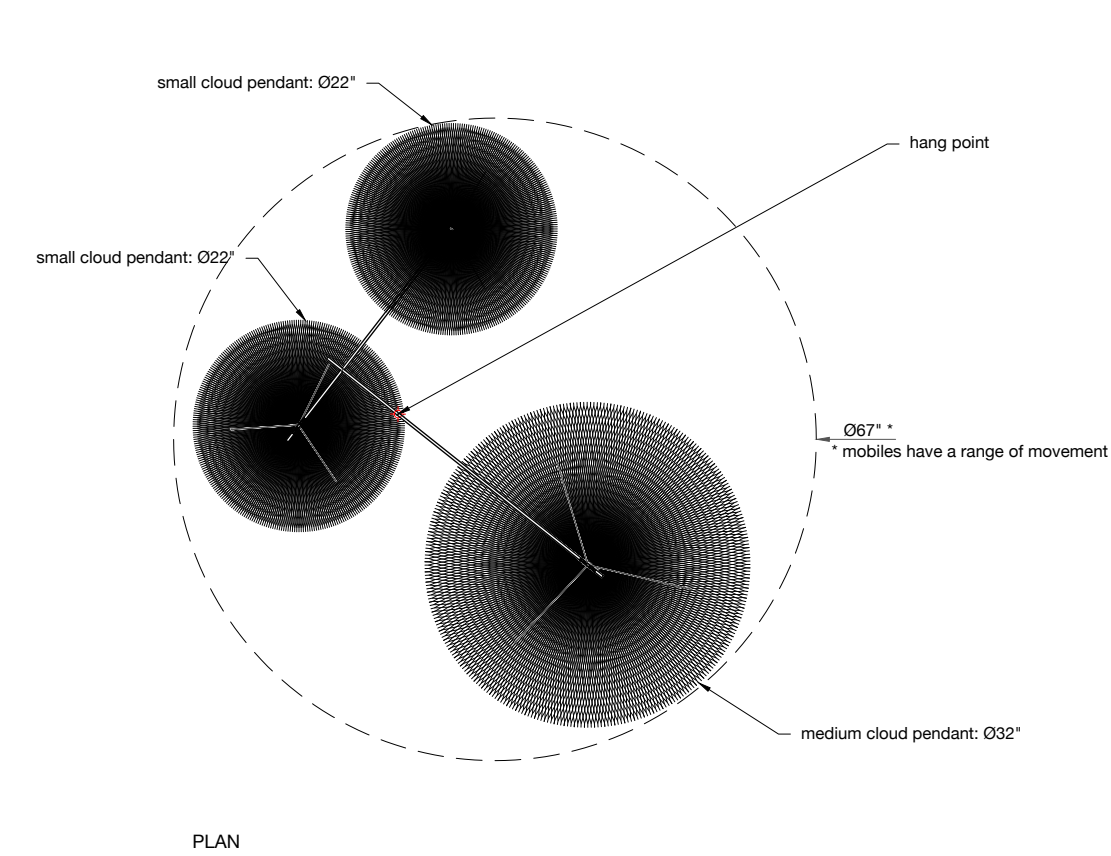

PLAN

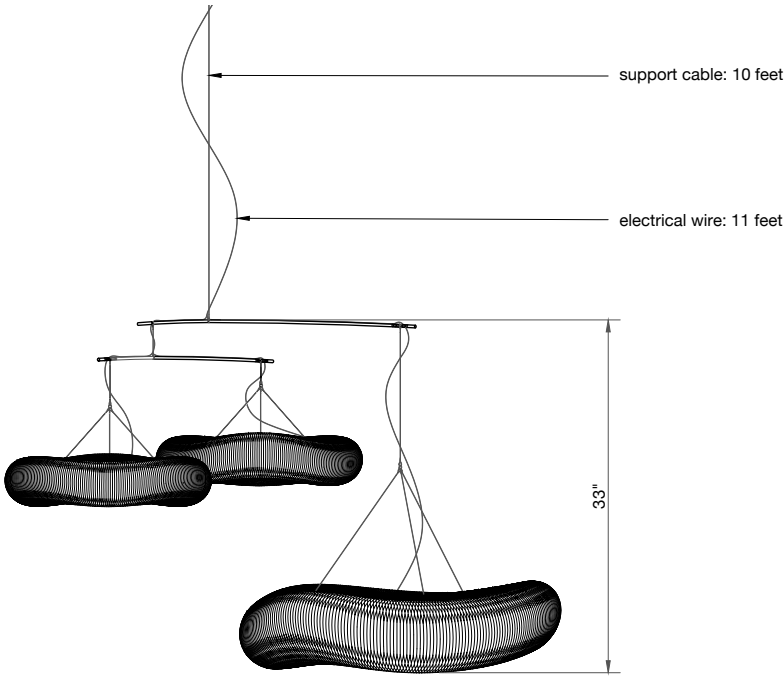

ELEVATION

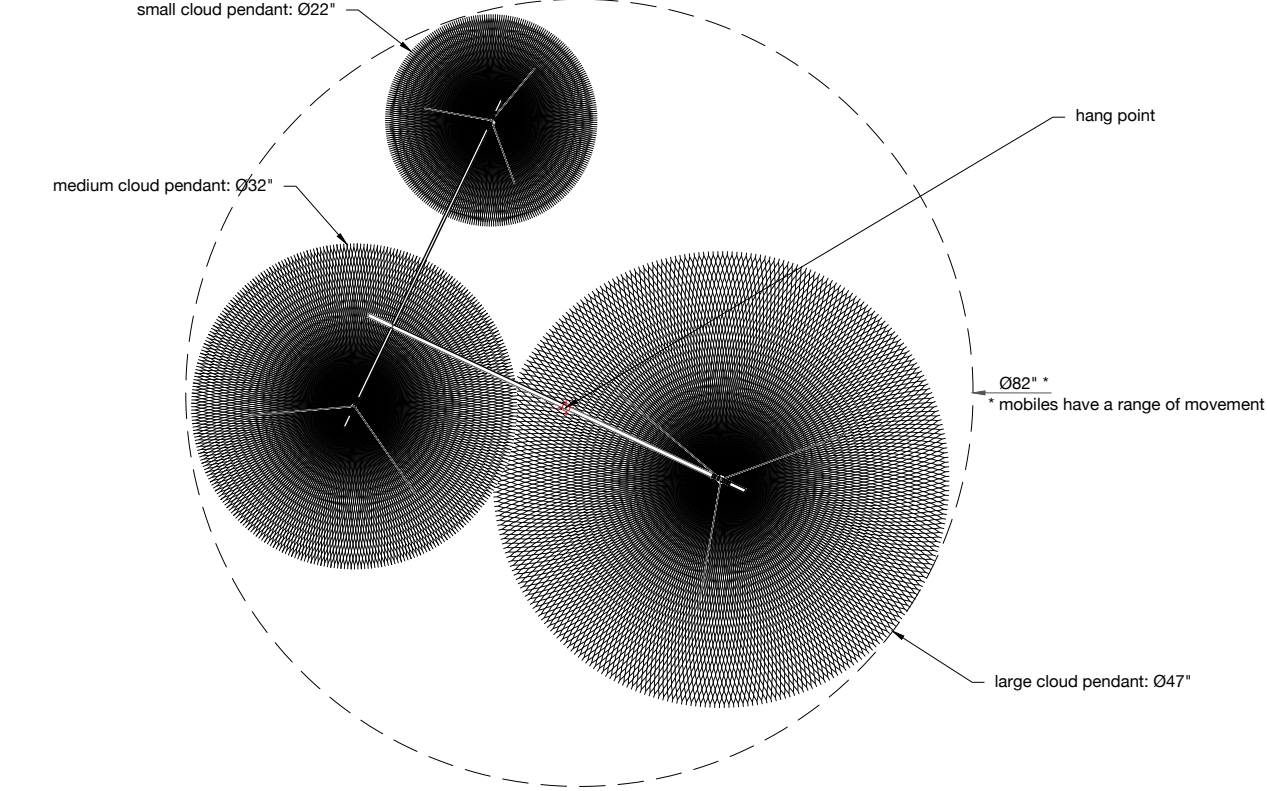

cloud softlight · small mobile		
Inspired by Alexander Calder’s marvellous kinetic sculptures, cloud softlight mobile paper lamp redefines space through gentle movement and an intimate sense of enclosure. Each cloud lamp attaches to the mobile structure by a single point, softly bobbing and revolving with shifting air currents. cloud softlight shades are made from a nonwoven polyethylene textile that possesses the delicate look of Japanese washi and transmits light as gentle glow. The material is tear- and water-resistant, UV-stable and anti-static to repel dust. The honeycomb structure of the textile shade muffles reflected sounds to improve acoustics and enhance clarity of speech.		
· 90+ CRI LED · includes: 2 small pendants + 1 medium pendant · 9.7-pound hanging weight · 49-watt power draw · 11-foot standard length electrical wire for plug-in and hardwire mobiles · custom length electrical wire and support cable available upon request		
PRODUCT	COLOUR TEMPERATURE	BRIGHTNESS
small cloud mobile · neutral white	4000K	3070 lumens (average)
small cloud mobile · warm white	2700K	3009 lumens (average)
INSTALLATION TYPE	ELECTRICAL SPECIFICATIONS	DRIVER + TRANSFORMER CERTIFICATIONS
PLUG-IN TRANSFORMER	· 60W 12V transformer (4 x 1 ⁷ / ₈ x 1 ¹ / ₂ ") · 110 - 240V input · type A, C, G and I AC plugs available	CCC, CE Declaration of Conformity, C-Tick, FCC, GS, PSE JET, RoHS, SAA, TÜV, UL
HARDWIRE DRIVER · ETL + INT	· 60W dimmable LED driver (7 ⁵ / ₈ x 2 ³ / ₈ x 1 ⁵ / ₈ ") · 110 - 240V + 277V input · compatible with 0 - 10V dimming system	CB Test, CCC, CE Declaration of Conformity, EMC Verification of Conformity, GlobalMark, KC, PSE JET, TÜV, UK Declaration of Conformity, UL
FULL FIXTURE CERTIFICATIONS		
<div>CEULRoHS</div>		

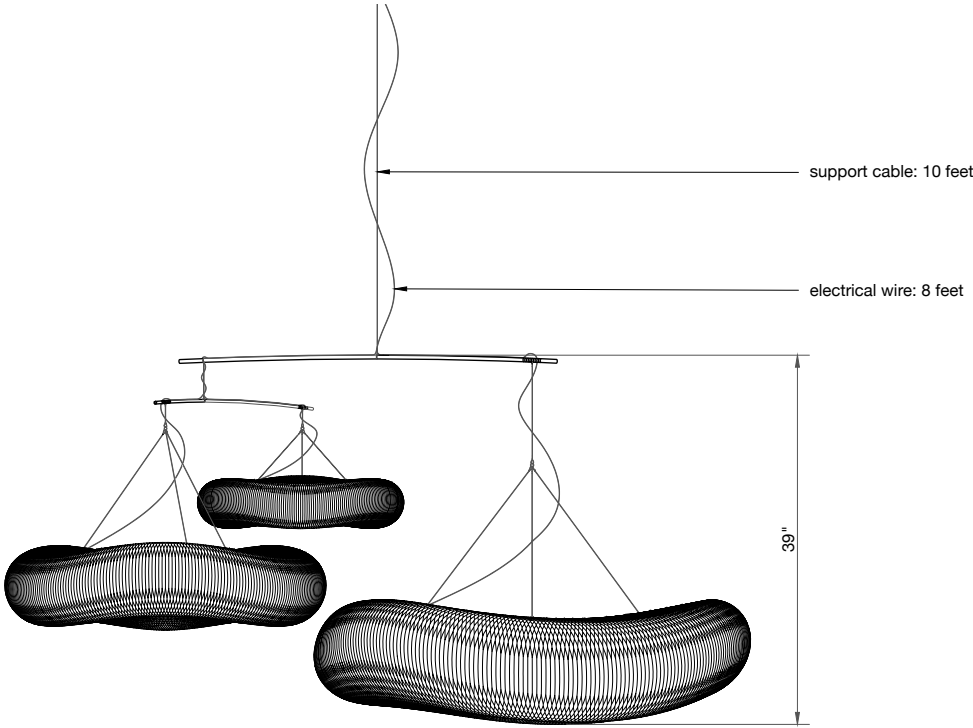

PLAN



ELEVATION

cloud softlight · medium mobile		
Inspired by Alexander Calder’s marvellous kinetic sculptures, cloud softlight mobile paper lamp redefines space through gentle movement and an intimate sense of enclosure. Each cloud lamp attaches to the mobile structure by a single point, softly bobbing and revolving with shifting air currents. cloud softlight shades are made from a nonwoven polyethylene textile that possesses the delicate look of Japanese washi and transmits light as gentle glow. The material is tear- and water-resistant, UV-stable and anti-static to repel dust. The honeycomb structure of the textile shade muffles reflected sounds to improve acoustics and enhance clarity of speech.		
· 90+ CRI LED · includes: 1 small, 1 medium and 1 large pendant · 13.7-pound hanging weight · 83-watt power draw · 8-foot standard length electrical wire for plug-in and hardwire mobiles · custom length electrical wire and support cable available upon request		
PRODUCT	COLOUR TEMPERATURE	BRIGHTNESS
medium cloud mobile · neutral white	4000K	5064 lumens (average)
medum cloud mobile · warm white	2700K	4747 lumens (average)
INSTALLATION TYPE	ELECTRICAL SPECIFICATIONS	DRIVER + TRANSFORMER CERTIFICATIONS
PLUG-IN TRANSFORMER	· 60W 12V transformer (4 x 1 $\frac{1}{8}$ x 1 $\frac{1}{2}$ ") · 110 - 240V input · type A, C, G and I AC plugs available	CCC, CE Declaration of Conformity, C-Tick, FCC, GS, PSE JET, RoHS, SAA, TÜV, UL
HARDWIRE DRIVER · ETL	· 3x 60W dimmable LED driver (7 $\frac{7}{8}$ x 2 $\frac{3}{8}$ x 1 $\frac{5}{8}$ ") · 110 - 240V + 277V input · compatible with 0 - 10V dimming system	CB Test, CCC, CE Declaration of Conformity, EMC Verification of Conformity, GlobalMark, KC, PSE JET, TÜV, UK Declaration of Conformity, UL
HARDWIRE DRIVER · INT	· 150W dimmable LED driver (7 $\frac{7}{8}$ x 2 $\frac{1}{2}$ x 1 $\frac{5}{8}$ ") · 110 - 240V + 277V input · compatible with 0 - 10V dimming system	BIS, CB Test, CCC, CE Declaration of Conformity, EAC, EMC Verification of Conformity, GlobalMark, KC, PSE JET, TÜV, UK Declaration of Conformity, UL
FULL FIXTURE CERTIFICATIONS		
<div>CE</div> <div></div> <div></div> <div>RoHS</div>		

This drawing and the content represented is the exclusive property of molo design ltd. and cannot be used without their prior written consent. For site installations verify all dimensions and notify molo of any on-site discrepancies prior to construction. Drawing scale may be affected by printing, scanning, or copy-ing. Do not scale drawings.



molo design, ltd.
1470 Venables Street
Vancouver, BC
Canada V5L 2G7

+ 1 604 685 0340
molodesign.com

Designed by Stephanie Forsythe and Todd MacAllen,
manufactured by molo and protected by one or more patents and/or design registrations held by molo, viewable at molodesign.com/ip

cloud softlight · medium mobile · 12V SPECIFICATIONS
SCALE · 1:20

DATE: 260114

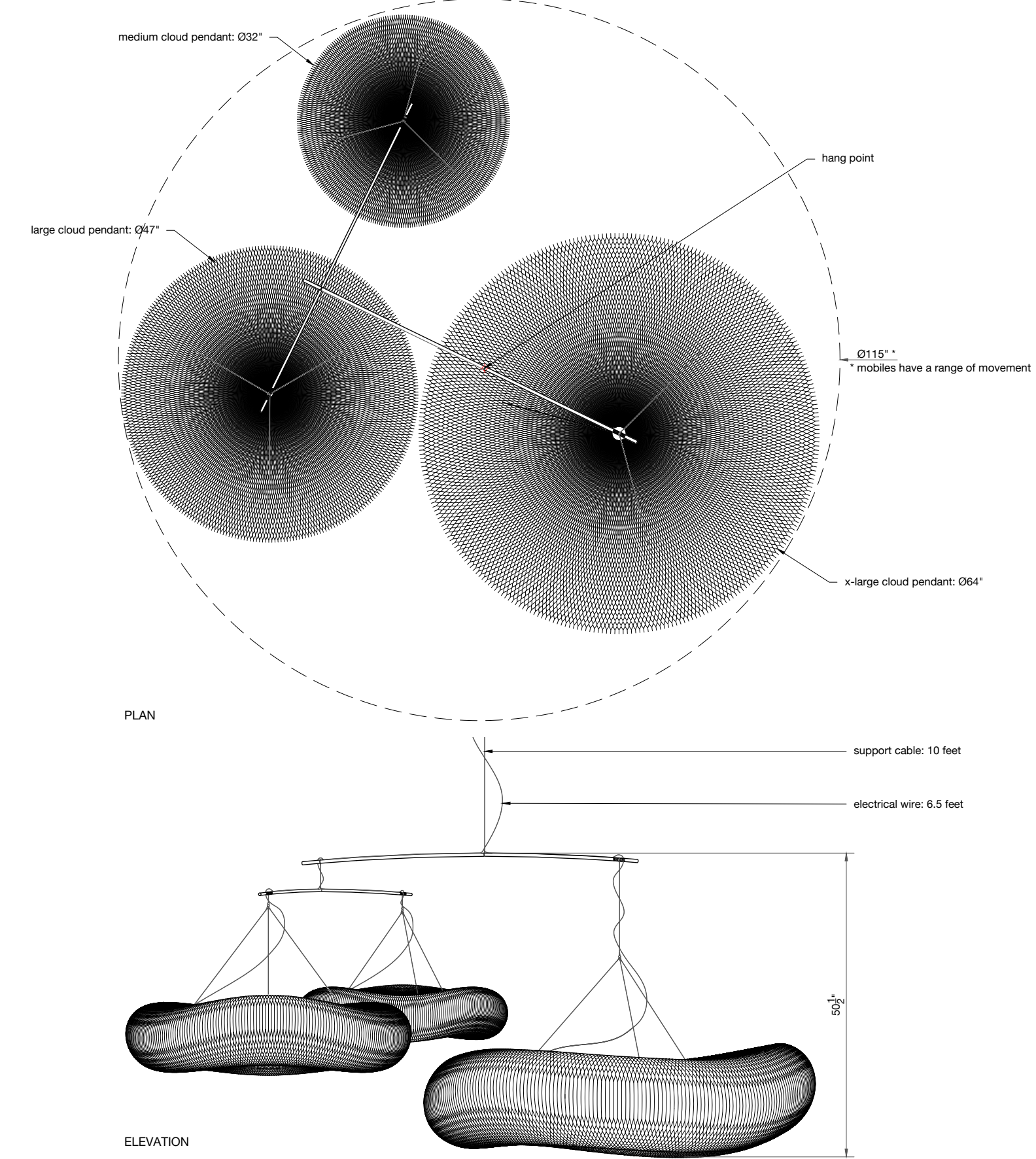

cloud softlight · large mobile		
Inspired by Alexander Calder’s marvellous kinetic sculptures, cloud softlight mobile paper lamp redefines space through gentle movement and an intimate sense of enclosure. Each cloud lamp attaches to the mobile structure by a single point, softly bobbing and revolving with shifting air currents. cloud softlight shades are made from a nonwoven polyethylene textile that possesses the delicate look of Japanese washi and transmits light as gentle glow. The material is tear- and water-resistant, UV-stable and anti-static to repel dust. The honeycomb structure of the textile shade muffles reflected sounds to improve acoustics and enhance clarity of speech.		
· 90+ CRI LED · includes: 1 medium, 1 large and 1 x-large pendant · 25.5-pound hanging weight · 126-watt power draw · 6-foot standard length electrical wire for plug-in and hardwire mobiles · custom length electrical wire and support cable available upon request		
PRODUCT	COLOUR TEMPERATURE	BRIGHTNESS
large cloud mobile · neutral white	4000K	7472 lumens (average)
large cloud mobile · warm white	2700K	7008 lumens (average)
INSTALLATION TYPE	ELECTRICAL SPECIFICATIONS	DRIVER + TRANSFORMER CERTIFICATIONS
PLUG-IN TRANSFORMER	· 150W transformer (7 x 2 ³ / ₄ x 1 ⁵ / ₈ ") · 110 - 240V input · type B and E/F AC plugs available	CCC, CE Declaration of Conformity, PSE JET, RoHS, UL
HARDWIRE DRIVER · ETL	· 3x 60W dimmable LED driver (7 ⁷ / ₈ x 2 ³ / ₈ x 1 ⁵ / ₈ ") · 110 - 240V + 277V input · compatible with 0 - 10V dimming system	CB Test, CCC, CE Declaration of Conformity, EMC Verification of Conformity, GlobalMark, KC, PSE JET, TÜV, UK Declaration of Conformity, UL
HARDWIRE DRIVER · INT	· 150W dimmable LED driver (7 ⁷ / ₈ x 2 ¹ / ₂ x 1 ⁵ / ₈ ") · 110 - 240V + 277V input · compatible with 0 - 10V dimming system	BIS, CB Test, CCC, CE Declaration of Conformity, EAC, EMC Verification of Conformity, GlobalMark, KC, PSE JET, TÜV, UK Declaration of Conformity, UL
FULL FIXTURE CERTIFICATIONS		
CEULRoHS		

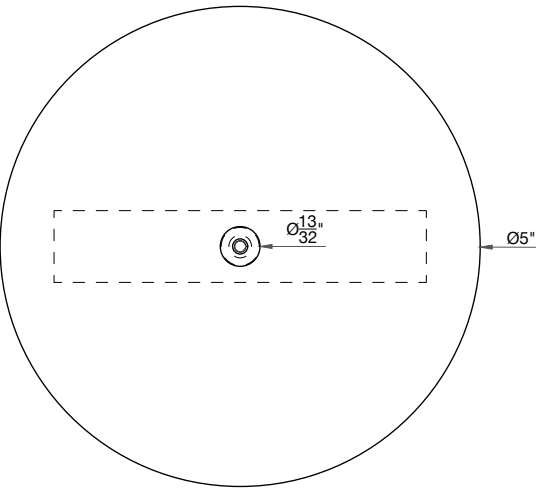

PLAN

cloud softlight mobile canopy plate has a second hole to accommodate the mobile armature power wire

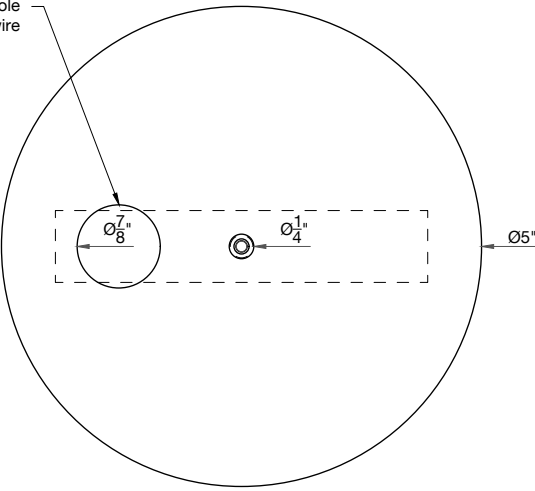

PLAN

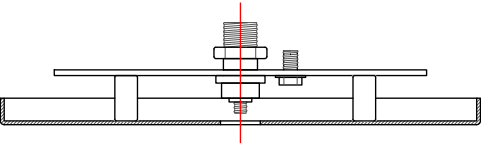

ELEVATION
OPTION A · HANG KIT · cloud softlight pendant

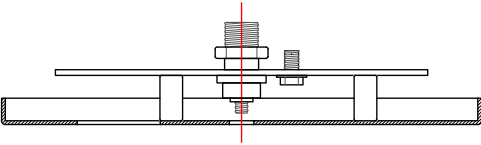

ELEVATION
OPTION A · HANG KIT · cloud softlight mobile

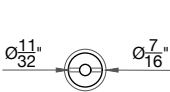

PLAN

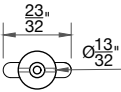

PLAN

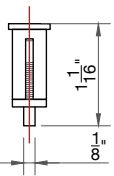

ELEVATION
OPTION B · SIDE EXIT GRIPPER

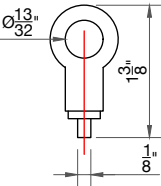

ELEVATION
OPTION C · GRIPPER RING

cloud softlight · MOUNTING METHODS		
cloud softlight pendants and mobiles are provided with multiple options for mounting methods.		
INSTALLATION TYPE	PRODUCT	PRODUCT CODE
OPTION A · HANG KIT · cloud softlight pendant	P-softlight · canopy plate, white, 5" Ø, 1 hole	P-SL-CNYP-WH-5-1H
	P-softlight · bracket bar, for 4" junction box	P-SL-BKTBR
	P-cloud light · support cable, 3/64" Ø, 4m long	P-CLD-CBL-364-4
	P-magnet · rod, 13mm long, 6mm Ø	P-MGNT-ROD-13-06
	P-softlight · lock nut for 3/64 aircraft cable gripper	P-SL-GRIP-NUT
	P-softlight · threaded gripper for 3/64" cable	P-SL-GRIP-THRD-364
OPTION A · HANG KIT · cloud softlight mobile	P-softlight · canopy plate, white, 5" Ø, 2 holes	P-SL-CNYP-WH-5-2H
	P-softlight · bracket bar, for 4" junction box	P-SL-BKTBR
	P-cloud light · support cable, 3/64" Ø, 4m long	P-CLD-CBL-364-4
	P-magnet · rod, 13mm long, 6mm Ø	P-MGNT-ROD-13-06
	P-softlight · lock nut for 3/64 aircraft cable gripper	P-SL-GRIP-NUT
	P-softlight · threaded gripper for 3/64" cable	P-SL-GRIP-THRD-364
OPTION B · SIDE EXIT GRIPPER	P-softlight · gripper, side exit model	P-SL-GRIP
	P-cloud light · support cable, 3/64" Ø, 4m long	P-CLD-CBL-364-4
OPTION C · GRIPPER RING	P-cloud light · gripper, ring, for 3/64" cable	P-CLD-GRIP-RING-364
	P-cloud light · support cable, 3/64" Ø, 4m long	P-CLD-CBL-364-4
FULL FIXTURE CERTIFICATIONS		
<div>CEULRoHS</div>		

cloud softlight · HARDWARE INSTALLATION

Hardwire-type clouds require a qualified electrician to connect cloud directly to a building's electrical wiring via. a ceiling junction box. Each hardwire cloud comes with a dimmable driver (option of 1 – 10V or DALI-compatible) that mounts behind the junction box or in a concealed location. A pendant hang kit, consisting of a canopy plate, bracket bar and support cable is included as the standard method to mount cloud pendant. Adjustable "ring type cable gripper" or "side exit cable gripper" are also available as an alternate mounting system; see drawing on page 09 for cable gripper dimensions.

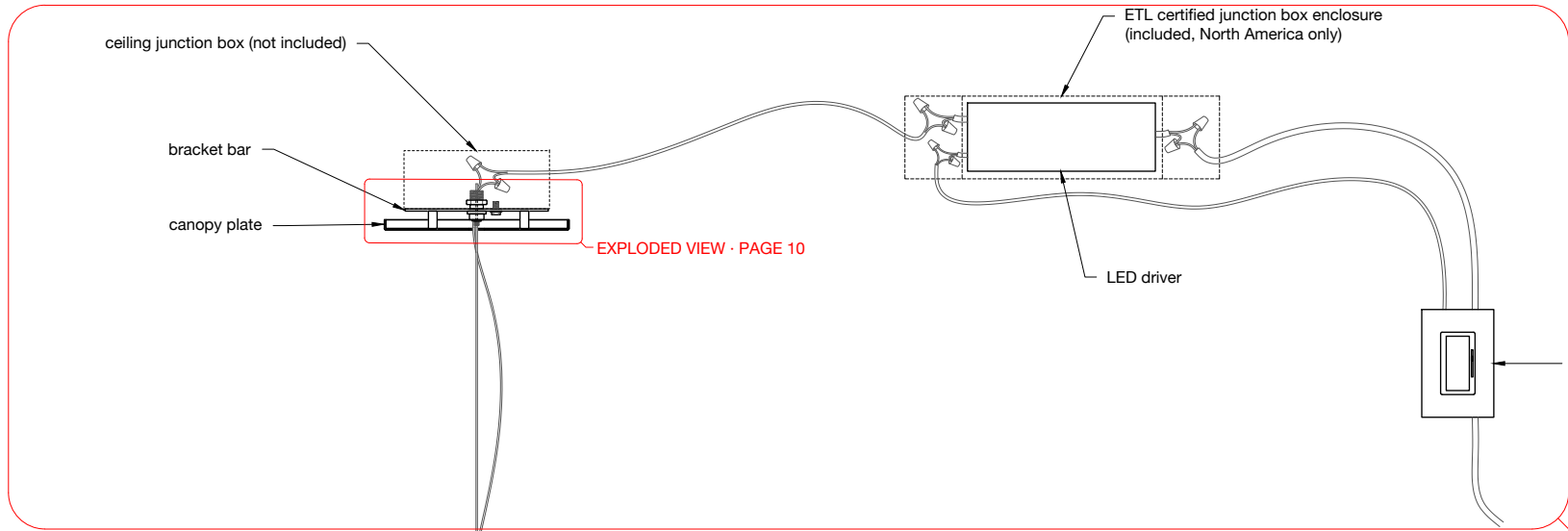

bracket bar screws in to ceiling junction box *
* ceiling junction box is not supplied; installed junction box must support weight of the individual pendant

rod magnets hold canopy plate onto bracket bar

canopy plate conceals hardware

EXPLODED VIEW · CANOPY PLATE + BRACKET BAR
SCALE · 1:1

ELEVATION
SCALE · 1:5

This drawing and the content represented is the exclusive property of molo design ltd. and cannot be used without their prior written consent. For site installations verify all dimensions and notify molo of any on-site discrepancies prior to construction. Drawing scale may be affected by printing, scanning, or copying. Do not scale drawings.



molo design, ltd.
1470 Venables Street
Vancouver, BC
Canada V5L 2G7

+ 1 604 685 0340
molodesign.com

Designed by Stephanie Forsythe and Todd MacAllen,
manufactured by molo and protected by one or more patents and/or design registrations held by molo, viewable at molodesign.com/ip

cloud softlight · 12V HARDWARE SPECIFICATIONS
SCALE · AS NOTED

DATE: 260114

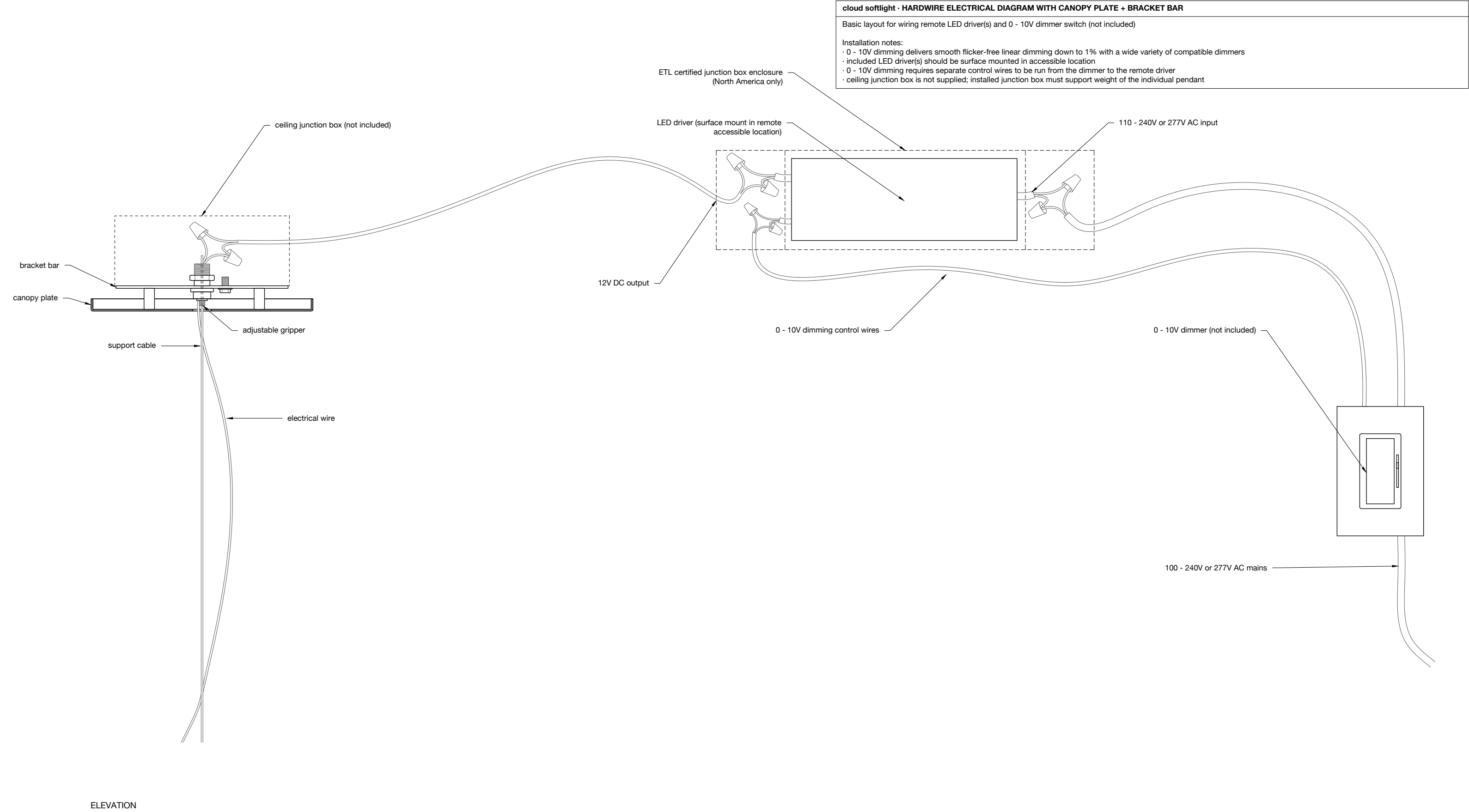

cloud softlight · HARDWIRE ELECTRICAL DIAGRAM WITH SIDE EXIT GRIPPER

Basic layout for wiring remote LED driver(s) and 0 - 10V dimmer switch (not included)

Installation notes:

- 0 - 10V dimming delivers smooth flicker-free linear dimming down to 1% with a wide variety of compatible dimmers
- included LED driver(s) should be surface mounted in accessible location
- 0 - 10V dimming requires separate control wires to be run from the dimmer to the remote driver
- ceiling junction box is not supplied; installed junction box must support weight of the individual pendant

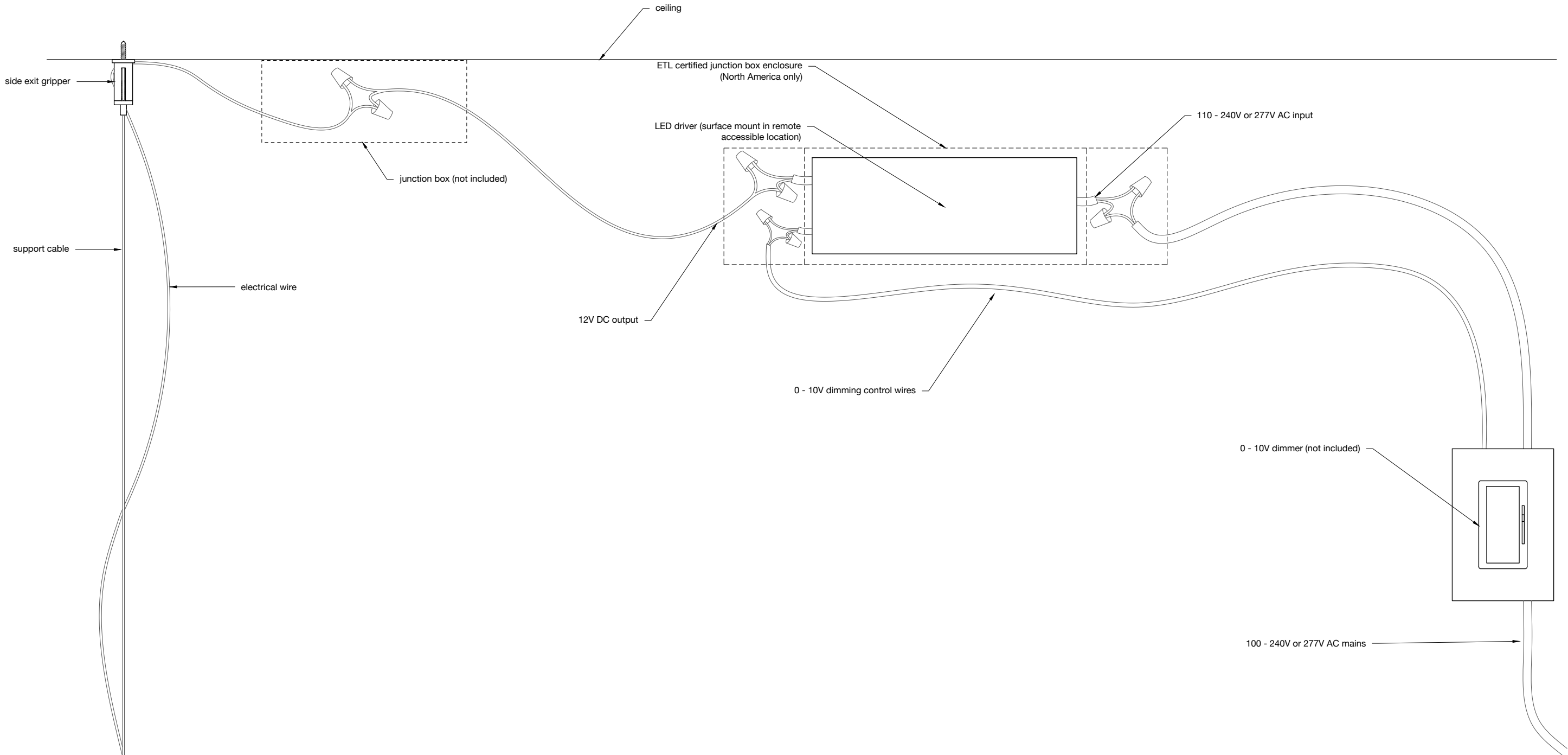

ELEVATION

This drawing and the content represented is the exclusive property of molo design ltd. and cannot be used without their prior written consent. For site installations verify all dimensions and notify molo of any on-site discrepancies prior to construction. Drawing scale may be affected by printing, scanning, or copying. Do not scale drawings.



molo design, ltd.
1470 Venables Street
Vancouver, BC
Canada V5L 2G7

+ 1 604 685 0340
molodesign.com

Designed by Stephanie Forsythe and Todd MacAllen,
manufactured by molo and protected by one or more patents and/or design registrations held by molo, viewable at molodesign.com/ip

cloud softlight · 12V HARDWIRE ELECTRICAL DIAGRAM
SCALE · 1:2

DATE: 260114

11.B

cloud softlight · HARDWIRE ELECTRICAL DIAGRAM WITH GRIPPER RING

Basic layout for wiring remote LED driver(s) and 0 - 10V dimmer switch (not included)

Installation notes:

- 0 - 10V dimming delivers smooth flicker-free linear dimming down to 1% with a wide variety of compatible dimmers
- included LED driver(s) should be surface mounted in accessible location
- 0 - 10V dimming requires separate control wires to be run from the dimmer to the remote driver
- ceiling junction box is not supplied; installed junction box must support weight of the individual pendant

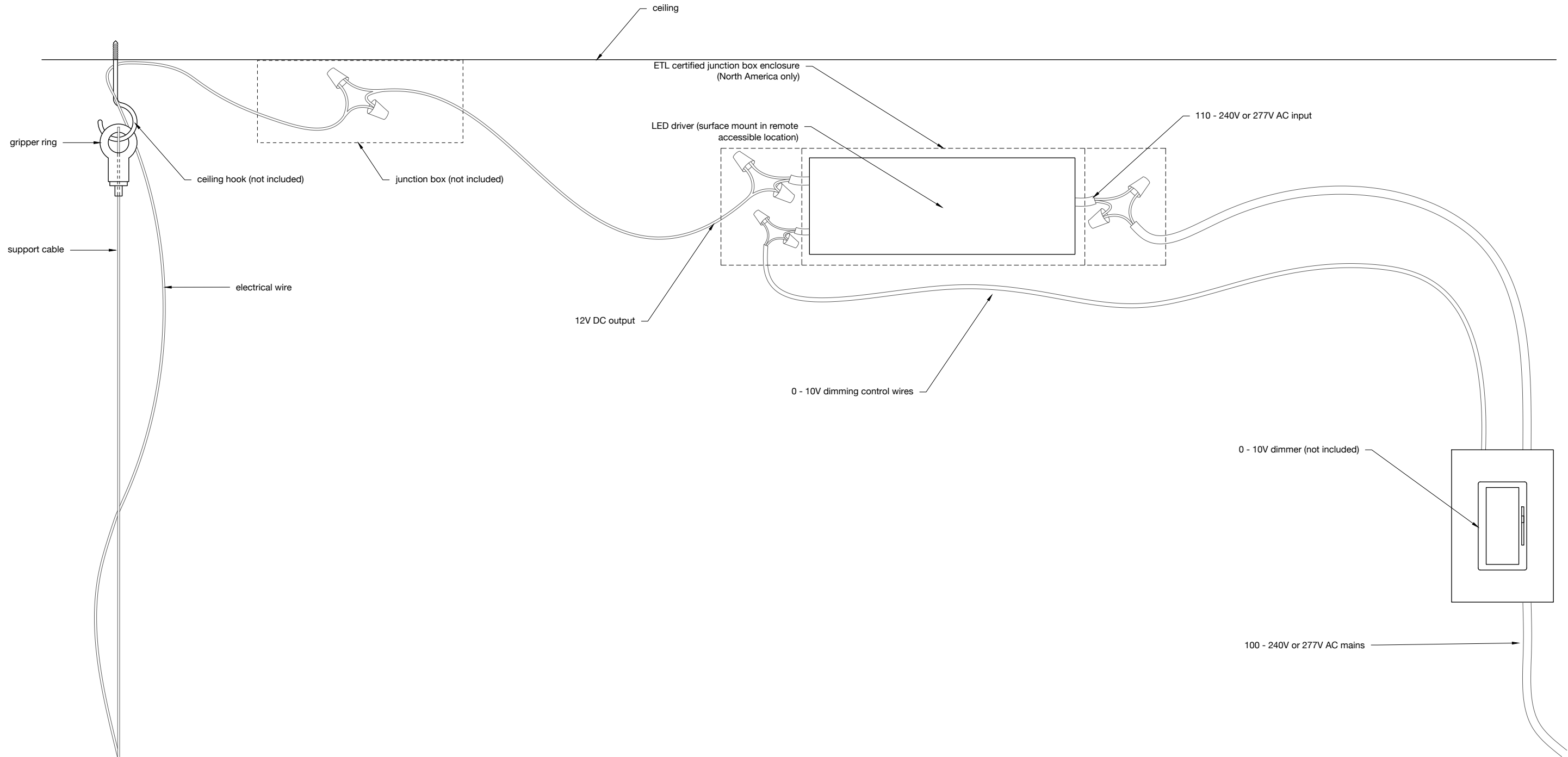

ELEVATION

This drawing and the content represented is the exclusive property of molo design ltd. and cannot be used without their prior written consent. For site installations verify all dimensions and notify molo of any on-site discrepancies prior to construction. Drawing scale may be affected by printing, scanning, or copying. Do not scale drawings.



molo design, ltd.
1470 Venables Street
Vancouver, BC
Canada V5L 2G7

+ 1 604 685 0340
molodesign.com

Designed by Stephanie Forsythe and Todd MacAllen,
manufactured by molo and protected by one or more patents and/or design registrations held by molo, viewable at molodesign.com/ip

cloud softlight · 12V HARDWIRE ELECTRICAL DIAGRAM
SCALE · 1:2

DATE: 260114

11.C

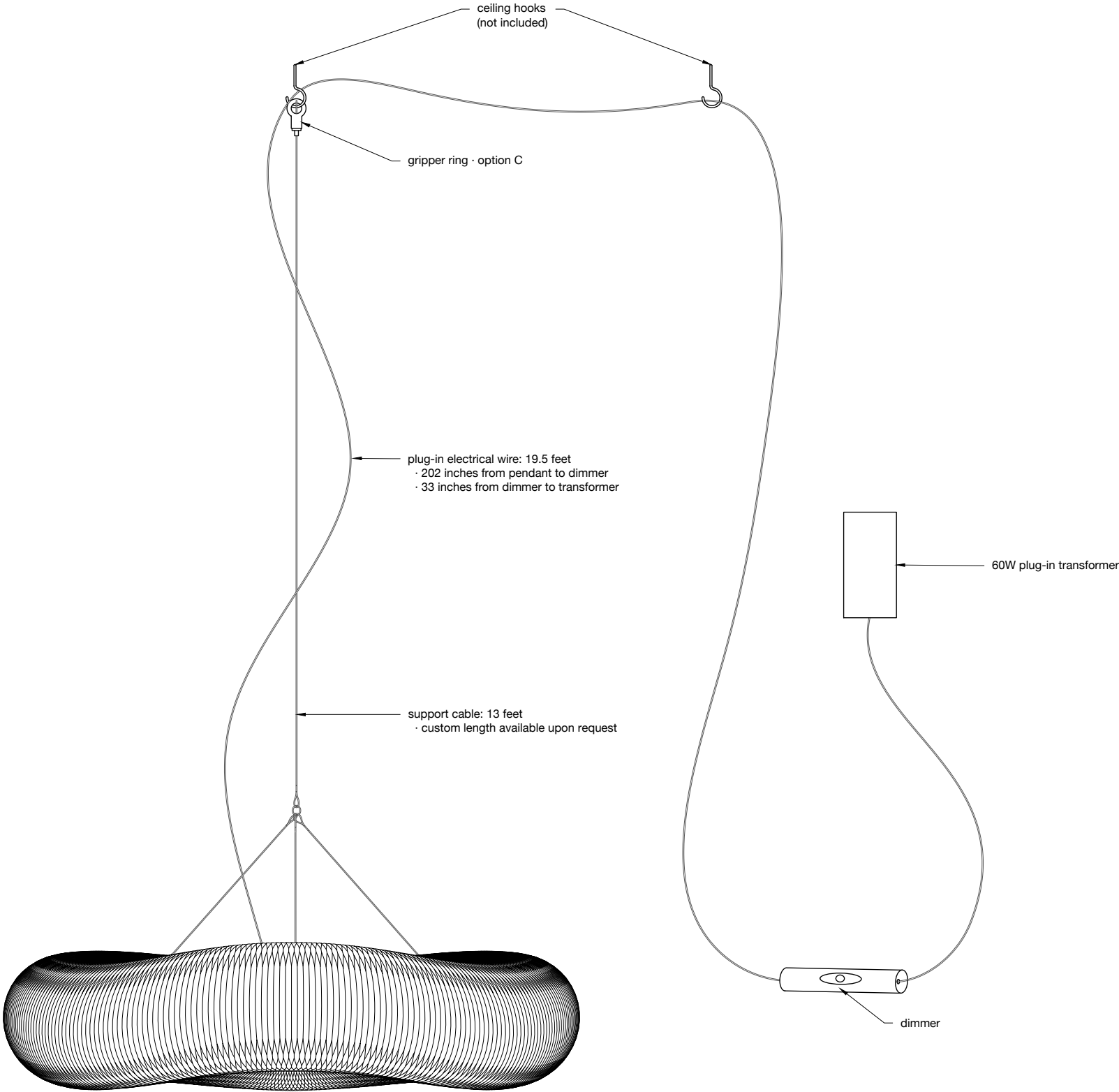

ELEVATION
SCALE · 1:5

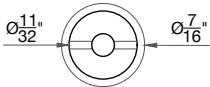

PLAN · OPTION B · SIDE EXIT GRIPPER
SCALE · 1:1

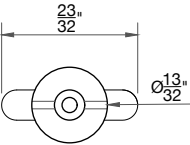

PLAN · OPTION C · GRIPPER RING
SCALE · 1:1

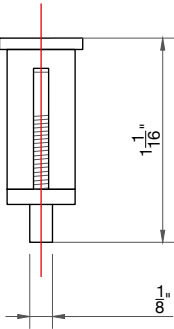

ELEVATION · OPTION B · SIDE EXIT GRIPPER
SCALE · 1:1

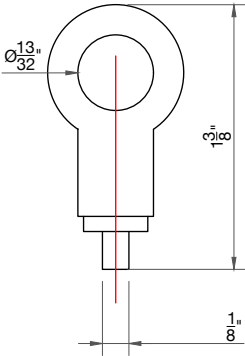

ELEVATION · OPTION C · GRIPPER RING
SCALE · 1:1

cloud softlight · plug-in pendant

Plug-in type cloud softlight may be plugged into a standard wall outlet and works internationally with 100 – 240 VAC. An adjustable ring-type cable gripper is included with each plug-in pendant.

This drawing and the content represented is the exclusive property of molo design ltd. and cannot be used without their prior written consent. For site installations verify all dimensions and notify molo of any on-site discrepancies prior to construction. Drawing scale may be affected by printing, scanning, or copying. Do not scale drawings.



molo design, ltd.
1470 Venables Street
Vancouver, BC
Canada V5L 2G7

+ 1 604 685 0340
molodesign.com

Designed by Stephanie Forsythe and Todd MacAllen,
manufactured by molo and protected by one or more patents and/or design registrations held by molo, viewable at molodesign.com/ip

DATE: 260114

cloud softlight · plug-in pendant · 12V SPECIFICATIONS
SCALE · AS NOTED

cloud softlight · plug-in mobile

Plug-in type cloud softlight may be plugged into a standard wall outlet and works internationally with 100 – 240 VAC. An adjustable ring-type cable gripper is included with each cloud softlight mobile, plug-in type.

* dimmer not included with cloud softlight plug-in mobile

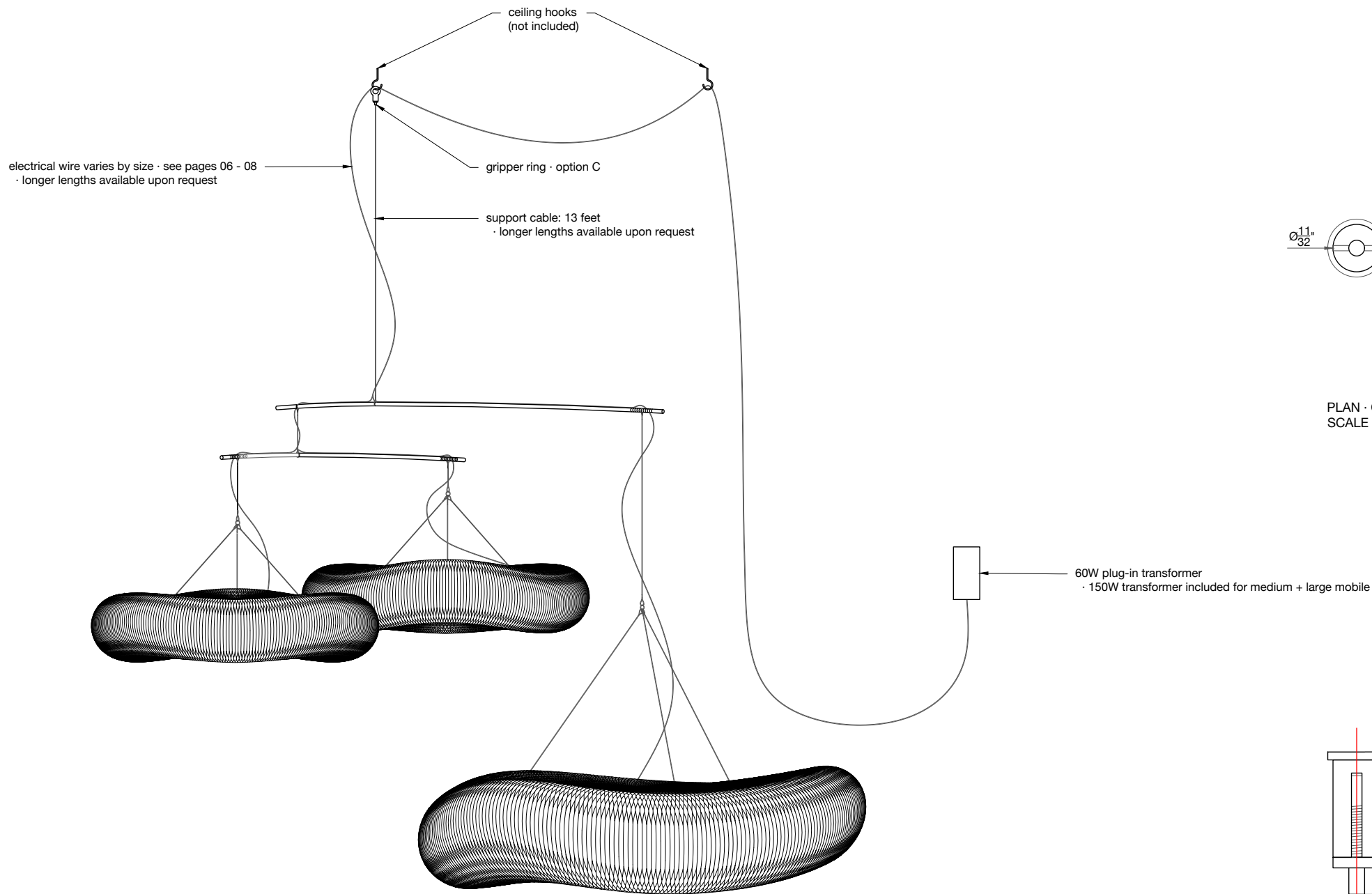

ELEVATION
SCALE · 1:10

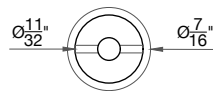

PLAN · OPTION B · SIDE EXIT GRIPPER
SCALE · 1:1

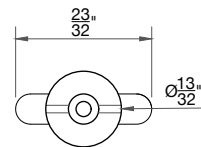

PLAN · OPTION C · GRIPPER RING
SCALE · 1:1

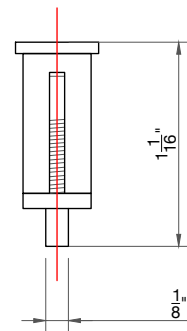

ELEVATION · OPTION B · SIDE EXIT GRIPPER
SCALE · 1:1

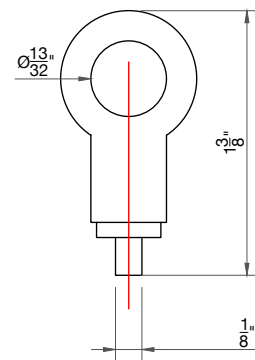

ELEVATION · OPTION C · GRIPPER RING
SCALE · 1:1

This drawing and the content represented is the exclusive property of molo design ltd. and cannot be used without their prior written consent. For site installations verify all dimensions and notify molo of any on-site discrepancies prior to construction. Drawing scale may be affected by printing, scanning, or copying. Do not scale drawings.



molo design, ltd.
1470 Venables Street
Vancouver, BC
Canada V5L 2G7

+ 1 604 685 0340
molodesign.com

Designed by Stephanie Forsythe and Todd MacAllen,
manufactured by molo and protected by one or more patents and/or design registrations held by molo, viewable at molodesign.com/ip

cloud softlight · plug-in mobile · 12V SPECIFICATIONS
SCALE · AS NOTED

DATE: 260114

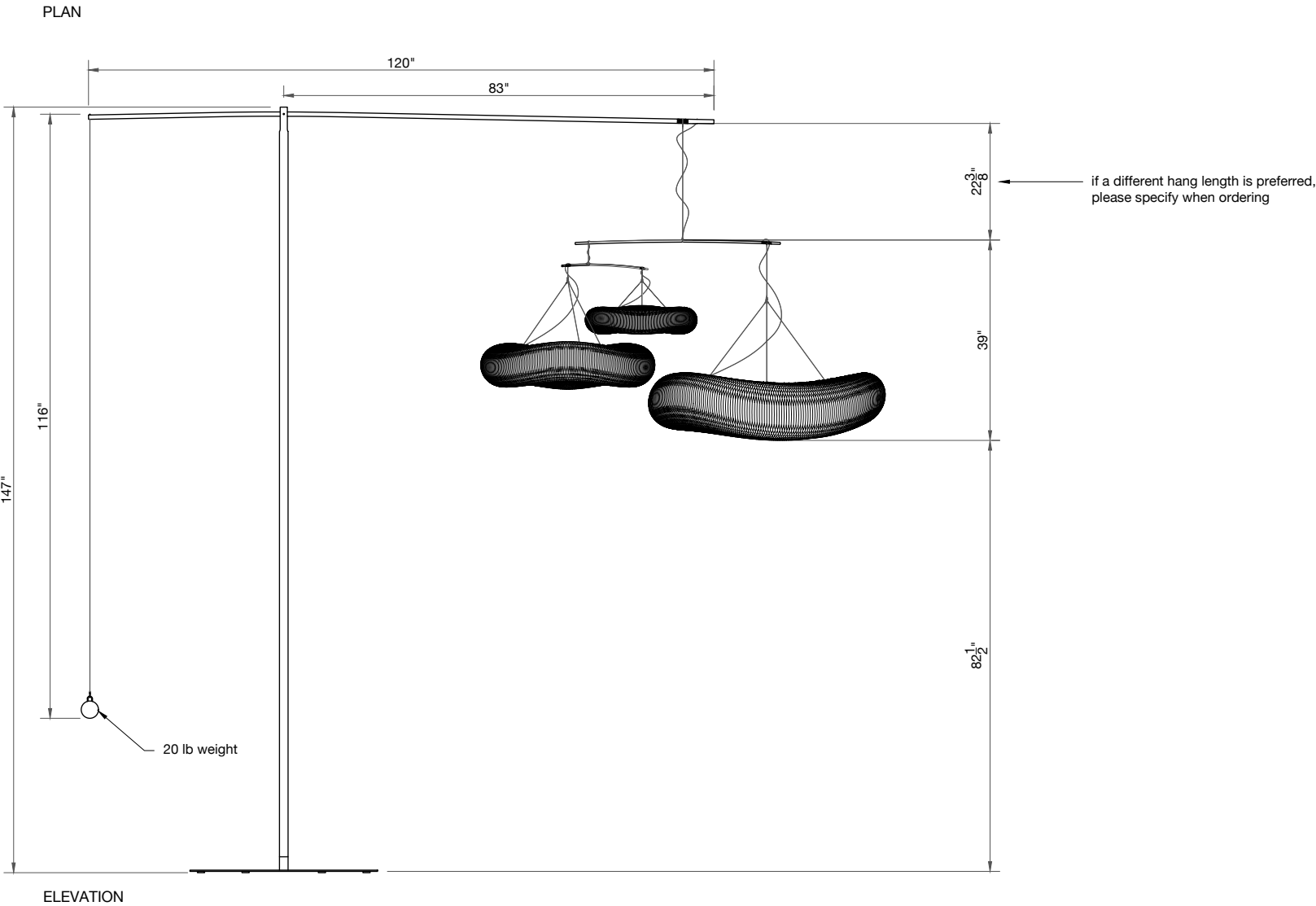
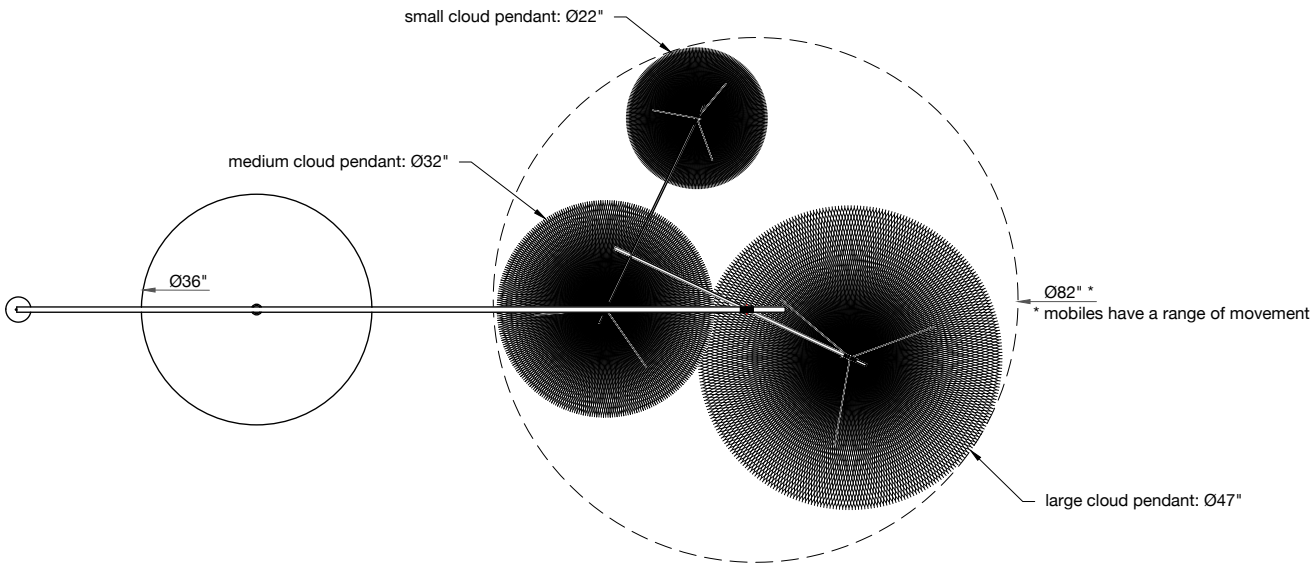

cloud mast · medium

cloud mast is a floor-supported luminaire. The mast is crowned by a boom that holds a cloud mobile in shifting balance with a large fishing weight.

- 90+ CRI LED
- includes: 1 small, 1 medium and 1 large pendant
- 13.7-pound hanging weight
- 83-watt power draw
- 8-foot standard length electrical wire
- custom length electrical wire and support cable available upon request

PRODUCT	COLOUR TEMPERATURE	BRIGHTNESS
medium cloud mast · neutral white	4000K	5064 lumens (average)
medium cloud mast · warm white	2700K	4747 lumens (average)
INSTALLATION TYPE	ELECTRICAL SPECIFICATIONS	DRIVER + TRANSFORMER CERTIFICATIONS
PLUG-IN TRANSFORMER	<ul style="list-style-type: none">· 150W transformer (7 x 2$\frac{3}{4}$ x 1$\frac{5}{8}$")· 110 - 240V input· type B and E/F AC plugs available	CCC, CE Declaration of Conformity, PSE JET, RoHS, UL

FULL FIXTURE CERTIFICATIONS



This drawing and the content represented is the exclusive property of molo design ltd. and cannot be used without their prior written consent. For site installations verify all dimensions and notify molo of any on-site discrepancies prior to construction. Drawing scale may be affected by printing, scanning, or copying. Do not scale drawings.



molo design, ltd.
1470 Venables Street
Vancouver, BC
Canada V5L 2G7

+ 1 604 685 0340
molodesign.com

Designed by Stephanie Forsythe and Todd MacAllen,
manufactured by molo and protected by one or more patents and/or design registrations held by molo, viewable at molodesign.com/ip

cloud mast · medium · 12V SPECIFICATIONS
SCALE · 1:30

DATE: 260114

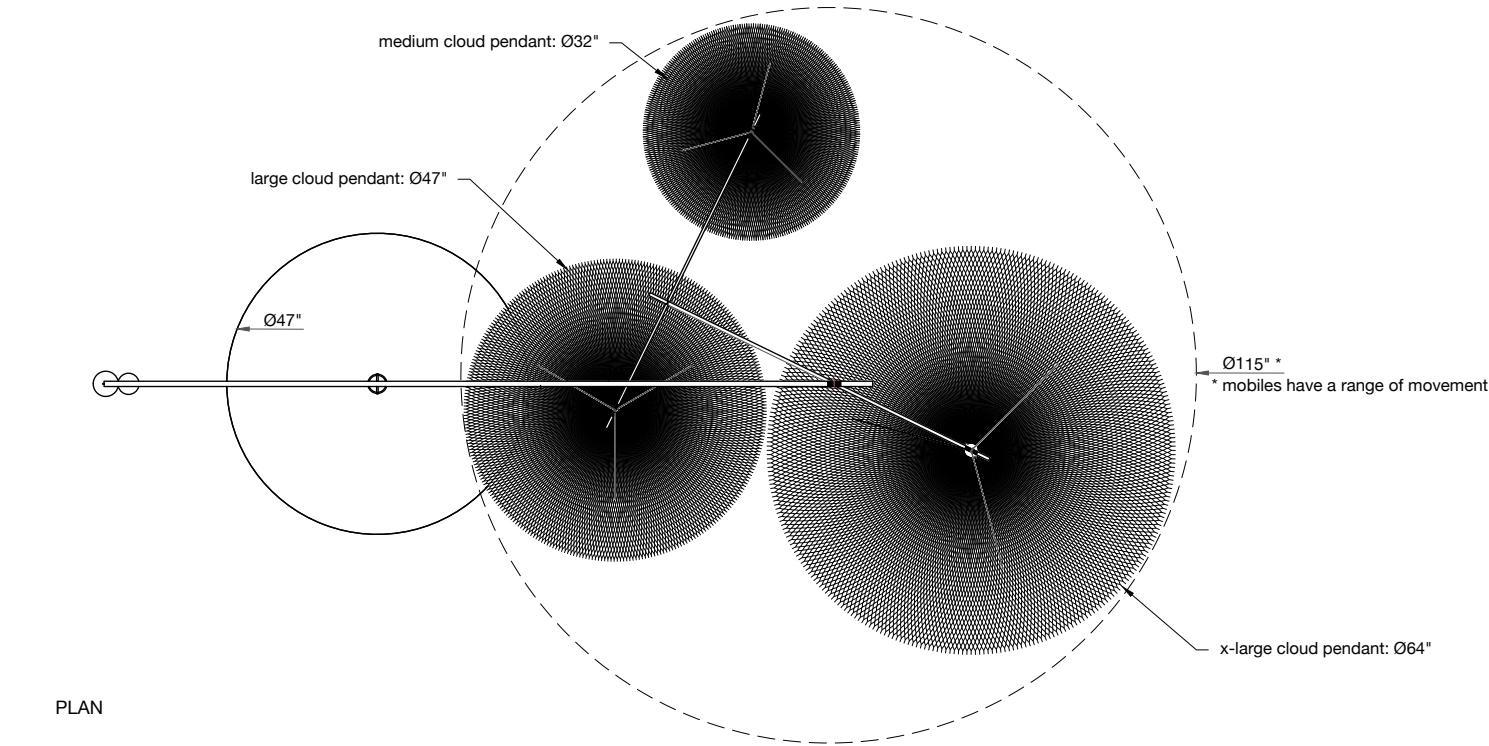

PLAN

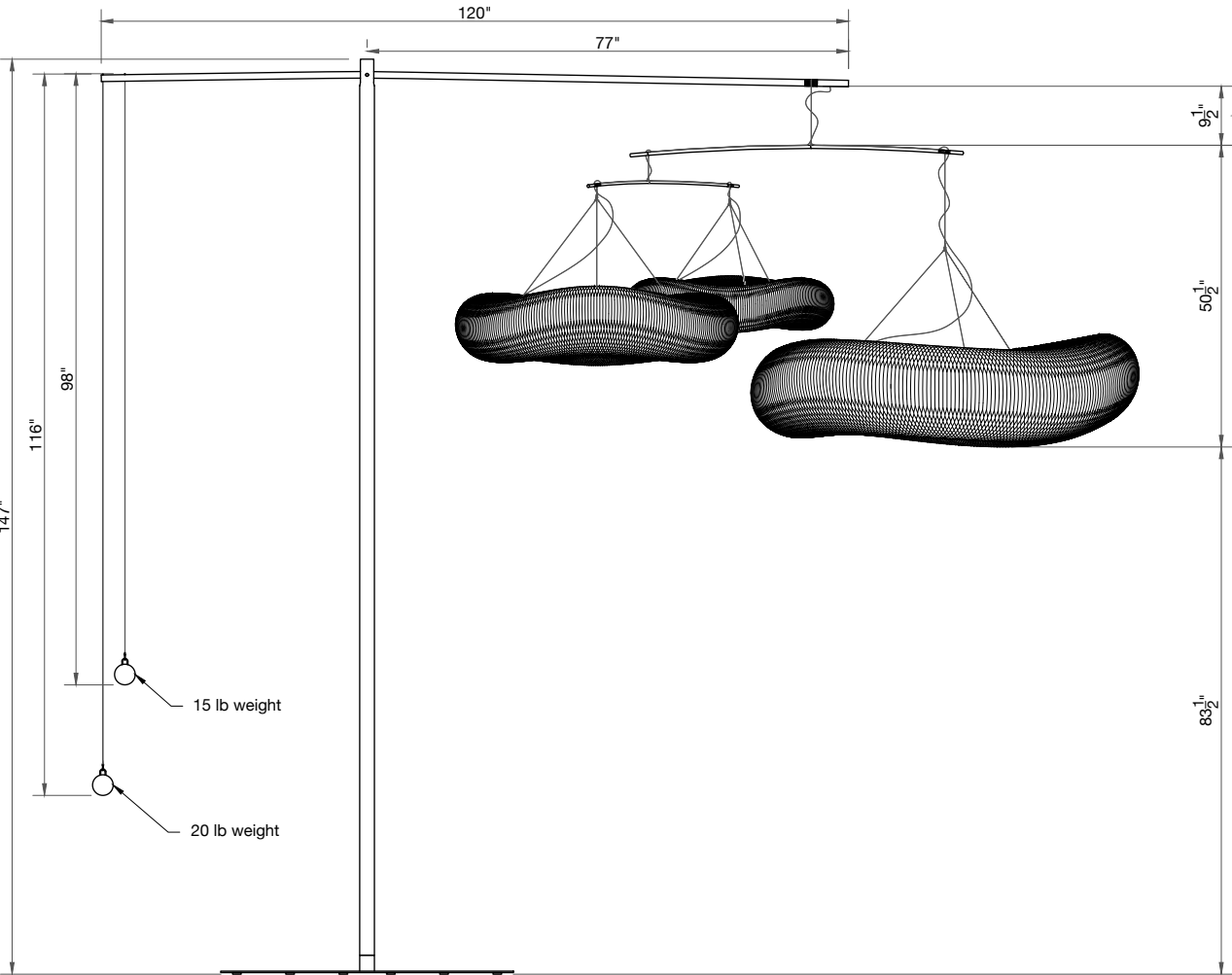

ELEVATION

cloud mast · large

cloud mast is a floor-supported luminaire. The mast is crowned by a boom that holds a cloud mobile in shifting balance with two large fishing weights.

- 90+ CRI LED
- includes: 1 medium, 1 large and 1 x-large pendant
- 25.5-pound hanging weight
- 126-watt power draw
- 9.5-foot standard length electrical wire
- custom length electrical wire and support cable available upon request

PRODUCT	COLOUR TEMPERATURE	BRIGHTNESS
large cloud mast · neutral white	4000K	7472 lumens (average)
large cloud mast · warm white	2700K	7008 lumens (average)
INSTALLATION TYPE	ELECTRICAL SPECIFICATIONS	DRIVER + TRANSFORMER CERTIFICATIONS
PLUG-IN TRANSFORMER	<ul style="list-style-type: none">· 150W transformer (7 x 2 3/4 x 1 5/8")· 110 - 240V input· type B and E/F AC plugs available	CCC, CE Declaration of Conformity, PSE JET, RoHS, UL

FULL FIXTURE CERTIFICATIONS



This drawing and the content represented is the exclusive property of molo design ltd. and cannot be used without their prior written consent. For site installations verify all dimensions and notify molo of any on-site discrepancies prior to construction. Drawing scale may be affected by printing, scanning, or copying. Do not scale drawings.



molo design, ltd.
1470 Venables Street
Vancouver, BC
Canada V5L 2G7

+ 1 604 685 0340
molodesign.com

Designed by Stephanie Forsythe and Todd MacAllen,
manufactured by molo and protected by one or more patents and/or design registrations held by molo, viewable at molodesign.com/ip

cloud mast · large · 12V SPECIFICATIONS
SCALE · 1:30

DATE: 260114