

# softseating

softseating fanning stool stores compressed like a book. This paper furniture unfurls into a compact paper stool or low table, or stretches into a long paper bench. Structured with honeycomb geometry, the foldable seat takes on surprising strength and flexibility. Multiple elements can be stacked to create playful hills and display podiums, or connected by magnetic end panels to form long, winding benches and creative seating topographies.

softseating is held in the Museum of Modern Art's permanent collection.

Design by Stephanie Forsythe + Todd MacAllen

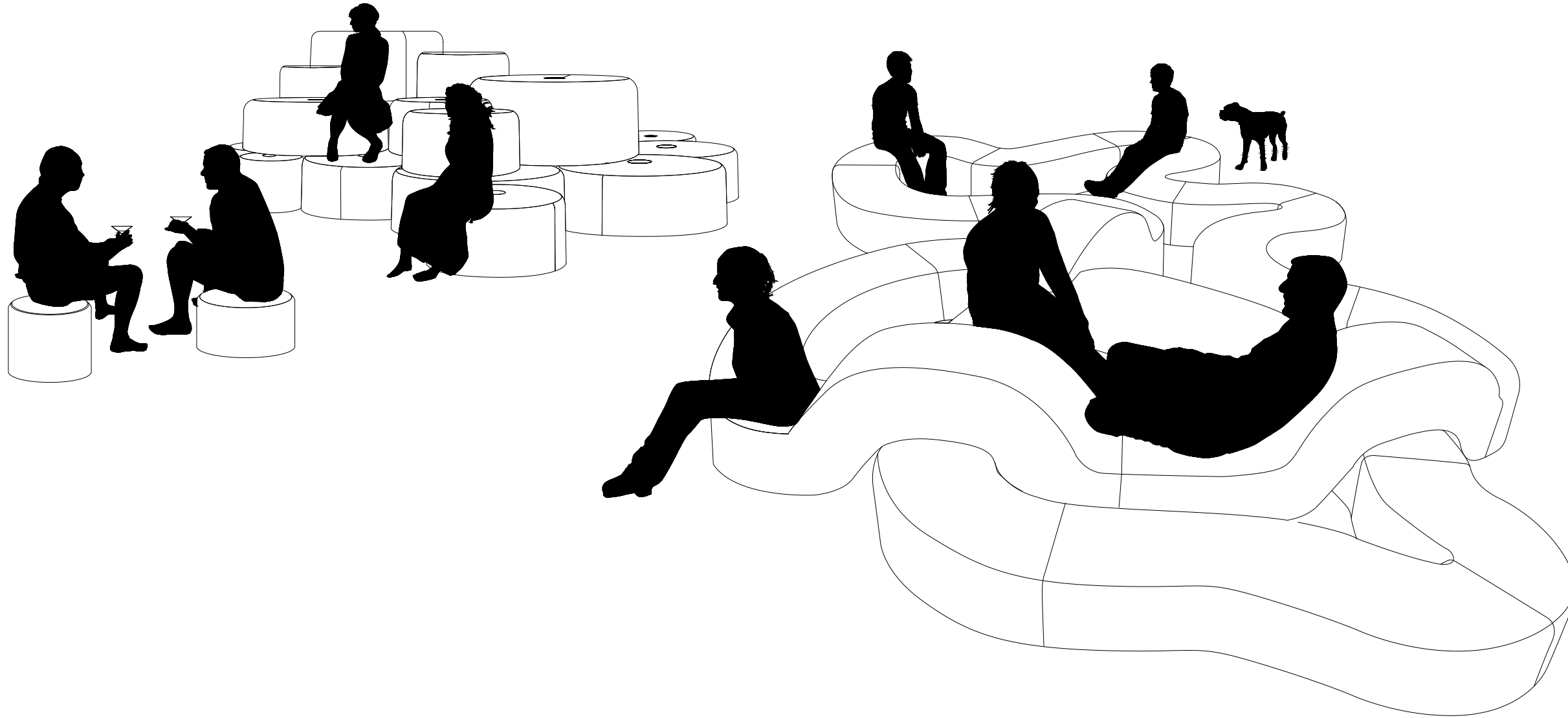

This drawing and the content represented is the exclusive property of molo design ltd. and cannot be used without their prior written consent. For site installations verify all dimensions and notify molo of any on-site discrepancies prior to construction. Drawing scale may be affected by printing, scanning, or copying. Do not scale drawings.



molo design, ltd.  
1470 Venables Street  
Vancouver, BC  
Canada V5L 2G7

+ 1 604 685 0340  
molodesign.com

Designed by Stephanie Forsythe and Todd MacAllen,  
manufactured by molo and protected by one or more patents and/or design registrations held by molo, viewable at [molodesign.com/ip](http://molodesign.com/ip)

IMPERIAL DRAWING SET

## OVERVIEW

softseating is a collection of seating and table elements made from paper or nonwoven polyethylene textile. Elements use a flexible honeycomb structure to fan open into stools, tables, benches and loungers. Modular magnetic end panels allow each seat to connect to itself, forming a round stool or low table, or chain elements in series to create long winding benches and unique seating topographies. softseat benches have a modular magnetic pattern that allows them to connect to the magnetic end panels of softwall + softblock.

softseating lounge fans into a generous pouf for lying down or sitting. Its sculptural quality is striking as an individual seating piece or as part of a larger, grouped installation. Lean multiple softseating fanning loungers against one another for an organic seating arrangement, or arrange a portion against a wall to create a natural backrest.

## SUSTAINABILITY

The soft collection follows three core sustainable principles: flexible use of space, efficient use of material, and recyclable/responsible materials.

**Flexible use of space** · Enabling a space to suit diverse use over time, throughout the day or over its lifespan, is an inherently sustainable practice. The soft collection requires no tools or additional supports to create freestanding structures and is easily folded away for storage. Whether for the temporary division of space in a live / work environment or shaping space for the unpredictable growth of a new business, the soft collection empowers people to change and adapt their spaces.

**Efficient use of material** · By virtue of its honeycomb cell structure, the soft collection makes highly efficient use of its material and can be easily re-compressed for efficient storage or shipping.

**Recyclable/responsible materials** · softseating is designed with the intention of a long, useful life. Nevertheless, the materials can be recycled. After removing the magnets from the end panels, recycle the remaining material. textile softseating is 100% polyethylene, number “2” in the recycling stream, and paper softseating can be recycled with any regular paper recycling program.

## PAPER · MATERIAL

The paper is a robust blend of new and recycled fibres, which easily supports people or pets. Acoustically absorbent paper softseating is available in brown, charcoal black and blue. brown and blue paper furniture is made from wood harvested from FSC® Certified (FSC® C158591) responsible sources. All paper products have been produced with non-toxic fire retardants, adhesives and inks.

We do not recommend using paper products in extreme humidity environments, where softseating may come into contact with moisture.

## TEXTILE · MATERIAL

Made from non-woven polyethylene, textile is tear- and water-resistant, anti-static to repel dust and has a natural UV protection that prevents yellowing with sunlight or age. The translucent material has a delicate appearance reminiscent of Japanese washi and comes to life when illuminated by sunlight or integrated LED. textile softseating have a “Class A” rating for flame spread and smoke, developed in accordance with ASTM E84-05. All products made with the textile are easy to maintain and can be dusted, vacuumed or wiped clean with a damp cloth. The textile is 100% recyclable.

## PANTONE CODES FOR STANDARD molo COLOURS

Here is a list of the closest Pantone matches for molo colours and materials:

brown paper: Pantone 7565U  
 blue paper: Pantone 293 U · blue  
 black paper: Pantone 19-0000 TPG/TCX · raven  
 black textile: Pantone 19-0405 TPG/TCX · beluga  
 white textile: Pantone 11-4001 TPG/TCX · brilliant white (also matches Corian Glacier White)  
 aluminum textile: Pantone 877 C · metallic  
 forest green textile: Pantone 7742 U

## PATINA

molo softseating is intended to crush down and form a patina over time. The top surface will soften and fold into a unique, organic pattern. This patina will not affect the seat’s structural integrity.

## LIMITED EDITION · GILDED PAPER

In their material investigations, molo founders and designers Stephanie Forsythe + Todd MacAllen found inspiration in gilded books and illuminated manuscripts. Traditionally, artisans, bookbinders, and monks applied a thin layer of gold to the paper’s edge. This process served the practical function of safeguarding from dust, moisture, and sunlight but most significantly illuminated the manuscript’s importance. Through the same centuries-old process, the paper edges were coated with 24-karat gold leaf that will never tarnish. The gilded pleats catch light with a subtle beauty and sheen that shifts with the viewing angle.

## FIRE CERTIFICATIONS

M1 · France	<ul style="list-style-type: none"> <li>· all paper products</li> <li>· FR textile (standard textile is Class A — see below)</li> </ul> <p>French NF P 92 503-507 (M1) 504 rate of flame spread test. The test material is classified into 5 categories that define the fire resistance of materials: M0: non-combustible, M1: combustible (non-flammable), M2: combustible (flame retardant), M3: combustible (moderately flammable), M4: combustible (highly flammable), NC: not classified.</p>
B1 · Germany	<ul style="list-style-type: none"> <li>· all paper products</li> <li>· FR textile (standard textile is Class A — see below)</li> </ul> <p>German DIN 4102-1 defines fire behavior classes for building materials and specifies requirements and test methods for each class. The test material is classified into 5 categories that define the fire resistance of materials: A1 + A2: fireproof materials, B1: not easily flammable, B2: flammable, B3: easily flammable. B1 (Brandschacht) is the main test method in Germany which measures reaction to fire and is considered the highest flammability standard in the country.</p>
NFPA 701 · United States	<ul style="list-style-type: none"> <li>· all paper products</li> <li>· FR textile (standard textile is Class A — see below)</li> </ul> <p>NFPA 701 testing measures the ignition resistance of a fabric after it is exposed to a flame for 12 seconds.</p>
ASTM 84-05 Class A · United States	<ul style="list-style-type: none"> <li>· all textile products — if M1 or B1 is required, please inquire</li> </ul> <p>Class A fire rating represents the highest rating achievable, indicating a flame spread of 0 - 25 and smoke developed between 0 - 450. A designation of Class A, or Class I, is considered superior fire protection.</p>

## ACOUSTICS

There are two ways that softseating improves acoustics. First, their pleated forms break up a room’s flat, typically parallel surfaces, reducing sound reflection and standing waves. Second, the sound is absorbed by its honeycomb structure, reducing sound transmission through the partitions.

See NRC test results for softwall + softblock and cloud softight below. softseating will similarly absorb sound in a space as they all share the same type of honeycomb structure and pleated form.

NRC stands for Noise Reduction Coefficient. It is a rating system that explains how much sound an acoustic product can absorb. Ratings range from 0 to 1. An acoustic product with a 0.95 NRC rating means that 95% of the space’s noise is absorbed, while 5% is reflected. molo softwall + softblock modular system has an average absorption range of 0.25 - 0.50.

NRC = 0.25 · 9.25” (23.5 cm) wide softwall + softblock  
 NRC = 0.30 · 13.3” (34 cm) wide softwall + softblock  
 NRC = 0.50 · 17.75” (45 cm) wide softwall + softblock  
 NRC = 0.45 · cloud softlight  
 \* softwall + softblock NRC tests have been completed in textile and paper materials, resulting in the same NRC values.

Other soft collection products, such as partitions, lighting, and cantilever table, will absorb sound in a space as they all share the same type of honeycomb structure and pleated form.

## FSC® CERTIFIED

molo brown and blue paper furniture is made from wood harvested from FSC® Certified (FSC® C158591) responsible sources and coated with a non-toxic fire retardant.

The Forest Stewardship Council GmbH is an international non-profit, multistakeholder organization established in 1993 that promotes responsible management of the world’s forests via timber certification. The FSC certification is considered the “gold standard” designation for wood harvested from forests that are responsibly managed, socially beneficial, environmentally conscious, and economically viable.

## LIGHTFASTNESS · OVERVIEW

Lightfastness is a property of a colourant such as dye or pigment that describes its resistance to fading when exposed to light.		
LIGHTFASTNESS LEVEL (BLUE WOOL SCALE)	DIRECT EXPOSURE SUMMER / WINTER	NORMAL CONDITIONS OF DISPLAY *
1	-	less than 2 years
2	-	2 - 15 years
3	4 - 8 days / 2 - 4 weeks	2 - 15 years
4	2 - 3 weeks / 2 - 3 months	15 - 50 years
5	3 - 5 weeks / 4 - 5 months	15 - 50 years
6	6 - 8 weeks / 5 - 6 months	50 - 100 years
7	3 - 4 months / 7 - 9 months	over 100 years
8	over 1.5 years	over 100 years
8+	exceeds performance of blue wool scale number 8	

## molo MATERIAL LIGHTFASTNESS

COLOUR · MATERIAL	LIGHTFASTNESS LEVEL (BLUE WOOL SCALE)
brown paper	5 - 6 (fades to a slightly lighter shade of brown with prolonged sun exposure)
black paper	5 (very slight reduction of the intensity of black with prolonged sun exposure)
blue paper	3 - 4
heavyweight white textile	8
aluminum textile	8+
forest green textile	8+
brown PaperStone®	5
black PaperStone®	7

## OPTIONAL ACCESSORIES

PaperStone® top	The PaperStone® table top material is highly water resistant, suitable for wet environments and finished by molo with a clear, flat/matte, 7” sheen, polyurethane top coat.
wool felt pad	Each diameter of fanning stool has a corresponding wool felt pad, which may be used as an optional cushion or soft table surface.
wool felt tote	The two smallest sizes of softseating are available with a convenient felt tote, for whisking the paper seats off to a gallery, garden party or concert.
LED kits	Integrated LED lighting is available for white textile softseating. Please inquire for more information.

## 2D + 3D DRAWING FILES

AutoCAD, Sketchup, Revit, 3DS and Rhino drawing files for the entire softseating collection are available for download at <https://molodesign.com/documentation/product-drawings/>

## DOWNLOAD CERTIFICATES

Download all certificates at <https://molodesign.com/documentation/certifications/>

This drawing and the content represented is the exclusive property of molo design ltd. and cannot be used without their prior written consent. For site installations verify all dimensions and notify molo of any on-site discrepancies prior to construction. Drawing scale may be affected by printing, scanning, or copying. Do not scale drawings.



molo design, ltd.  
 1470 Venables Street  
 Vancouver, BC  
 Canada V5L 2G7

+ 1 604 685 0340  
 molodesign.com

Designed by Stephanie Forsythe and Todd MacAllen,  
 manufactured by molo and protected by one or more patents and/or design registrations held by molo, viewable at [molodesign.com/ip](http://molodesign.com/ip)

softseating · SPECIFICATIONS AND CERTIFICATIONS

DATE: 260413

01

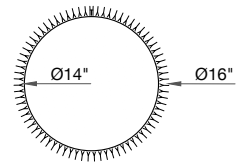

PLAN · PaperStone® TOP

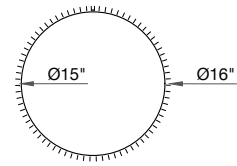

PLAN · WOOL FELT PAD

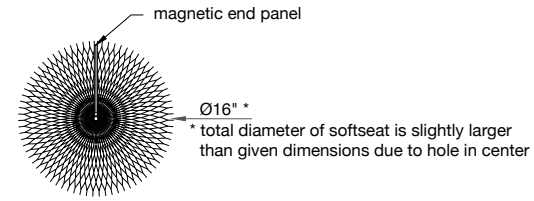

PLAN · softseating - fanning stool + table

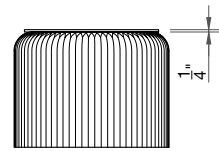

ELEVATION · PaperStone® TOP

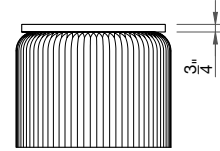

ELEVATION · WOOL FELT PAD

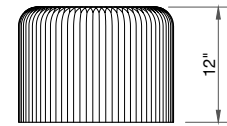

ELEVATION · softseating - fanning stool + table

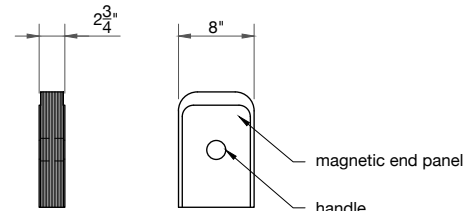

ELEVATION · COMPRESSED VIEWS

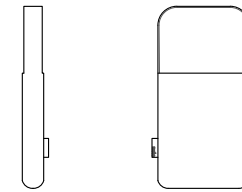

ELEVATION · WOOL FELT TOTE

softseating · 12" tall x 16" diameter			
COLOUR · MATERIAL	PRODUCT WEIGHT	SHIPPING WEIGHT	SKU
brown · paper	3.0 lb	4.0 lb	M-SS-P-FSC-BR-12-16
black · paper	3.1 lb	4.2 lb	M-SS-P-BK-12-16
blue · paper	3.1 lb	4.2 lb	M-SS-P-FSC-BU-12-16
white · textile	2.4 lb	3.3 lb	M-SS-T-WH-12-16
aluminum · textile	2.7 lb	3.6 lb	M-SS-T-AL-12-16
forest green · textile	2.7 lb	3.6 lb	M-SS-T-GR-12-16

OPTIONAL ACCESSORIES			
PRODUCT · COLOUR	PRODUCT WEIGHT	SHIPPING WEIGHT	SKU
wool felt pad · grey	0.8 lb	1.1 lb	M-PAD-FLT-GR-15
wool felt tote · dark grey	0.6 lb	0.6 lb	P-CASE-FLT-GR-12
PaperStone® top · brown	1.3 lb	1.9 lb	M-TOP-P-FSC-BR-14
PaperStone® top · black	1.9 lb	2.4 lb	M-TOP-P-FSC-BK-14
PaperStone® top · grey	1.9 lb	2.4 lb	M-TOP-P-FSC-GR-14

This drawing and the content represented is the exclusive property of molo design ltd. and cannot be used without their prior written consent. For site installations verify all dimensions and notify molo of any on-site discrepancies prior to construction. Drawing scale may be affected by printing, scanning, or copying. Do not scale drawings.

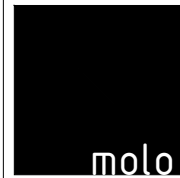

molo design, ltd.  
1470 Venables Street  
Vancouver, BC  
Canada V5L 2G7  
+ 1 604 685 0340  
molodesign.com

Designed by Stephanie Forsythe and Todd MacAllen,  
manufactured by molo and protected by one or more patents and/or design registrations held by molo, viewable at molodesign.com/ip

softseating fanning stool + table · 12" tall x 16" diameter · SPECIFICATIONS  
SCALE · 1:20

DATE: 260413

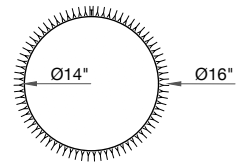

PLAN · PaperStone® TOP

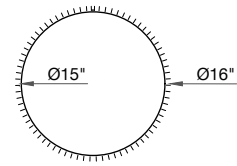

PLAN · WOOL FELT PAD

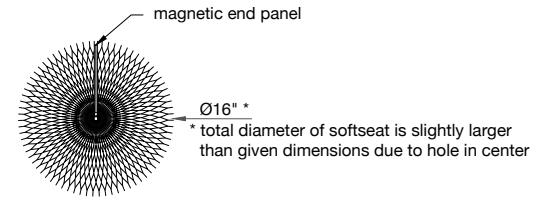

PLAN · softseating - fanning stool + table

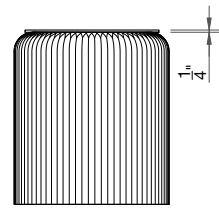

ELEVATION · PaperStone® TOP

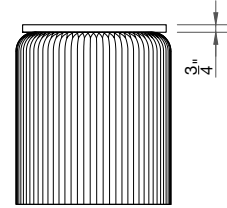

ELEVATION · WOOL FELT PAD

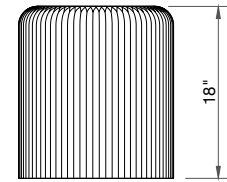

ELEVATION · softseating - fanning stool + table

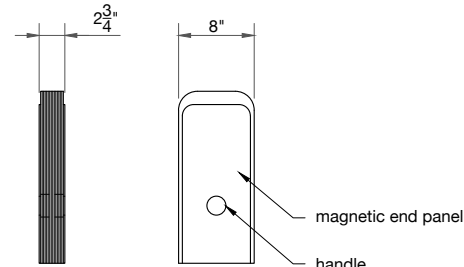

ELEVATION · COMPRESSED VIEWS

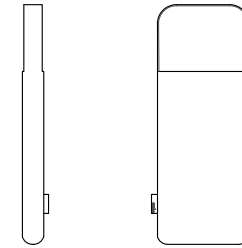

ELEVATION · WOOL FELT TOTE

softseating · 18" tall x 16" diameter			
COLOUR · MATERIAL	PRODUCT WEIGHT	SHIPPING WEIGHT	SKU
brown · paper	4.8 lb	5.4 lb	M-SS-P-FSC-BR-18-16
black · paper	5.0 lb	5.6 lb	M-SS-P-BK-18-16
blue · paper	5.0 lb	5.6 lb	M-SS-P-FSC-BU-18-16
white · textile	4.1 lb	4.8 lb	M-SS-T-WH-18-16
aluminum · textile	4.5 lb	5.1 lb	M-SS-T-AL-18-16
forest green · textile	4.5 lb	5.1 lb	M-SS-T-GR-18-16

OPTIONAL ACCESSORIES			
PRODUCT · COLOUR	PRODUCT WEIGHT	SHIPPING WEIGHT	SKU
wool felt pad · grey	0.8 lb	1.1 lb	M-PAD-FLT-GR-15
wool felt tote · dark grey	0.8 lb	0.8 lb	P-CASE-FLT-GR-18
PaperStone® top · brown	1.3 lb	1.9 lb	M-TOP-P-FSC-BR-14
PaperStone® top · black	1.9 lb	2.4 lb	M-TOP-P-FSC-BK-14
PaperStone® top · grey	1.9 lb	2.4 lb	M-TOP-P-FSC-GR-14

This drawing and the content represented is the exclusive property of molo design ltd. and cannot be used without their prior written consent. For site installations verify all dimensions and notify molo of any on-site discrepancies prior to construction. Drawing scale may be affected by printing, scanning, or copying. Do not scale drawings.

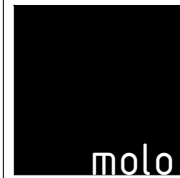

molo design, ltd.  
1470 Venables Street  
Vancouver, BC  
Canada V5L 2G7

+ 1 604 685 0340  
molodesign.com

Designed by Stephanie Forsythe and Todd MacAllen,  
manufactured by molo and protected by one or more patents and/or design registrations held by molo, viewable at molodesign.com/ip

softseating fanning stool + table · 18" tall x 16" diameter · SPECIFICATIONS  
SCALE · 1:20

DATE: 260413

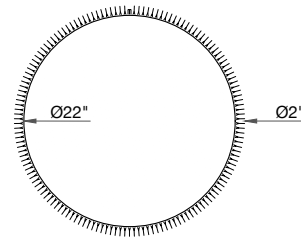

PLAN · PaperStone® TOP

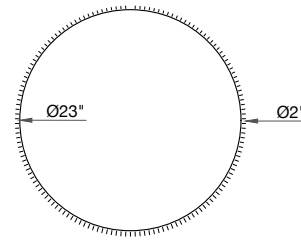

PLAN · WOOL FELT PAD

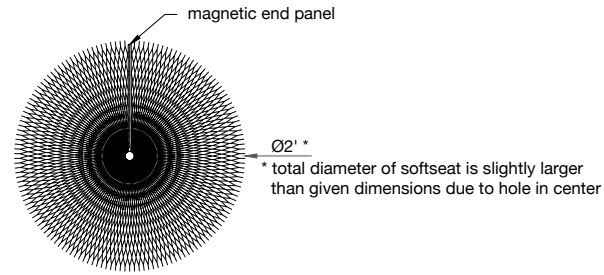

PLAN · softseating - fanning stool + table

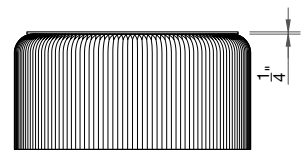

ELEVATION · PaperStone® TOP

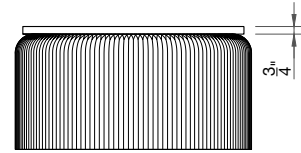

ELEVATION · WOOL FELT PAD

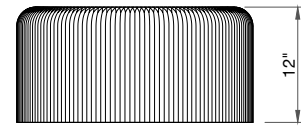

ELEVATION · softseating - fanning stool + table

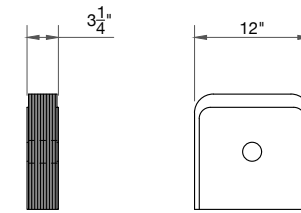

ELEVATION · COMPRESSED VIEWS

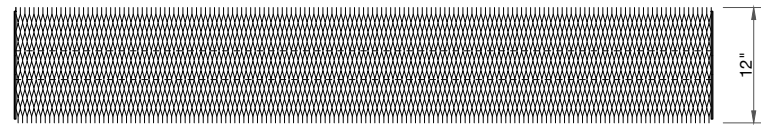

PLAN · softseating - bench

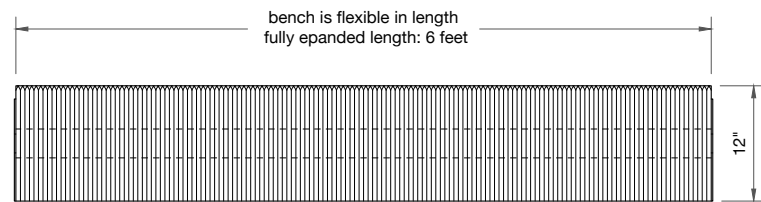

ELEVATION · softseating - bench

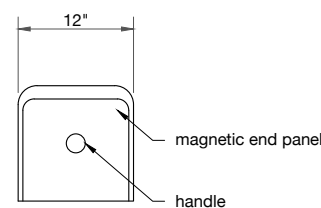

ELEVATION · COMPRESSED

softseating · 12" tall x 24" diameter · 6' bench *			
COLOUR · MATERIAL	PRODUCT WEIGHT	SHIPPING WEIGHT	SKU
brown · paper	8.4 lb	9.9 lb	M-SS-P-FSC-BR-12-24
black · paper	8.7 lb	10.2 lb	M-SS-P-BK-12-24
blue · paper	8.7 lb	10.2 lb	M-SS-P-FSC-BU-12-24
white · textile	7.5 lb	9.0 lb	M-SS-T-WH-12-24
aluminum · textile	7.5 lb	9.0 lb	M-SS-T-AL-12-24
forest green · textile	7.5 lb	9.0 lb	M-SS-T-GR-12-24

softseating fanning stool · OPTIONAL ACCESSORIES			
PRODUCT · COLOUR	PRODUCT WEIGHT	SHIPPING WEIGHT	SKU
wool felt pad · grey	1.9 lb	2.4 lb	M-PAD-FLT-GR-23
PaperStone® top · brown	3.9 lb	4.6 lb	M-TOP-P-FSC-BR-22
PaperStone® top · black	4.6 lb	5.2 lb	M-TOP-P-FSC-BK-22
PaperStone® top · grey	4.6 lb	5.2 lb	M-TOP-P-FSC-GR-22

softseating fanning bench · OPTIONAL ACCESSORIES			
PRODUCT · COLOUR	PRODUCT WEIGHT	SHIPPING WEIGHT	SKU
wool felt pad · grey	0.8 lb	1.1 lb	M-PAD-FLT-GR-15
PaperStone® top · brown	1.3 lb	1.9 lb	M-TOP-P-FSC-BR-14
PaperStone® top · black	1.9 lb	2.4 lb	M-TOP-P-FSC-BK-14
PaperStone® top · grey	1.9 lb	2.4 lb	M-TOP-P-FSC-GR-14

\* small amount of length lost when bench is placed in curved configurations

This drawing and the content represented is the exclusive property of molo design ltd. and cannot be used without their prior written consent. For site installations verify all dimensions and notify molo of any on-site discrepancies prior to construction. Drawing scale may be affected by printing, scanning, or copying. Do not scale drawings.

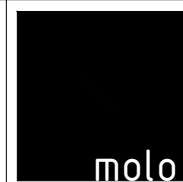

molo design, ltd.  
1470 Venables Street  
Vancouver, BC  
Canada V5L 2G7

+ 1 604 685 0340  
molodesign.com

Designed by Stephanie Forsythe and Todd MacAllen,  
manufactured by molo and protected by one or more patents and/or design registrations held by molo, viewable at molodesign.com/ip

softseating fanning stool, bench + table · 12" tall x 24" diameter · SPECIFICATIONS  
SCALE · 1:20

DATE: 260413

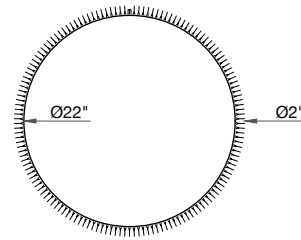

PLAN · PaperStone® TOP

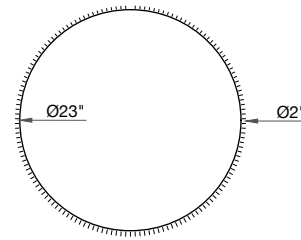

PLAN · WOOL FELT PAD

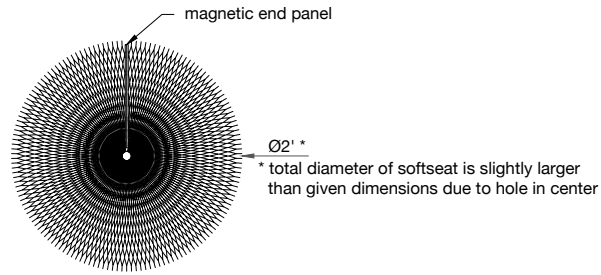

PLAN · softseating - fanning stool + table

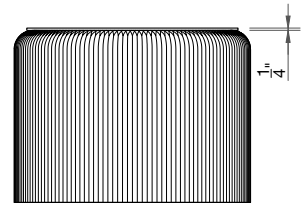

ELEVATION · PaperStone® TOP

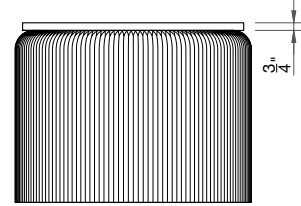

ELEVATION · WOOL FELT PAD

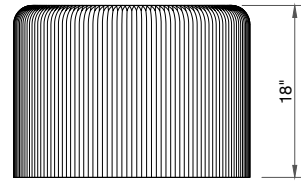

ELEVATION · softseating - fanning stool + table

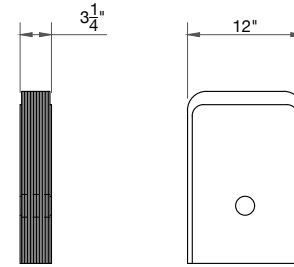

ELEVATION · COMPRESSED VIEWS

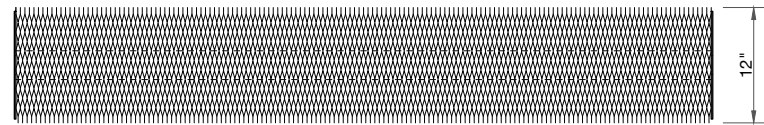

PLAN · softseating - bench

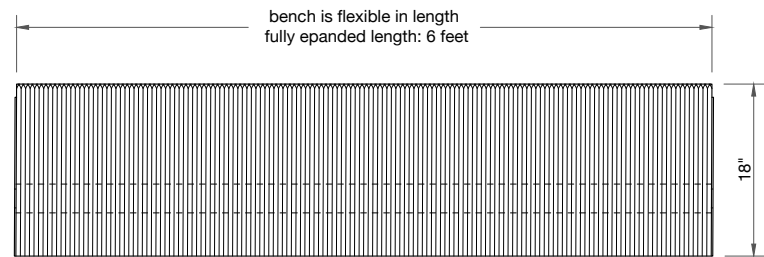

ELEVATION · softseating - bench

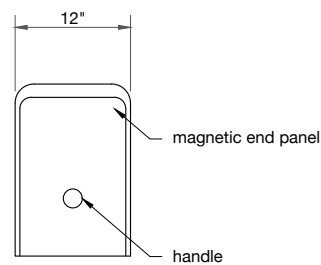

ELEVATION · COMPRESSED

softseating · 18" tall x 24" diameter · 6' bench *			
COLOUR · MATERIAL	PRODUCT WEIGHT	SHIPPING WEIGHT	SKU
brown · paper	13.0 lb	14.8 lb	M-SS-P-FSC-BR-18-24
black · paper	13.3 lb	15.1 lb	M-SS-P-BK-18-24
blue · paper	13.3 lb	15.1 lb	M-SS-P-FSC-BU-18-24
white · textile	11.2 lb	13.2 lb	M-SS-T-WH-18-24
aluminum · textile	11.5 lb	13.5 lb	M-SS-T-AL-18-24
forest green · textile	11.5 lb	13.5 lb	M-SS-T-GR-18-24

softseating fanning stool · OPTIONAL ACCESSORIES			
PRODUCT · COLOUR	PRODUCT WEIGHT	SHIPPING WEIGHT	SKU
wool felt pad · grey	1.9 lb	2.4 lb	M-PAD-FLT-GR-23
PaperStone® top · brown	3.9 lb	4.6 lb	M-TOP-P-FSC-BR-22
PaperStone® top · black	4.6 lb	5.2 lb	M-TOP-P-FSC-BK-22
PaperStone® top · grey	4.6 lb	5.2 lb	M-TOP-P-FSC-GR-22

softseating fanning bench · OPTIONAL ACCESSORIES			
PRODUCT · COLOUR	PRODUCT WEIGHT	SHIPPING WEIGHT	SKU
wool felt pad · grey	0.8 lb	1.1 lb	M-PAD-FLT-GR-15
PaperStone® top · brown	1.3 lb	1.9 lb	M-TOP-P-FSC-BR-14
PaperStone® top · black	1.9 lb	2.4 lb	M-TOP-P-FSC-BK-14
PaperStone® top · grey	1.9 lb	2.4 lb	M-TOP-P-FSC-GR-14

\* small amount of length lost when bench is placed in curved configurations

This drawing and the content represented is the exclusive property of molo design ltd. and cannot be used without their prior written consent. For site installations verify all dimensions and notify molo of any on-site discrepancies prior to construction. Drawing scale may be affected by printing, scanning, or copying. Do not scale drawings.



molo design, ltd.  
1470 Venables Street  
Vancouver, BC  
Canada V5L 2G7

+ 1 604 685 0340  
molodesign.com

Designed by Stephanie Forsythe and Todd MacAllen,  
manufactured by molo and protected by one or more patents and/or design registrations held by molo, viewable at molodesign.com/ip

softseating fanning stool, bench + table · 18" tall x 24" diameter · SPECIFICATIONS  
SCALE · 1:20

DATE: 260413

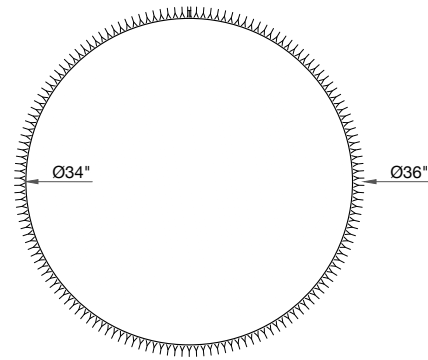

PLAN · PaperStone® TOP

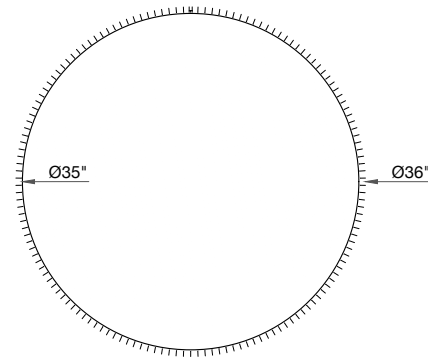

PLAN · WOOL FELT PAD

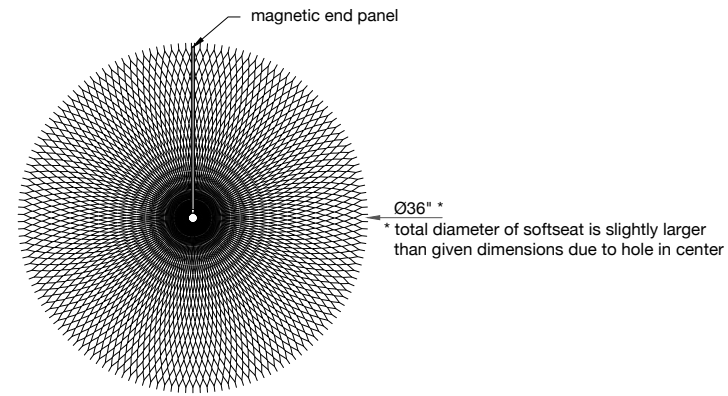

PLAN · softseating - fanning stool + table

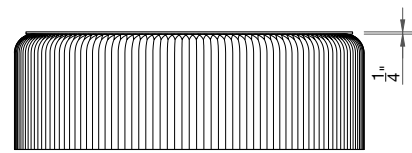

ELEVATION · PaperStone® TOP

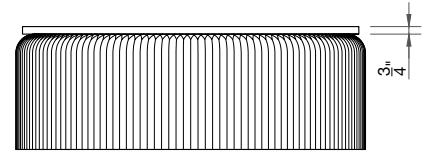

ELEVATION · WOOL FELT PAD

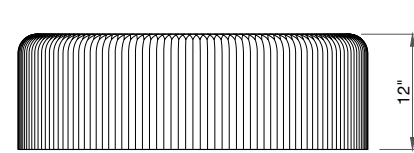

ELEVATION · softseating - fanning stool + table

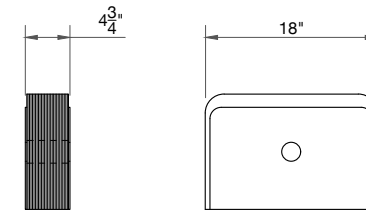

ELEVATION · COMPRESSED VIEWS

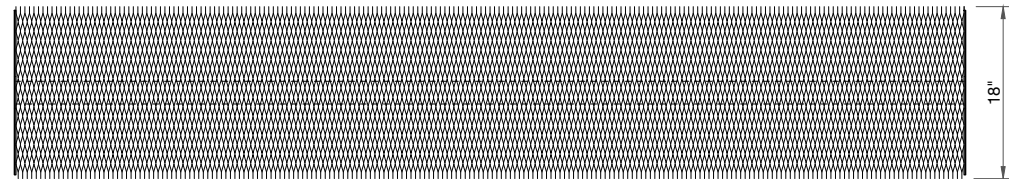

PLAN · softseating - bench

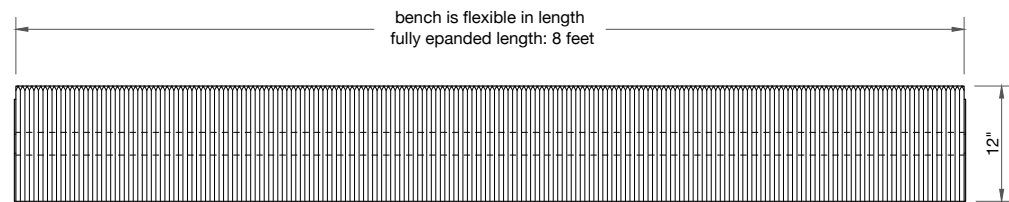

ELEVATION · softseating - bench

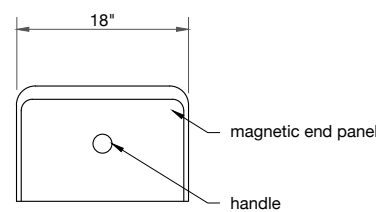

ELEVATION · COMPRESSED

softseating · 12" tall x 36" diameter · 8' bench *			
COLOUR · MATERIAL	PRODUCT WEIGHT	SHIPPING WEIGHT	SKU
brown · paper	20.5 lb	22.7 lb	M-SS-P-FSC-BR-12-36
black · paper	24.7 lb	27.1 lb	M-SS-P-BK-12-36
blue · paper	24.7 lb	27.1 lb	M-SS-P-FSC-BU-12-36
white · textile	16.7 lb	19.1 lb	M-SS-T-WH-12-36
aluminum · textile	17.2 lb	19.6 lb	M-SS-T-AL-12-36
forest green · textile	17.2 lb	19.6 lb	M-SS-T-GR-12-36

softseating fanning stool · OPTIONAL ACCESSORIES			
PRODUCT · COLOUR	PRODUCT WEIGHT	SHIPPING WEIGHT	SKU
wool felt pad · grey	5.0 lb	6.0 lb	M-PAD-FLT-GR-15
PaperStone® top · brown	9.4 lb	15.4 lb	M-TOP-P-FSC-BR-34
PaperStone® top · black	10.8 lb	15.4 lb	M-TOP-P-FSC-BK-34
PaperStone® top · grey	10.8 lb	15.4 lb	M-TOP-P-FSC-GR-34

softseating fanning bench · OPTIONAL ACCESSORIES			
PRODUCT · COLOUR	PRODUCT WEIGHT	SHIPPING WEIGHT	SKU
wool felt pad · grey	0.8 lb	1.1 lb	M-PAD-FLT-GR-15
PaperStone® top · brown	1.3 lb	1.9 lb	M-TOP-P-FSC-BR-14
PaperStone® top · black	1.9 lb	2.4 lb	M-TOP-P-FSC-BK-14
PaperStone® top · grey	1.9 lb	2.4 lb	M-TOP-P-FSC-GR-14

\* small amount of length lost when bench is placed in curved configurations

This drawing and the content represented is the exclusive property of molo design ltd. and cannot be used without their prior written consent. For site installations verify all dimensions and notify molo of any on-site discrepancies prior to construction. Drawing scale may be affected by printing, scanning, or copying. Do not scale drawings.

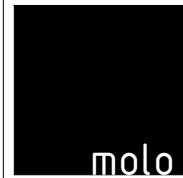

molo design, ltd.  
1470 Venables Street  
Vancouver, BC  
Canada V5L 2G7

+ 1 604 685 0340  
molodesign.com

Designed by Stephanie Forsythe and Todd MacAllen,  
manufactured by molo and protected by one or more patents and/or design registrations held by molo, viewable at molodesign.com/ip

softseating fanning stool, bench + table · 12" tall x 36" diameter · SPECIFICATIONS  
SCALE · 1:20

DATE: 260413

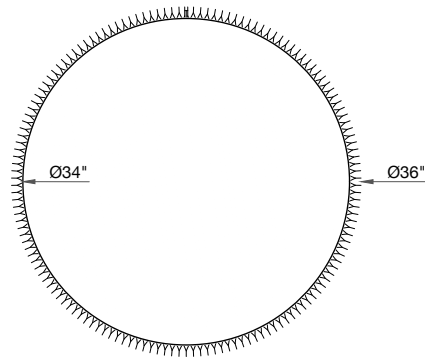

PLAN · PaperStone® TOP

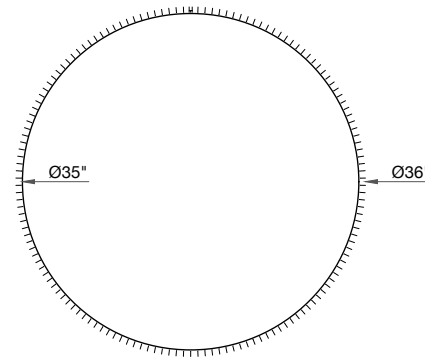

PLAN · WOOL FELT PAD

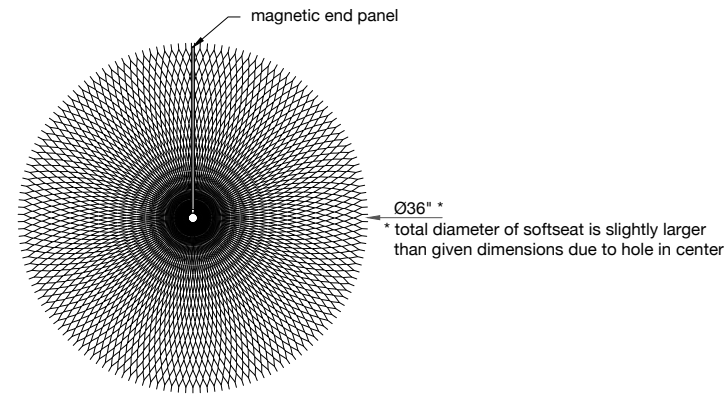

PLAN · softseating - fanning stool + table

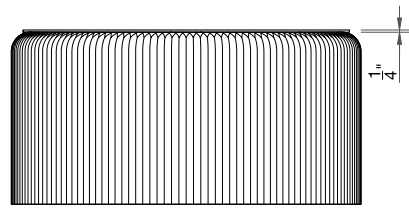

ELEVATION · PaperStone® TOP

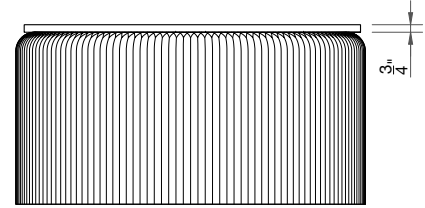

ELEVATION · WOOL FELT PAD

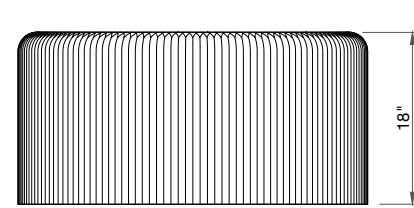

ELEVATION · softseating - fanning stool + table

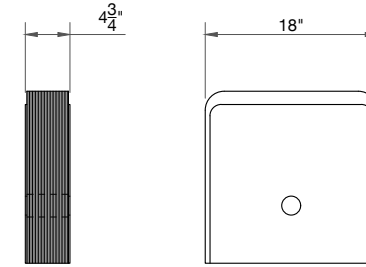

ELEVATION · COMPRESSED VIEWS

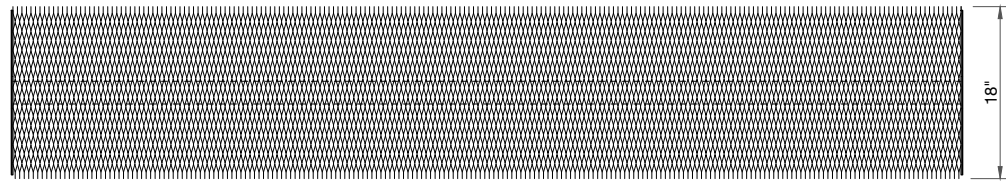

PLAN · softseating - bench

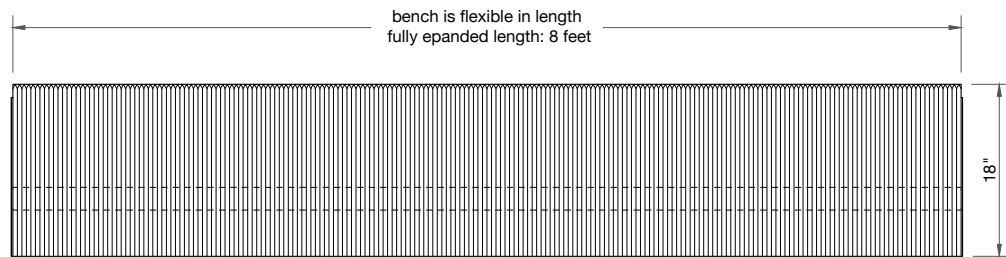

ELEVATION · softseating - bench

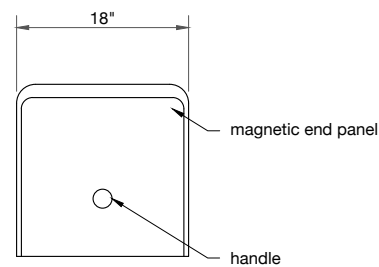

ELEVATION · COMPRESSED

softseating · 18" tall x 36" diameter · 8' bench *			
COLOUR · MATERIAL	PRODUCT WEIGHT	SHIPPING WEIGHT	SKU
brown · paper	31.5 lb	36.6 lb	M-SS-P-FSC-BR-18-36
black · paper	33.3 lb	38.3 lb	M-SS-P-BK-18-36
white · textile	26.0 lb	31.3 lb	M-SS-T-WH-18-36
aluminum · textile	26.6 lb	31.7 lb	M-SS-T-AL-18-36
forest green · textile	26.6 lb	31.7 lb	M-SS-T-GR-18-36

softseating fanning stool · OPTIONAL ACCESSORIES			
PRODUCT · COLOUR	PRODUCT WEIGHT	SHIPPING WEIGHT	SKU
wool felt pad · grey	5.0 lb	6.0 lb	M-PAD-FLT-GR-35
PaperStone® top · brown	9.4 lb	15.4 lb	M-TOP-P-FSC-BR-34
PaperStone® top · black	10.8 lb	15.4 lb	M-TOP-P-FSC-BK-34
PaperStone® top · grey	10.8 lb	15.4 lb	M-TOP-P-FSC-GR-34

softseating fanning bench · OPTIONAL ACCESSORIES			
PRODUCT · COLOUR	PRODUCT WEIGHT	SHIPPING WEIGHT	SKU
wool felt pad · grey	0.8 lb	1.1 lb	M-PAD-FLT-GR-15
PaperStone® top · brown	1.3 lb	1.9 lb	M-TOP-P-FSC-BR-14
PaperStone® top · black	1.9 lb	2.4 lb	M-TOP-P-FSC-BK-14
PaperStone® top · grey	1.9 lb	2.4 lb	M-TOP-P-FSC-GR-14

\* small amount of length lost when bench is placed in curved configurations

This drawing and the content represented is the exclusive property of molo design ltd. and cannot be used without their prior written consent. For site installations verify all dimensions and notify molo of any on-site discrepancies prior to construction. Drawing scale may be affected by printing, scanning, or copying. Do not scale drawings.

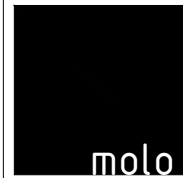

molo design, ltd.  
1470 Venables Street  
Vancouver, BC  
Canada V5L 2G7

+ 1 604 685 0340  
molodesign.com

Designed by Stephanie Forsythe and Todd MacAllen,  
manufactured by molo and protected by one or more patents and/or design registrations held by molo, viewable at molodesign.com/ip

softseating fanning stool, bench + table · 18" tall x 36" diameter · SPECIFICATIONS  
SCALE · 1:20

DATE: 260413

softseating · 16" tall x 60" diameter			
COLOUR · MATERIAL	PRODUCT WEIGHT	SHIPPING WEIGHT	SKU
black · paper	66.1 lb	92.5 lb	M-SS-P-BK-16-60-LNGR
white · textile	47.6 lb	74.0 lb	M-SS-T-WH-16-60-LNGR
aluminum · textile	49.6 lb	76.0 lb	M-SS-T-AL-16-60-LNGR

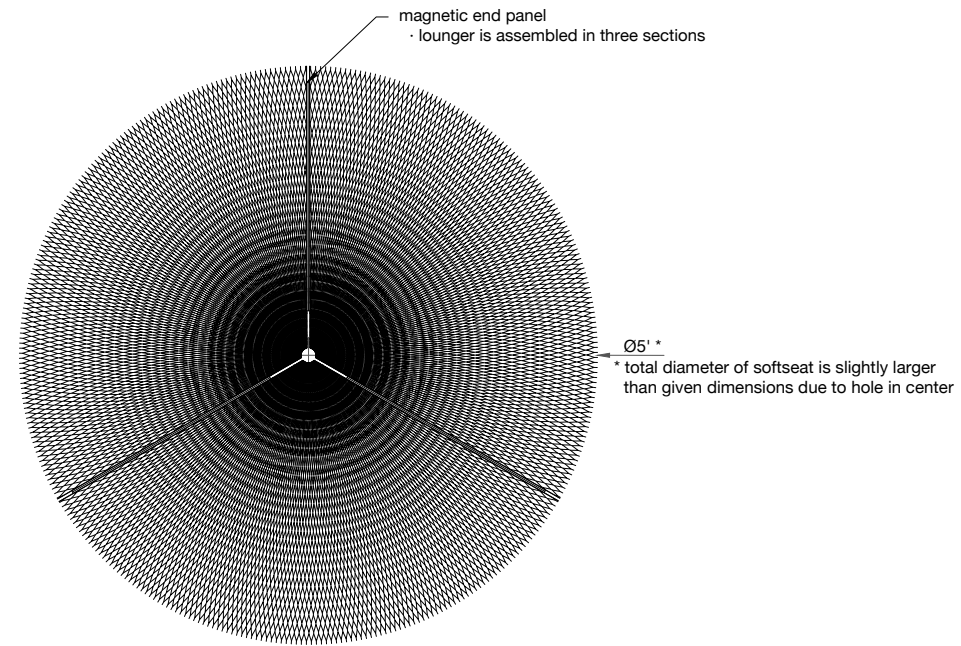

PLAN · softseating - lounger

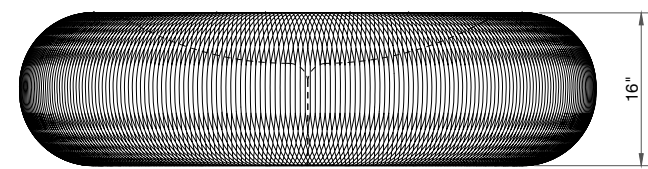

ELEVATION · softseating - lounger

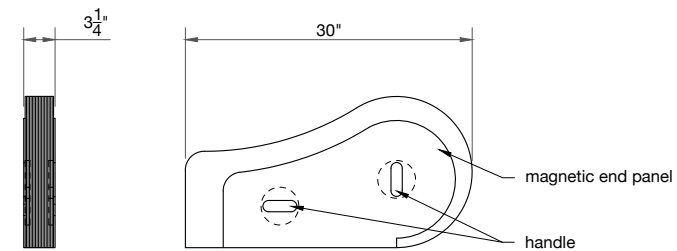

ELEVATION · COMPRESSED VIEWS - SINGLE SECTION

This drawing and the content represented is the exclusive property of molo design ltd. and cannot be used without their prior written consent. For site installations verify all dimensions and notify molo of any on-site discrepancies prior to construction. Drawing scale may be affected by printing, scanning, or copying. Do not scale drawings.

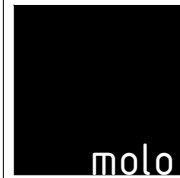

molo design, ltd.  
1470 Venables Street  
Vancouver, BC  
Canada V5L 2G7

+ 1 604 685 0340  
molodesign.com

Designed by Stephanie Forsythe and Todd MacAllen,  
manufactured by molo and protected by one or more patents and/or design registrations held by molo, viewable at molodesign.com/ip

softseating lounger · 16" tall x 60" diameter · SPECIFICATIONS  
SCALE · 1:20

DATE: 260413

softseating lounger · 16" tall x 84" diameter			
COLOUR · MATERIAL	PRODUCT WEIGHT	SHIPPING WEIGHT	SKU
brown · paper	152.1 lb	175.2 lb	M-SS-P-FSC-BR-16-84-LNGR

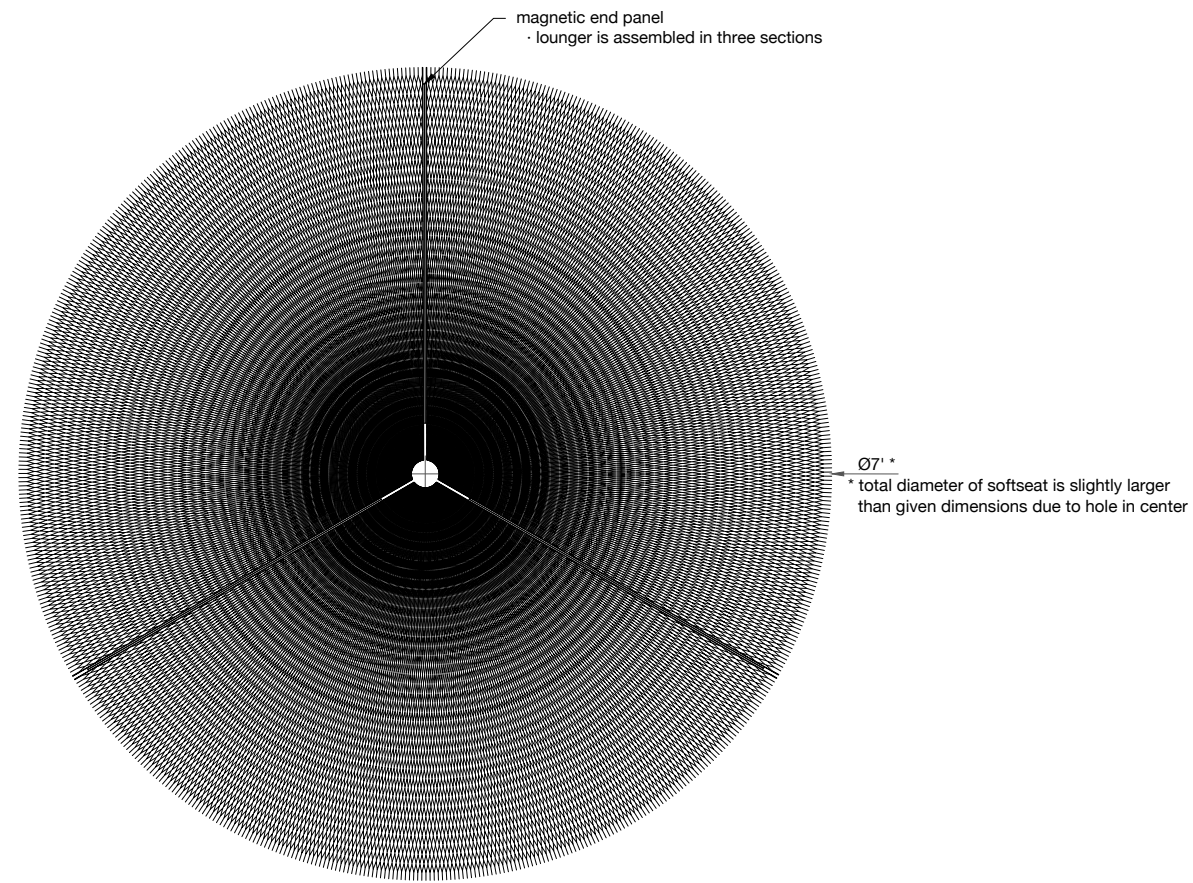

PLAN · softseating - lounger

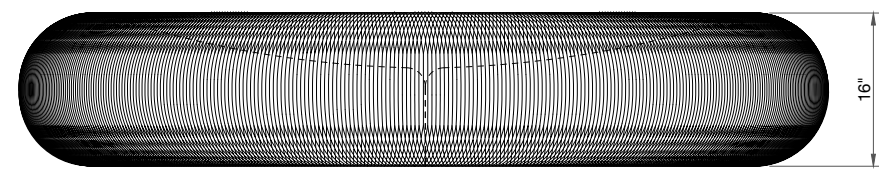

ELEVATION · softseating - lounger

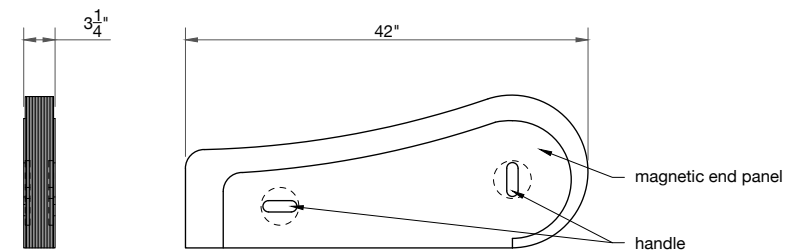

ELEVATION · COMPRESSED VIEWS - SINGLE SECTION

This drawing and the content represented is the exclusive property of molo design ltd. and cannot be used without their prior written consent. For site installations verify all dimensions and notify molo of any on-site discrepancies prior to construction. Drawing scale may be affected by printing, scanning, or copying. Do not scale drawings.



molo design, ltd.  
1470 Venables Street  
Vancouver, BC  
Canada V5L 2G7  
  
+ 1 604 685 0340  
molodesign.com

Designed by Stephanie Forsythe and Todd MacAllen,  
manufactured by molo and protected by one or more patents and/or design registrations held by molo, viewable at molodesign.com/ip

softseating lounger · 16" tall x 84" diameter · SPECIFICATIONS  
SCALE · 1:20

DATE: 260413