

This drawing and the content represented is the exclusive property of molo design ltd. and cannot be used without their prior written consent. For site installations verify all dimensions and notify molo of any on-site discrepancies prior to construction. Drawing scale may be affected by printing, scanning, or copying. Do not scale drawings

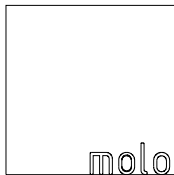

1470 Venables Street
Vancouver, BC
Canada V5L 2G7

+ 1 604 696 2501
www.molodesign.com

Designed by Stephanie Forsythe and Todd MacAllen, manufactured by molo and protected by one or more patents and/or design registrations held by molo, viewable at molodesign.com/ip

190430

cloud softlight specifications

small cloud pendant

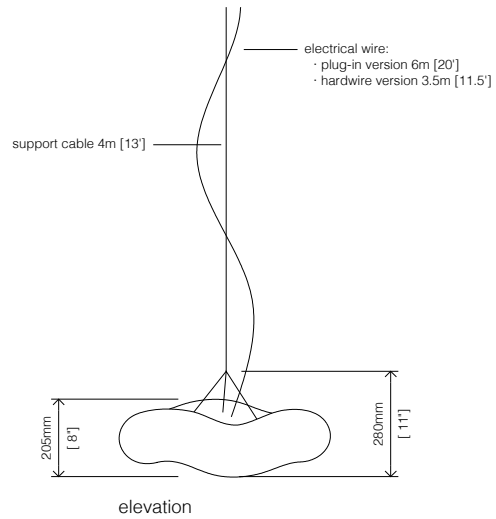

- 90+ CRI LED
 - 850 lumens avg. neutral white / 760 lumens avg. warm white
 - 10W power draw
 - 0.7kg (1.6lbs) hanging weight
 - up to 38m (125') electrical wire can be used without significant light loss
 - custom length electrical wire and support cable available upon request
 - choose between warm white 2700K or neutral white 4000K
 - choose between plug-in or hardwire installation type
- plug-in
- 110 - 240V input
 - 40W transformer: 102mm x 47mm x 38mm [4" x 1 7/8" x 1 1/2"]
 - type A, C, G and I AC plugs available
 - in-line dimmer included
- hardwire
- 110 - 240V + 277V input
 - 40W dimmable LED driver: 170mm x 60mm x 35mm [6 3/4" x 2 3/8" x 1 3/8"]
 - compatible with 0 - 10V dimming system
 - dimmer not included with hardwire type cloud softlight

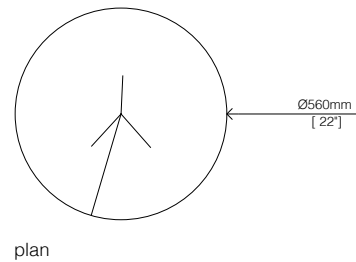

This drawing and the content represented is the exclusive property of molo design ltd. and cannot be used without their prior written consent. For site installations verify all dimensions and notify molo of any on-site discrepancies prior to construction. Drawing scale may be affected by printing, scanning, or copying. Do not scale drawings



1470 Venables Street
 Vancouver, BC
 Canada V5L 2G7
 + 1 604 685 0340
 molodesign.com

Designed by Stephanie Forsythe and Todd MacAllen, manufactured by molo and protected by one or more patents and/or design registrations held by molo, viewable at molodesign.com/ip

cloud softlight specifications

1:20
 190430

medium cloud pendant

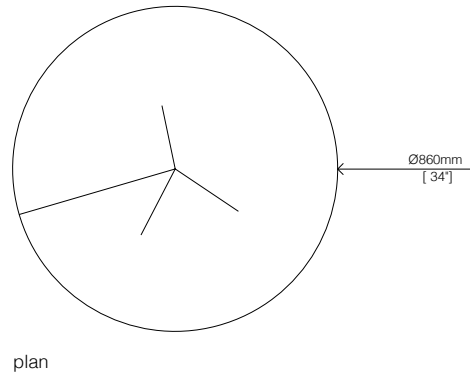
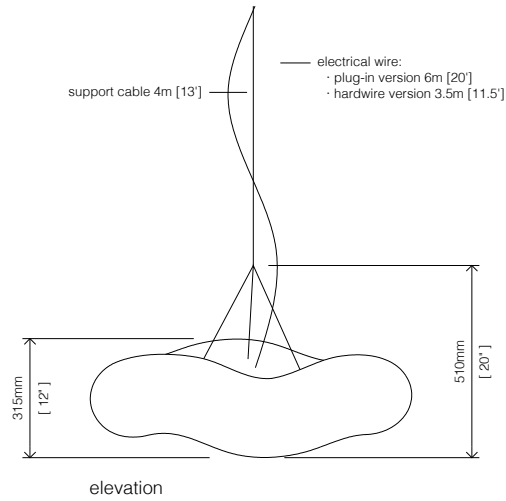

- 90+ CRI LED
 - 2590 lumens avg. neutral white / 2330 lumens avg. warm white
 - 30W power draw
 - 1.4kg (3.1lbs) hanging weight
 - up to 15.5m (50') electrical wire can be used without significant light loss
 - custom length electrical wire and support cable available upon request
 - choose between warm white 2700K or neutral white 4000K
 - choose between plug-in or hardwire installation type
- plug-in
- 110 - 240V input
 - 40W transformer: 102mm x 47mm x 38mm [4" x 1 7/8" x 1 1/2"]
 - type A, C, G and I AC plugs available
 - in-line dimmer included
- hardwire
- 110 - 240V + 277V input
 - 40W dimmable LED driver: 170mm x 60mm x 35mm [6 3/4" x 2 3/8" x 1 3/8"]
 - compatible with 0 - 10V dimming system
- dimmer not included with hardwire type cloud softlight



This drawing and the content represented is the exclusive property of molo design ltd. and cannot be used without their prior written consent. For site installations verify all dimensions and notify molo of any on-site discrepancies prior to construction. Drawing scale may be affected by printing, scanning, or copying. Do not scale drawings

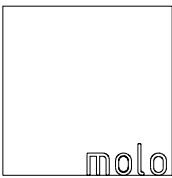

1470 Venables Street
 Vancouver, BC
 Canada V5L 2G7
 +1 604 685 0340
 molodesign.com

Designed by Stephanie Forsythe and Todd MacAllen, manufactured by molo and protected by one or more patents and/or design registrations held by molo, viewable at molodesign.com/ip

cloud softlight specifications

1:20
 190430

large cloud pendant

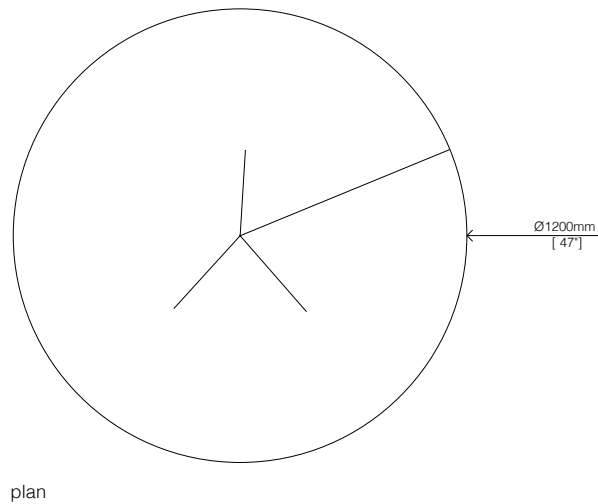
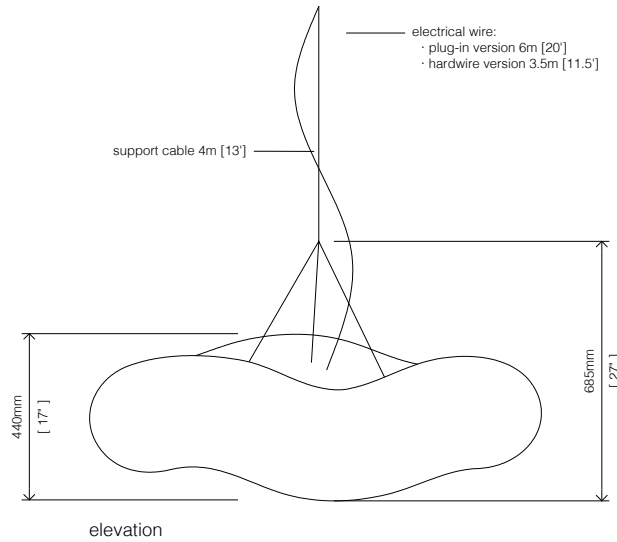

- 90+ CRI LED
- 3835 lumens avg. neutral white / 3450 lumens avg. warm white
- 44W power draw
- 2.3kg (5.0lbs) hanging weight
- up to 10.5m (35') electrical wire can be used without significant light loss
- custom length electrical wire and support cable available upon request

- choose between warm white 2700K or neutral white 4000K
- choose between plug-in or hardwire installation type

plug-in

- 110 - 240V input
- 60W transformer: 102mm x 47mm x 38mm [4" x 1 7/8" x 1 1/2"]
- type A, C, G and I AC plugs available
- in-line dimmer included

hardwire

- 10 - 240V + 277V input
- 60W dimmable LED driver: 195mm x 60mm x 40mm [7 3/4" x 2 3/8" x 1 9/16"]
- compatible with 0 - 10V dimming system

- dimmer not included with hardwire type cloud softlight



This drawing and the content represented is the exclusive property of molo design ltd. and cannot be used without their prior written consent. For site installations verify all dimensions and notify molo of any on-site discrepancies prior to construction. Drawing scale may be affected by printing, scanning, or copying. Do not scale drawings

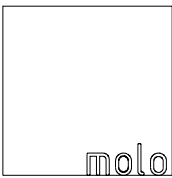

1470 Venables Street
 Vancouver, BC
 Canada V5L 2G7
 + 1 604 685 0340
 molodesign.com

Designed by Stephanie Forsythe and Todd MacAllen, manufactured by molo and protected by one or more patents and/or design registrations held by molo, viewable at molodesign.com/ip

cloud softlight specifications

1:20
 190430

x-large cloud pendant

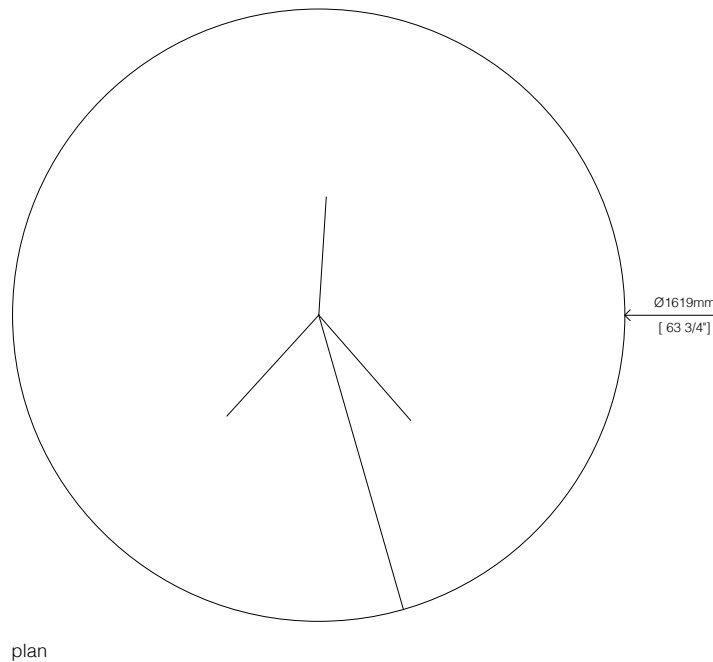
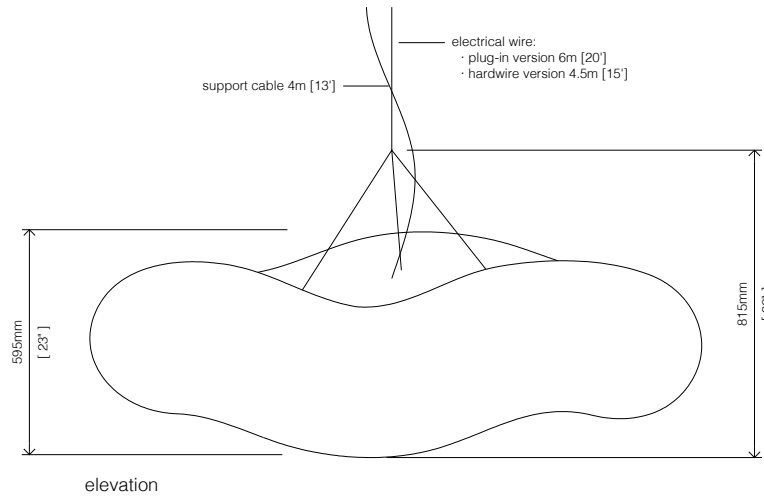

- 90+ CRI LED
- 4700 lumens avg. neutral white / 4230 lumens avg. warm white
- 54W power draw
- 4.6kg (10.1lbs) hanging weight
- up to 9m (30') electrical wire can be used without significant light loss
- custom length electrical wire and support cable available upon request

- choose between warm white 2700K or neutral white 4000K
- choose between plug-in or hardwire installation type

plug-in

- 110 - 240V input
- 60W transformer: 102mm x 47mm x 38mm [4" x 1 7/8" x 1 1/2"]
- type A, C, G and I AC plugs available
- in-line dimmer included

hardwire

- 110 - 240V + 277V input
- 60W dimmable LED driver: 195mm x 60mm x 40mm [7 3/4" x 2 3/8" x 1 9/16"]
- compatible with 0 - 10V dimming system

- dimmer not included with hardwire type cloud softlight



This drawing and the content represented is the exclusive property of molo design ltd. and cannot be used without their prior written consent. For site installations verify all dimensions and notify molo of any on-site discrepancies prior to construction. Drawing scale may be affected by printing, scanning, or copying. Do not scale drawings



1470 Venables Street
 Vancouver, BC
 Canada V5L 2G7
 + 1 604 685 0340
 molodesign.com

Designed by Stephanie Forsythe and Todd MacAllen, manufactured by molo and protected by one or more patents and/or design registrations held by molo, viewable at molodesign.com/ip

cloud softlight specifications

1:20
 190430

mounting kit for hardwire cloud pendant

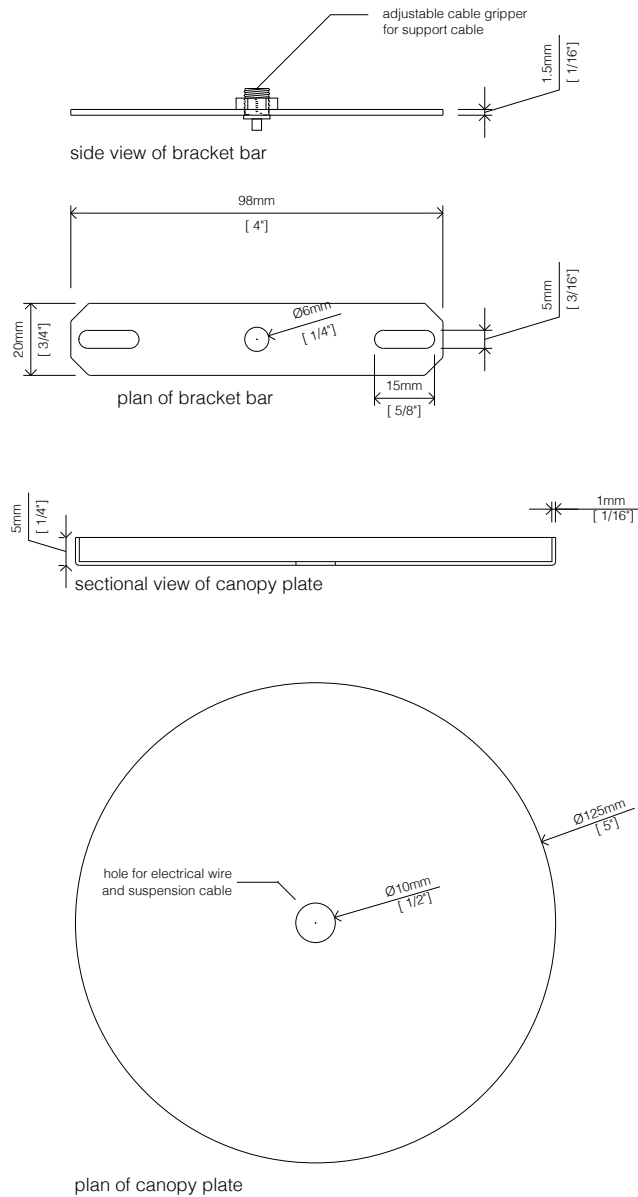

- mounting kit included with each hardwire type cloud softlight pendant
- bracket bar is to be used with the supplied cable gripper
- junction box is not supplied; installed junction box must support weight of the individual pendant
- an adjustable "ring type cable gripper" is also provided with each hardwire cloud pendant as an alternate mounting system; see drawing on page 7 for ring type cable gripper dimensions

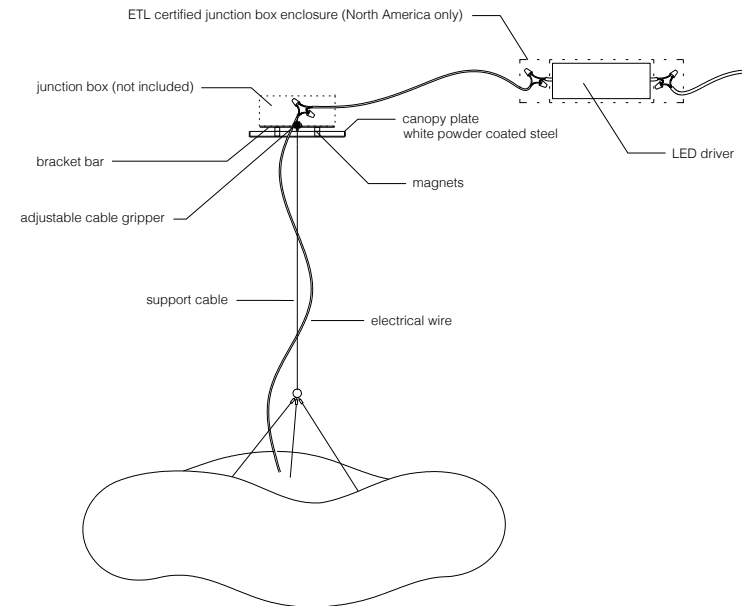

This drawing and the content represented is the exclusive property of molo design ltd. and cannot be used without their prior written consent. For site installations verify all dimensions and notify molo of any on-site discrepancies prior to construction. Drawing scale may be affected by printing, scanning, or copying. Do not scale drawings



1470 Venables Street
Vancouver, BC
Canada V5L 2G7
+ 1 604 685 0340
molodesign.com

Designed by Stephanie Forsythe and Todd MacAllen, manufactured by molo and protected by one or more patents and/or design registrations held by molo, viewable at molodesign.com/ip

cloud softlight specifications
1:2 accessories detail, 1:10 cloud mobile
190430

ring type mounting kit for plug-in cloud pendant

· adjustable ring type cable gripper (chrome steel) mounting kit included with each cloud softlight mobile, plug-in type.

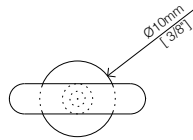

plan view of adjustable ring type cable gripper

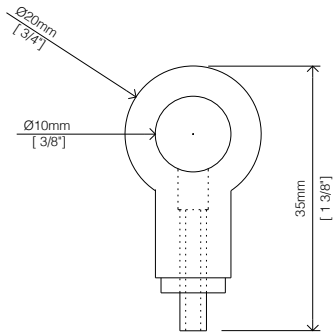

side view of adjustable ring type cable gripper

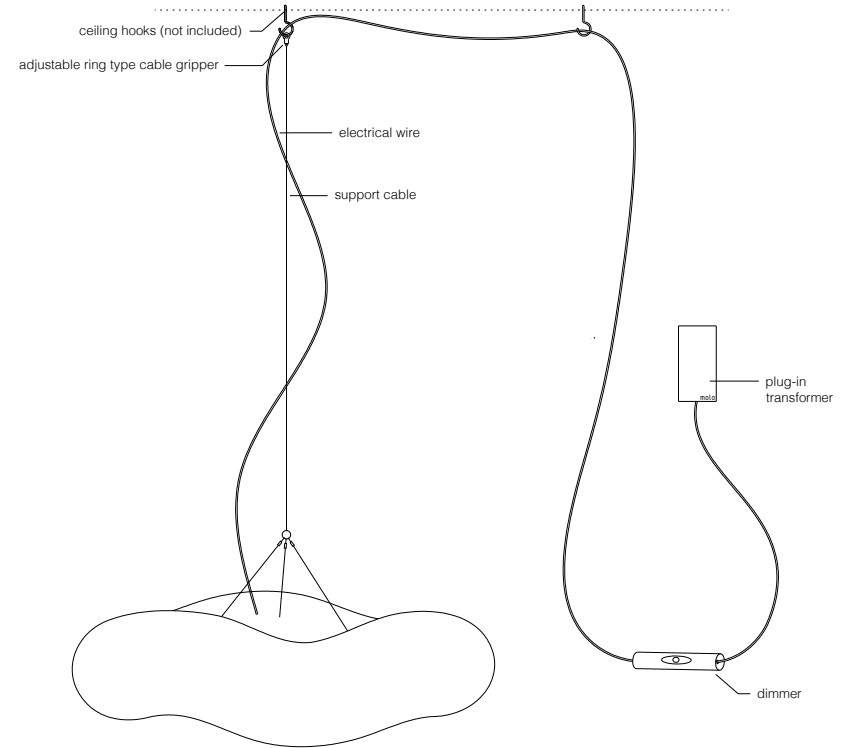

This drawing and the content represented is the exclusive property of molo design ltd. and cannot be used without their prior written consent. For site installations verify all dimensions and notify molo of any on-site discrepancies prior to construction. Drawing scale may be affected by printing, scanning, or copying. Do not scale drawings

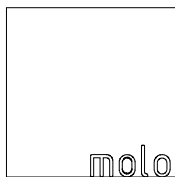

1470 Venables Street
Vancouver, BC
Canada V5L 2G7

+ 1 604 685 0340
molodesign.com

Designed by Stephanie Forsythe and Todd MacAllen, manufactured by molo and protected by one or more patents and/or design registrations held by molo, viewable at molodesign.com/ip

cloud softlight specifications
1:1 accessories detail, 1:10 cloud mobile
190430

small cloud mobile

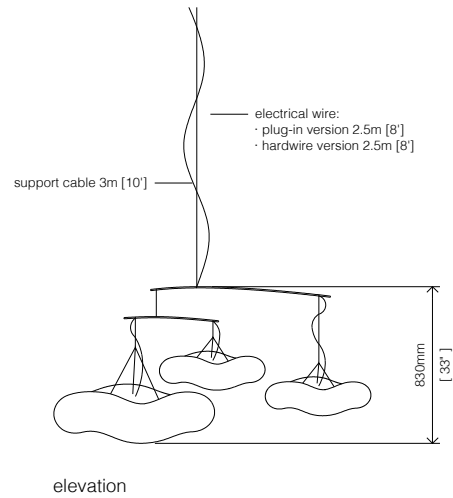

- 90+ CRI LED
- 4285 lumens avg. neutral white / 3855 lumens avg. warm white
- 49W power draw
- includes: 2 small pendants + 1 medium pendant
- 4.4kg (9.7lbs) hanging weight
- up to 15.5m (50') electrical wire can be used without significant light loss
- custom length electrical wire and support cable available upon request

- choose between warm white 2700K or neutral white 4000K
- choose between plug-in or hardwire installation type

plug-in

- 110 - 240V input
- 60W transformer: 102mm x 47mm x 38mm [4" x 1 7/8" x 1 1/2"]
- type A, C, G and I AC plugs available
- dimmer not included. If sourcing a dimmer, a 12V in-line dimmer rated for 4 Amps or higher is suitable for a small cloud mobile.

hardwire

- 110 - 240V + 277V input
- 60W dimmable LED driver: 195mm x 60mm x 40mm [7 3/4" x 2 3/8" x 1 9/16"]
- compatible with 0 - 10V dimming system
- dimmer not included with hardwire type cloud softlight

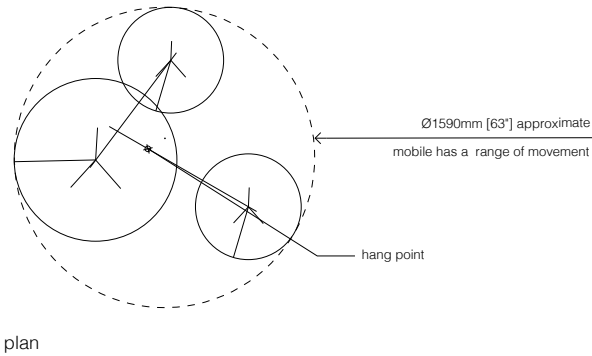

This drawing and the content represented is the exclusive property of molo design ltd. and cannot be used without their prior written consent. For site installations verify all dimensions and notify molo of any on-site discrepancies prior to construction. Drawing scale may be affected by printing, scanning, or copying. Do not scale drawings



1470 Venables Street
 Vancouver, BC
 Canada V5L 2G7
 +1 604 685 0340
 molodesign.com

Designed by Stephanie Forsythe and Todd MacAllen, manufactured by molo and protected by one or more patents and/or design registrations held by molo, viewable at molodesign.com/ip

cloud softlight specifications

1:40
 190430

medium cloud mobile

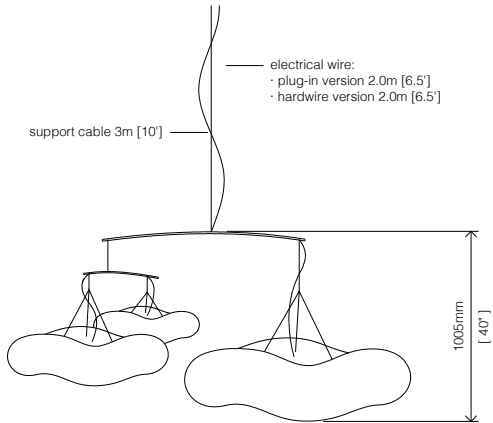

elevation

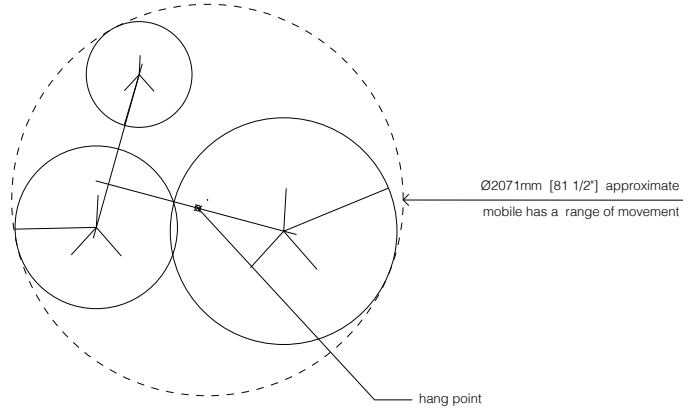

plan

- 90+ CRI LED
- 7270 lumens avg. neutral / 6545 lumens avg. warm white
- 83W power draw
- includes: 1 small pendant + 1 medium pendant + 1 large pendant
- 6.2kg (13.7lbs) hanging weight
- up to 10.5m (35') electrical wire can be used without significant light loss
- custom length electrical wire and support cable available upon request
- choose between warm white 2700K or neutral white 4000K
- choose between plug-in or hardwire installation type
- plug-in
 - 110 - 240V input
 - 120W transformer 170mm x 70mm x 40mm [7" x 2 3/4" x 1 5/8"]
 - type B and E/F AC plugs available
 - dimmer not included. If sourcing a dimmer, a 12V in-line dimmer rated for 6 Amps or higher is suitable for a medium cloud mobile.
- hardwire · standard
 - 110 - 240V + 277V input
 - 120W dimmable LED driver: 200mm x 65mm x 40mm [7 7/8" x 2 1/2" x 1 5/8"]
 - compatible with 0 - 10V dimming system
- hardwire · ETL (North America only)
 - 110 - 240V + 277V input
 - 2x 60W dimmable LED driver: 195mm x 60mm x 40mm [7 3/4" x 2 3/8" x 1 9/16"]
 - compatible with 0 - 10V dimming system
 - dimmer not included with hardwire type cloud softlight



This drawing and the content represented is the exclusive property of molo design ltd. and cannot be used without their prior written consent. For site installations verify all dimensions and notify molo of any on-site discrepancies prior to construction. Drawing scale may be affected by printing, scanning, or copying. Do not scale drawings

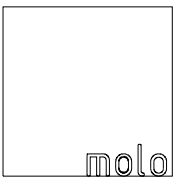

1470 Venables Street
Vancouver, BC
Canada V5L 2G7
+ 1 604 685 0340
molodesign.com

Designed by Stephanie Forsythe and Todd MacAllen, manufactured by molo and protected by one or more patents and/or design registrations held by molo, viewable at molodesign.com/ip

cloud softlight specifications

1:40
190430

large cloud mobile

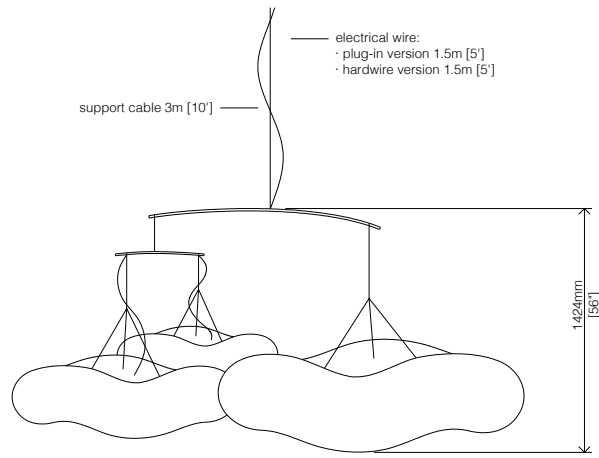

elevation

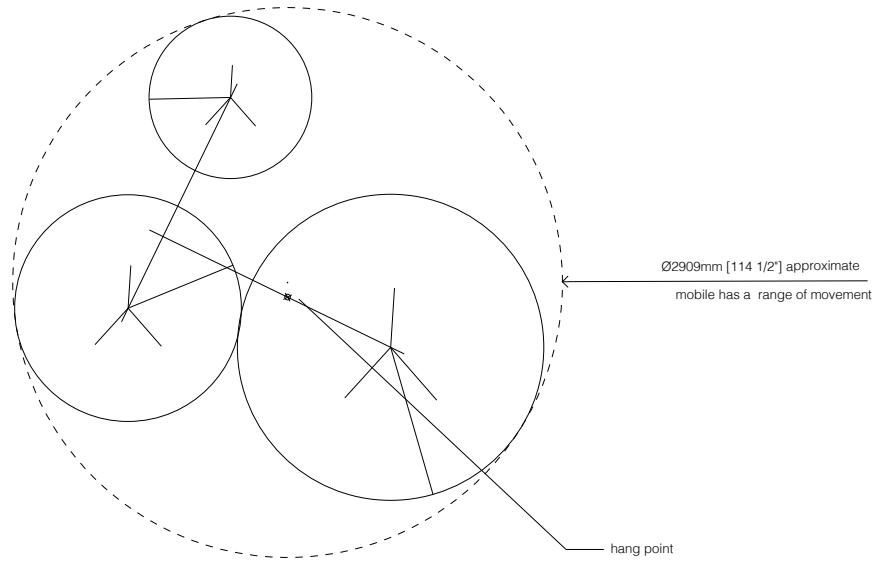

plan

- 90+ CRI LED
- 11,125 lumens avg. neutral white / 10,010 lumens avg. warm white
- 126W power draw
- includes: 1 medium pendant + 1 large pendant + 1 x-large pendant
- 11.5kg (25.5lbs) hanging weight
- up to 9m (30') electrical wire can be used without significant light loss
- custom length electrical wire and support cable available upon request

- choose between warm white 2700K or neutral white 4000K
- choose between plug-in or hardwire installation type

plug-in

- 110 - 240V input
- 150W transformer 170mm x 70mm x 40mm [7" x 2 3/4" x 1 5/8"]
- type B and E/F AC plugs available
- dimmer not included. If sourcing a dimmer, a 12V in-line dimmer rated for 9 Amps or higher is suitable for a large cloud mobile

hardwire - standard

- 110 - 240V + 277V input
- 150W dimmable LED driver: 200mm x 65mm x 40mm [7 7/8" x 2 1/2" x 1 5/8"]
- compatible with 0 - 10V dimming system

hardwire - ETL (North America only)

- 110 - 240V + 277V input
- 3x 60W dimmable LED driver: 195mm x 60mm x 40mm [7 3/4" x 2 3/8" x 1 9/16"]
- compatible with 0 - 10V dimming system

- dimmer not included with hardwire type cloud softlight



This drawing and the content represented is the exclusive property of molo design ltd. and cannot be used without their prior written consent. For site installations verify all dimensions and notify molo of any on-site discrepancies prior to construction. Drawing scale may be affected by printing, scanning, or copying. Do not scale drawings

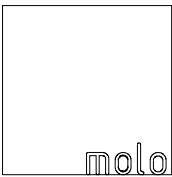

1470 Venables Street
Vancouver, BC
Canada V5L 2G7
+ 1 604 685 0340
molodesign.com

Designed by Stephanie Forsythe and Todd MacAllen, manufactured by molo and protected by one or more patents and/or design registrations held by molo, viewable at molodesign.com/ip

cloud softlight specifications

1:40
190430

mounting kit for hardwire cloud mobile

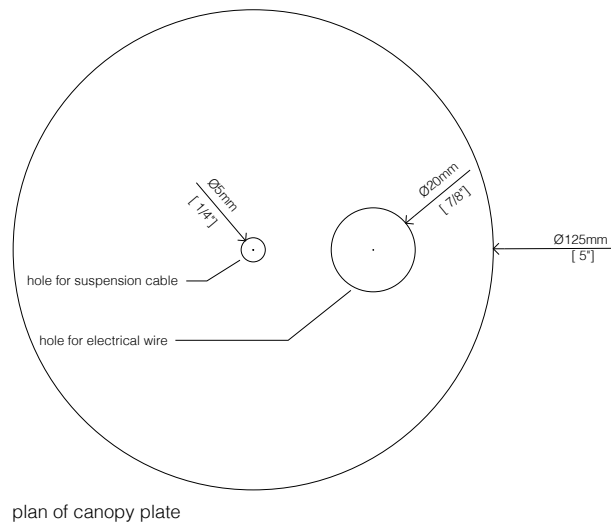
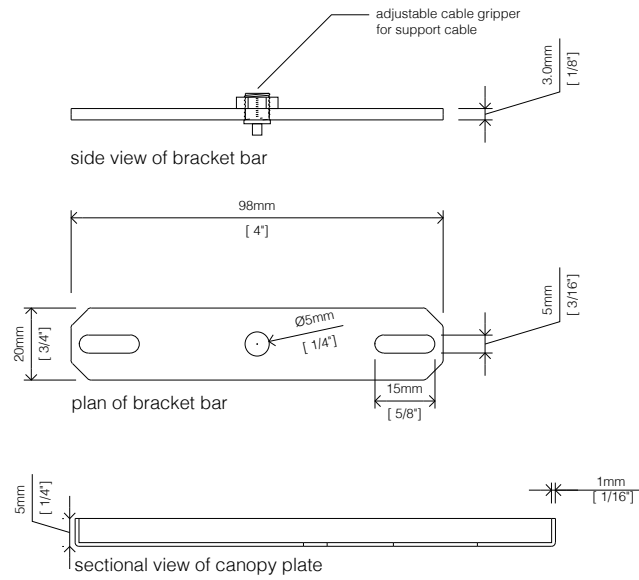

- mounting kit included with each cloud softlight mobile, hardwire type
- bracket bar is to be used with the supplied adjustable cable gripper
- junction box is not supplied; installed junction box must support weight of the individual mobile
- an adjustable "ring type cable gripper" is also provided with each hardwire cloud pendant as an alternate mounting system; see drawing on page 13 for ring type cable gripper dimensions

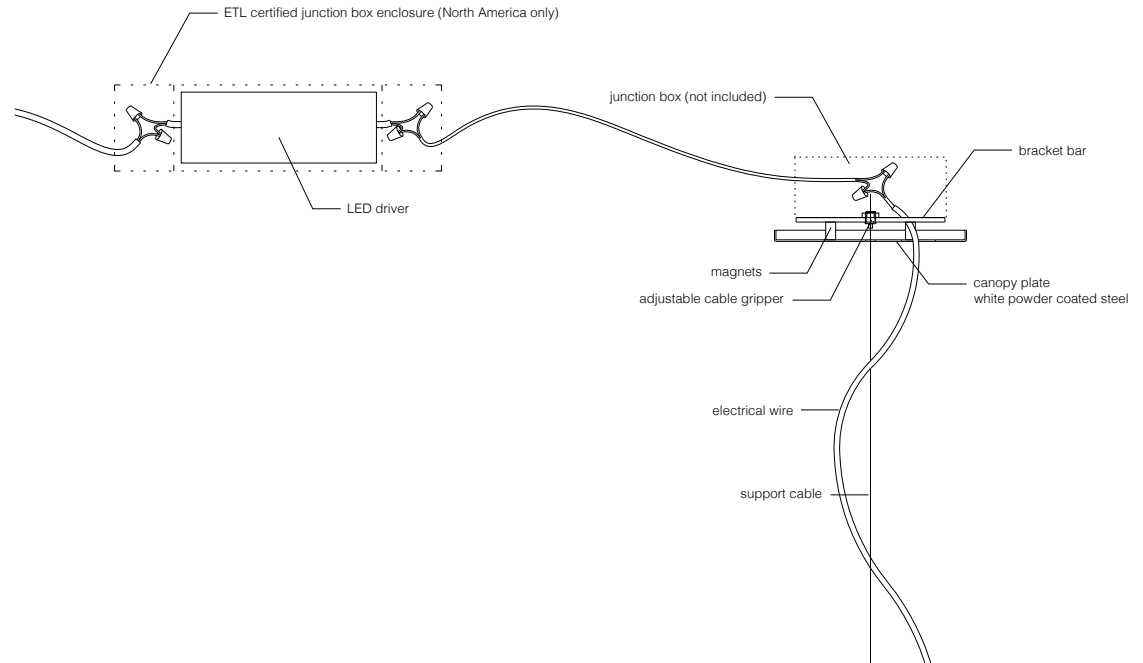

This drawing and the content represented is the exclusive property of molo design ltd. and cannot be used without their prior written consent. For site installations verify all dimensions and notify molo of any on-site discrepancies prior to construction. Drawing scale may be affected by printing, scanning, or copying. Do not scale drawings

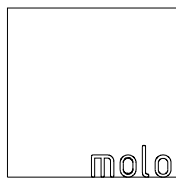

1470 Venables Street
Vancouver, BC
Canada V5L 2G7
+ 1 604 685 0340
molodesign.com

Designed by Stephanie Forsythe and Todd MacAllen, manufactured by molo and protected by one or more patents and/or design registrations held by molo, viewable at molodesign.com/ip

cloud softlight specifications

1:2 accessories detail, 1:5 cloud mobile electrical

190430

ring type mounting kit for plug-in cloud mobile

· adjustable ring type cable gripper (chrome steel) mounting kit included with each cloud softlight pendant, plug-in type.

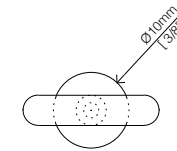
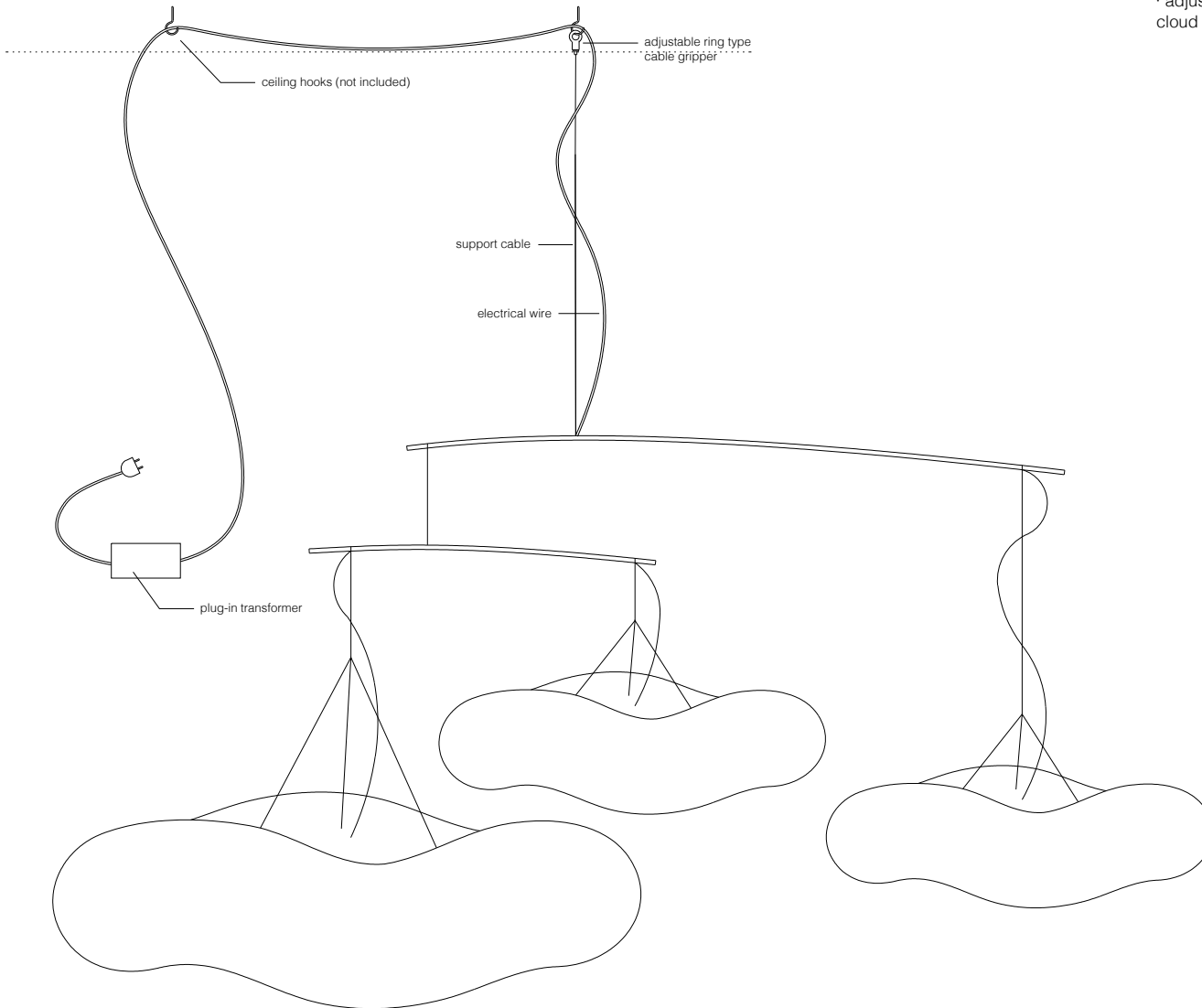

plan view of adjustable ring type cable gripper

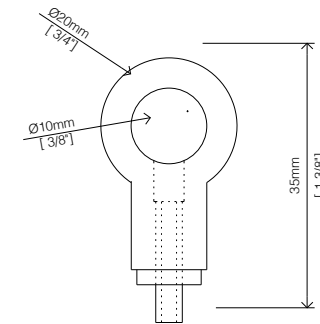

side view of adjustable ring type cable gripper

This drawing and the content represented is the exclusive property of molo design ltd. and cannot be used without their prior written consent. For site installations verify all dimensions and notify molo of any on-site discrepancies prior to construction. Drawing scale may be affected by printing, scanning, or copying. Do not scale drawings

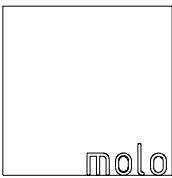

1470 Venables Street
Vancouver, BC
Canada V5L 2G7
+ 1 604 685 0340
molodesign.com

Designed by Stephanie Forsythe and Todd MacAllen, manufactured by molo and protected by one or more patents and/or design registrations held by molo, viewable at molodesign.com/ip

cloud softlight specifications
1:1 accessories detail, 1:10 cloud mobile
190430