

cloud softlight medium mobile · installation guide

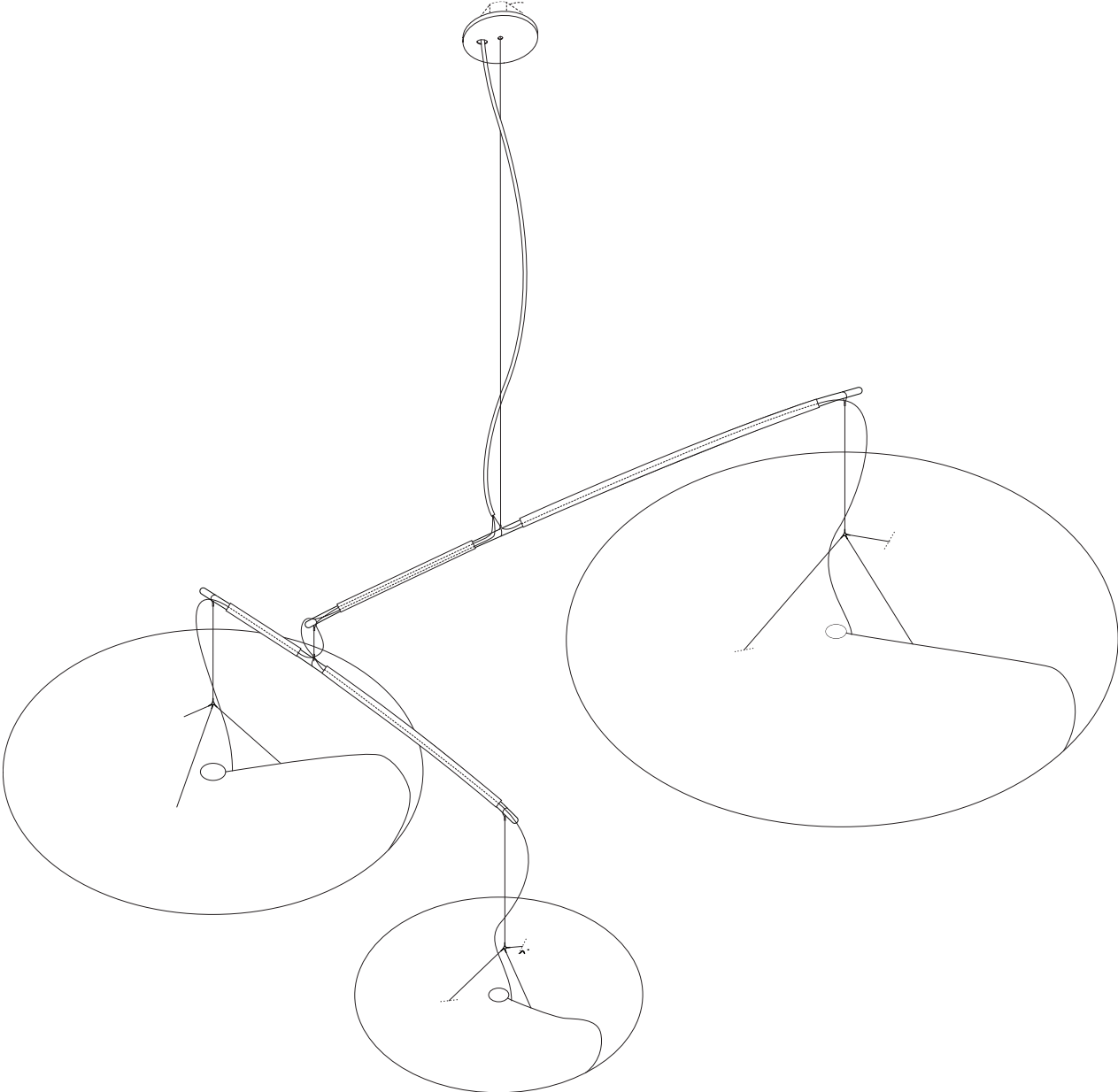

molo

medium cloud mobile anatomy

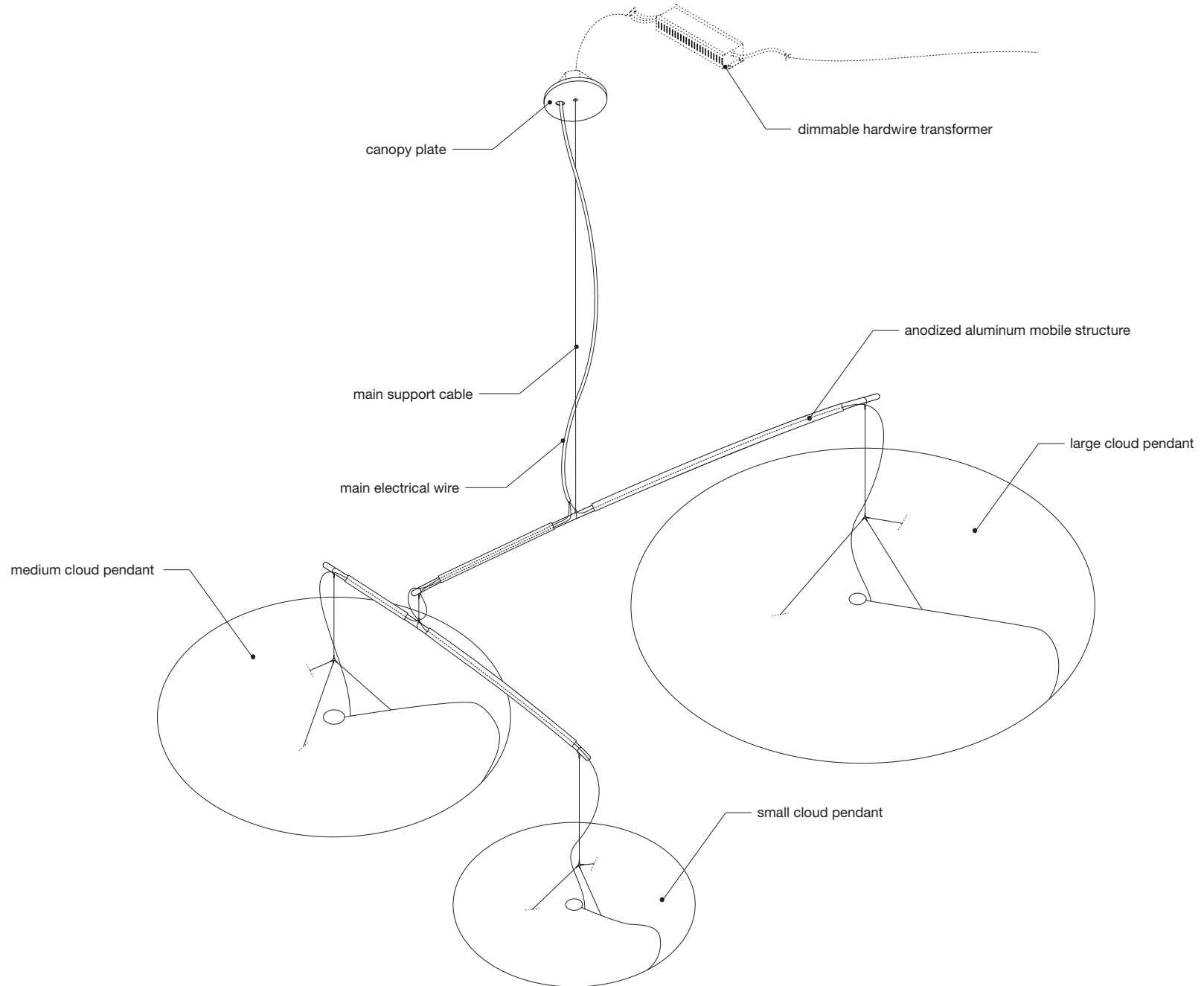

medium cloud mobile parts

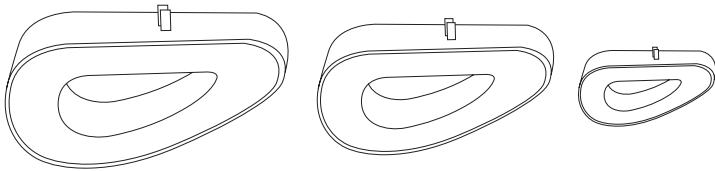
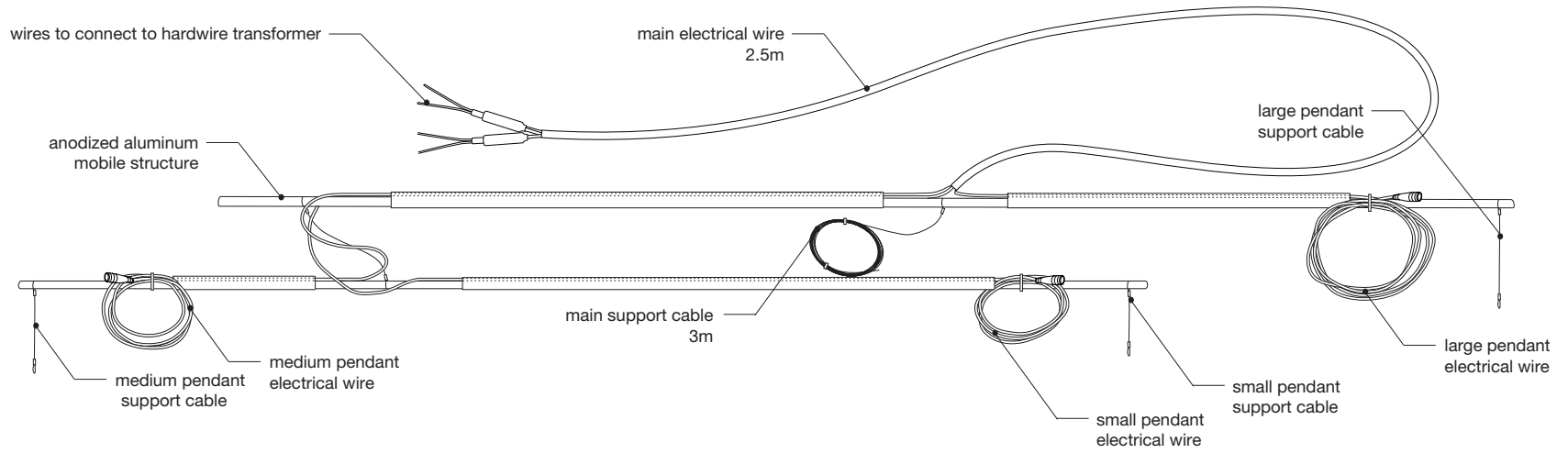

cloud shade
sm, md, lg
(compressed for shipping)

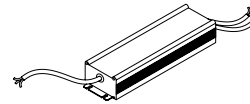

dimmable hardwire transformer



bracket bar with cable gripper

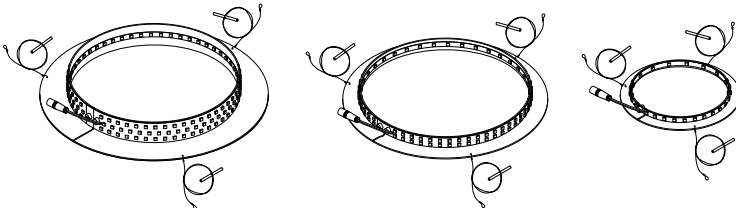

shade armatures + LEDs
sm, md, lg



split ring pliers



alternate "ring type" cable gripper (flexible option of hanging cloud pendants from wall hooks)

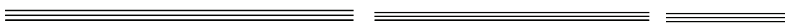

sets of 3 carbon rods
sm, md, lg



125mm (5") canopy plate

anatomy of cloud pendant within mobile

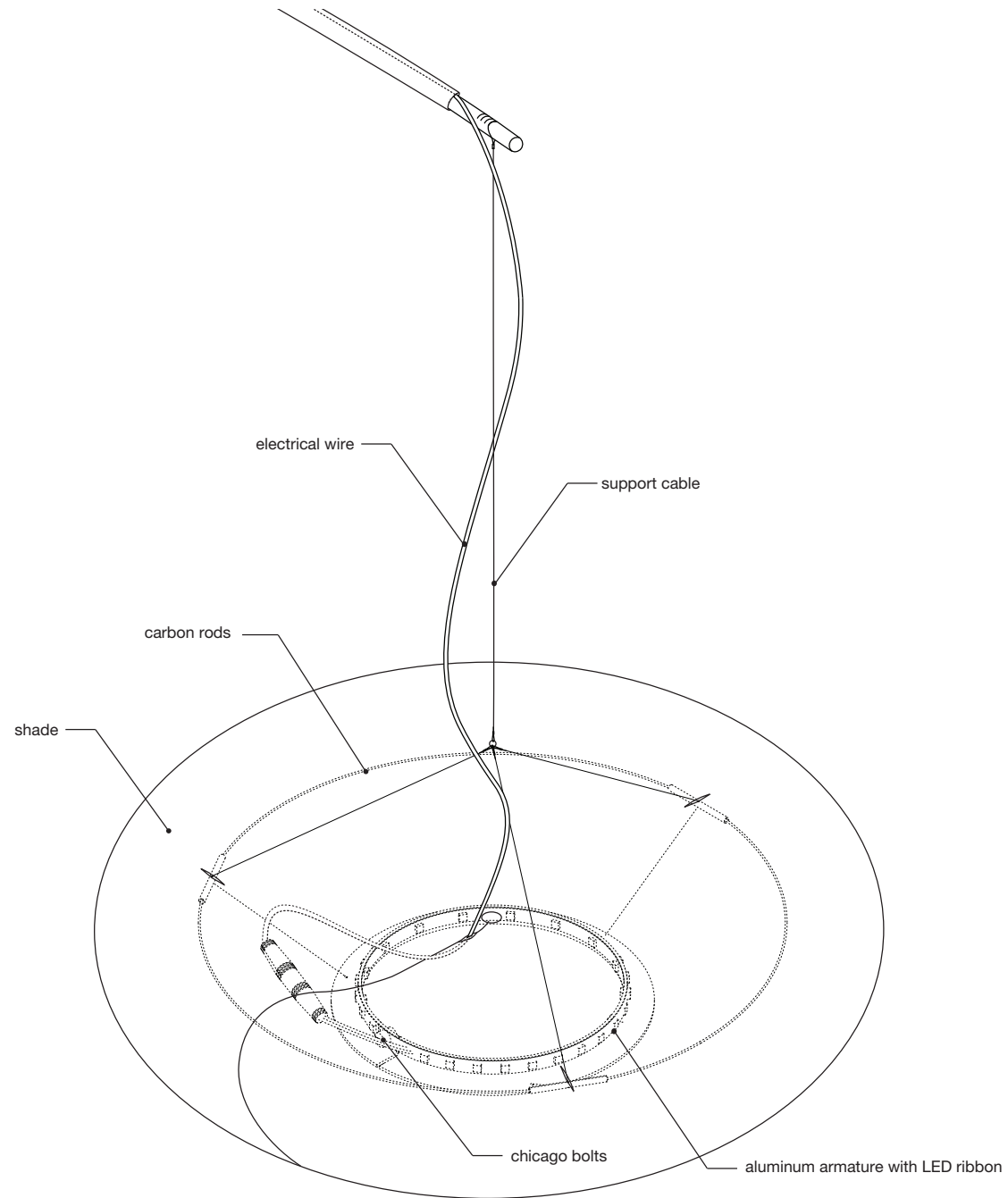

cloud pendant assembly

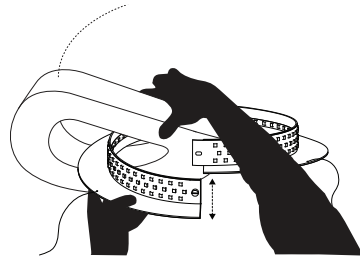

step 1

fasten with provided
chicago bolt

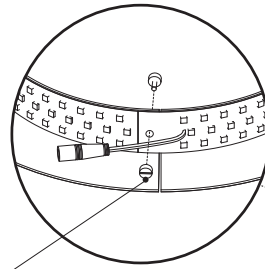

step 2

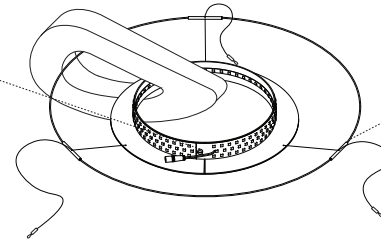

step 3

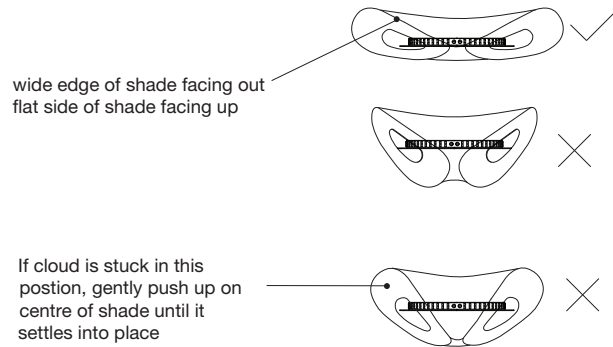

wide edge of shade facing out
flat side of shade facing up

If cloud is stuck in this
position, gently push up on
centre of shade until it
settles into place

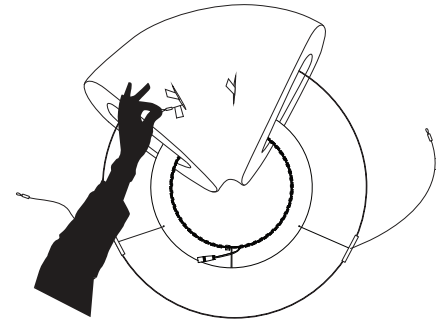

step 4

step 1: Undo the chicago bolt and split the angle ring LED armature by pulling the open ends of the ring apart vertically. Thread the armature through the cloud shade with the horizontal flange facing down. Make sure the flat side of the shade is facing up and the wider end of the shade is facing outwards.

IMPORTANT: If this step is not done correctly the cloud will look “droopy” when installed. The cloud should sit relatively flat and undulate gently when installed correctly.

step 2: Close armature ring and fasten through hole in LED ribbons and aluminium ring using provided chicago bolt.

step 3: Complete the outer ring of the armature by inserting the white painted carbon rods into the aluminum tube connectors (fixed to cables). The rods will flex to create a circle inside the cavity of the shade.

step 4: Feed two of the three support cables through the larger cells of the shade. Make sure the red tagged wire passes through the red tagged cell and the blue tagged wire passes through the blue tagged cell. **Remove tags.**

cloud pendant assembly

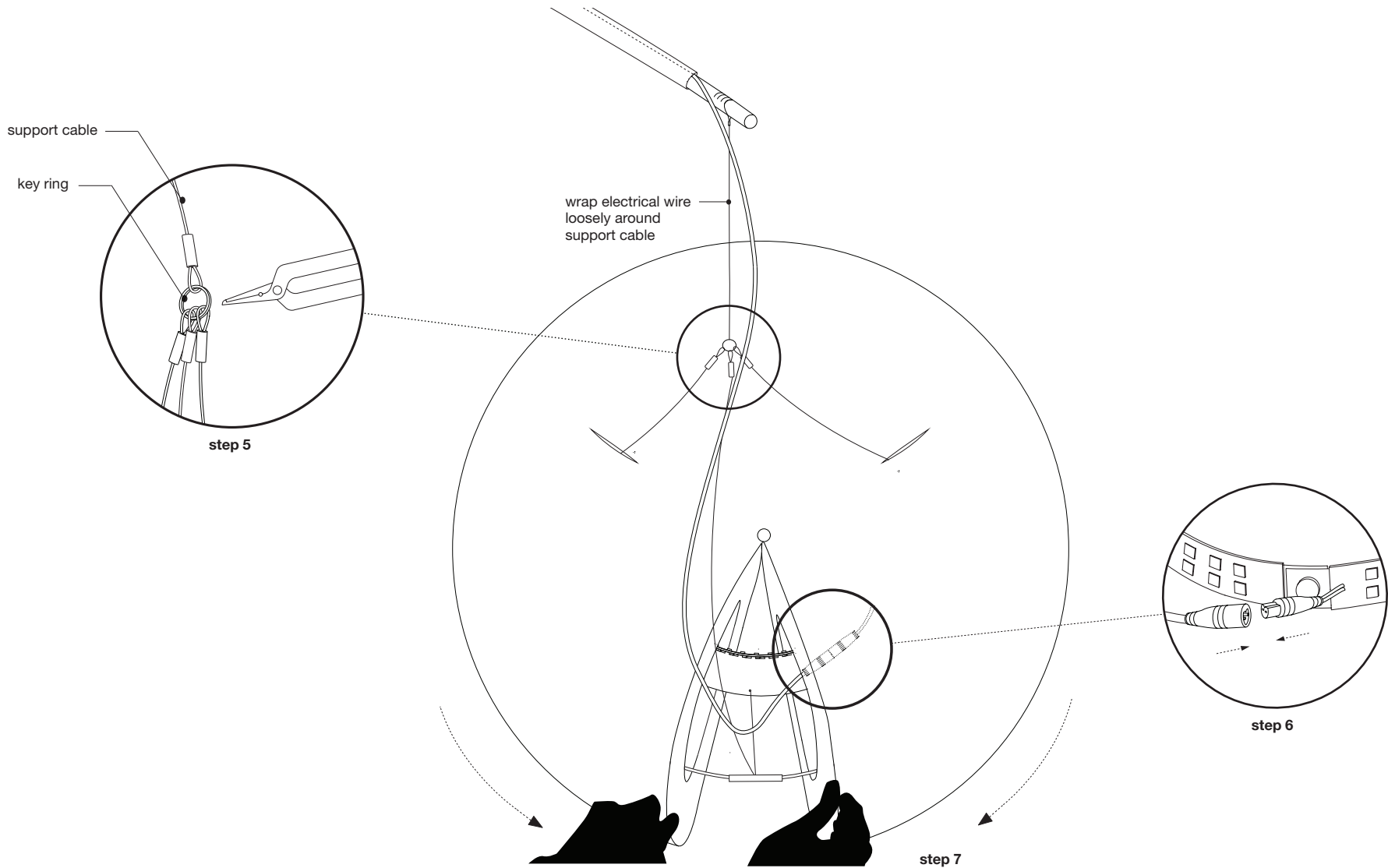

step 5: Use split ring pliers to open the key ring attached to main support cable and attach the three support cables from cloud pendant armature.

step 6: Connect electrical wire to LED ribbon inside shade (be sure to line up matching groove in male and female ends of clear connectors).

step 7: Close the shade around the armature by grabbing 20+ layers of the outer fins and pulling the magnetic end panels around the ring until they connect together. The third steel support cable and electrical wire should be sandwiched between the two closed magnetic end panels.

medium cloud mobile installation

step 8

bolt bracket bar with cable gripper and magnets to junction box

- junction box, supplied by customer, must be properly installed to support the weight of cloud softlight purchased

- medium mobile - 6.0kg (13.2lbs)

step 10

push up on cable gripper to allow support cable to pass through and set mobile to desired height

step 9

ensure support cable + electrical wire pass through holes in canopy plate prior to connecting support cable to cable gripper

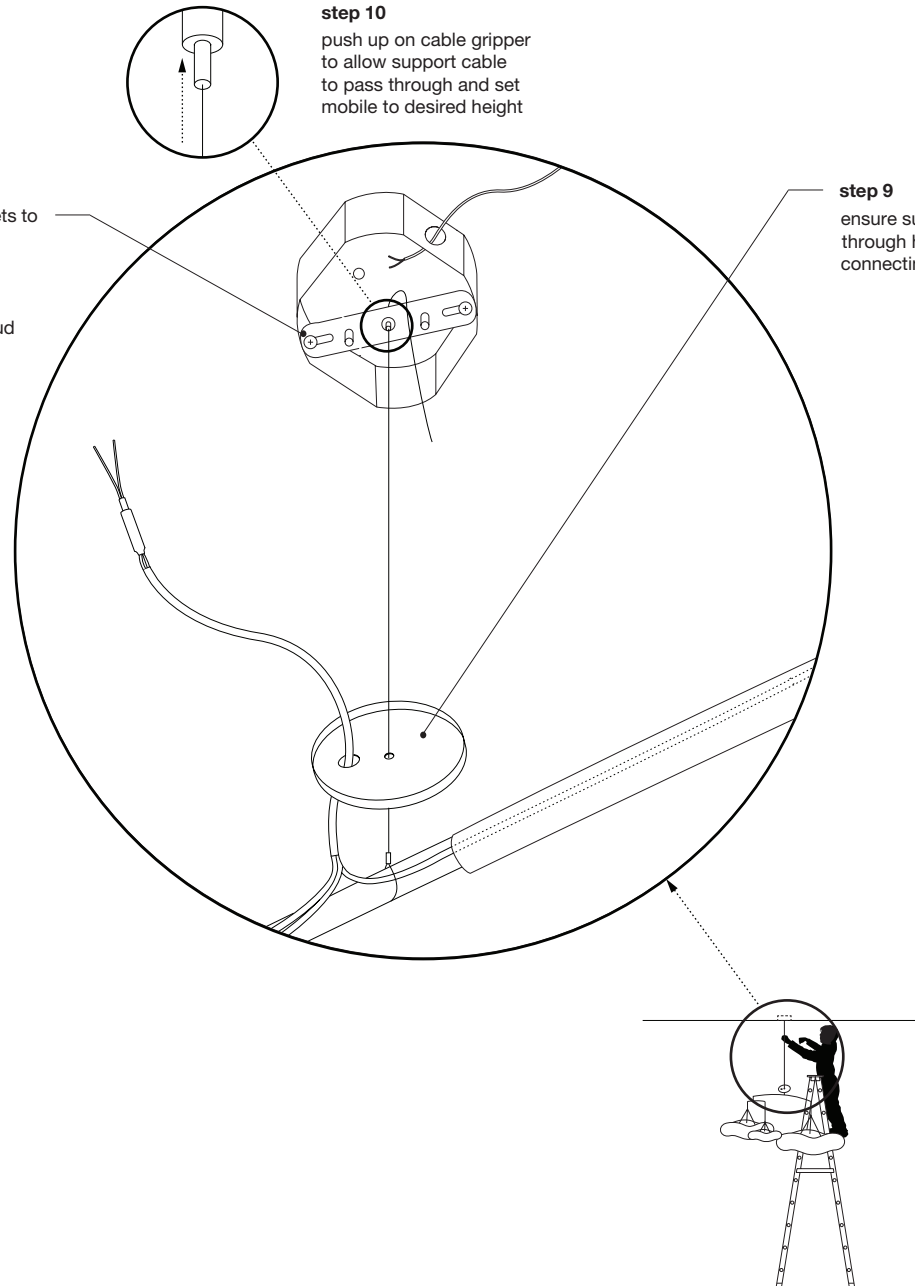

medium cloud mobile installation

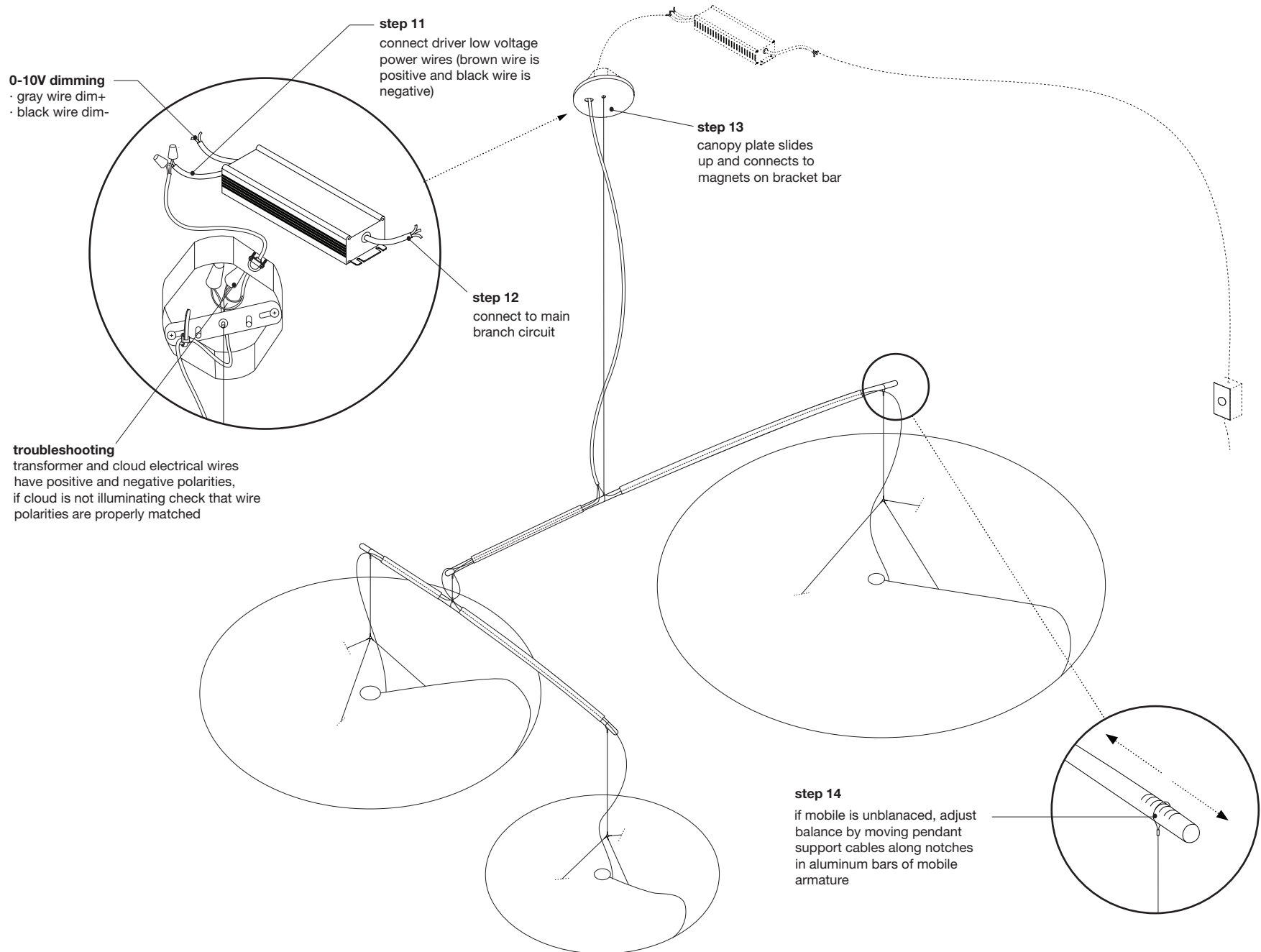

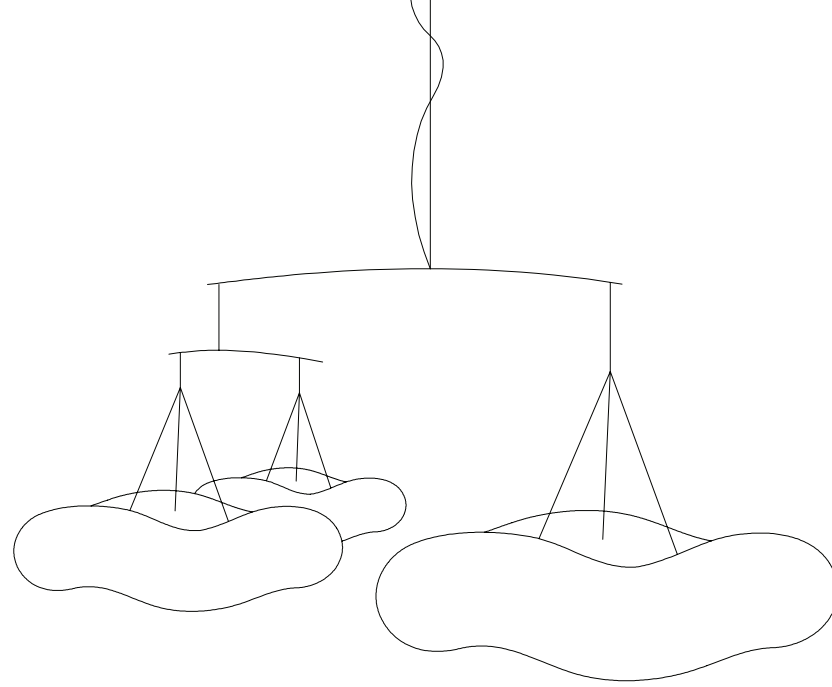

stiftung ear

ENERG Y IIA
E IIA
енергия · ενεργεια

A ⁺⁺	
A ⁺	◀ A ⁺
A	
B	
C	
D	
E	

82 kWh/1000h